

BARRE DENTATE PER CINGHIE POSITIVE SYNCHROBELT® - ISO 5294

TIMING BELTS BARS - ISO 5294

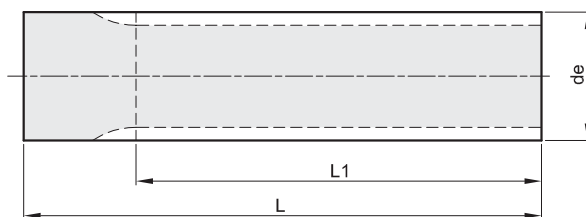

MXL PASSO 0,080" (2,032 mm)

MATERIALE: ALLUMINIO UNI 9006 - T6

codice	Z	de	L1	L	Kg.
MXL 12	12	7,25	50	75	0,01
MXL 14	14	8,55	50	75	0,01
MXL 15	15	9,19	50	75	0,01
MXL 16	16	9,84	50	75	0,02
MXL 18	18	11,13	50	75	0,02
MXL 20	20	12,43	90	120	0,04
MXL 22	22	13,72	125	140	0,05
MXL 24	24	15,02	125	140	0,06
MXL 25	25	15,66	125	140	0,07
MXL 26	26	16,31	125	140	0,08
MXL 28	28	17,60	125	140	0,09
MXL 30	30	18,90	125	140	0,10
MXL 32	32	20,19	125	140	0,12
MXL 34	34	21,48	125	140	0,13
MXL 36	36	22,78	140	140	0,15
MXL 38	38	24,07	140	140	0,17
MXL 40	40	25,36	140	140	0,19
MXL 42	42	26,66	140	140	0,20
MXL 44	44	27,95	140	140	0,23
MXL 45	45	28,60	140	140	0,24
MXL 48	48	30,54	140	140	0,27
MXL 50	50	31,83	140	140	0,30
MXL 60	60	38,30	160	160	0,49
MXL 70	70	44,77	160	160	0,67
MXL 72	72	46,06	160	160	0,72

XL PASSO 1/5" (5,08 mm)

MATERIALE: ALLUMINIO UNI 9006 - T6

codice	Z	de	L1	L	Kg.
XL 10	10	15,66	140	140	0,07
XL 11	11	17,28	140	140	0,08
XL 12	12	18,90	140	140	0,10
XL 13	13	20,51	140	140	0,11
XL 14	14	22,13	140	140	0,13
XL 15	15	23,75	140	140	0,16
XL 16	16	25,36	140	140	0,18
XL 17	17	26,98	140	140	0,20
XL 18	18	28,60	140	140	0,23
XL 19	19	30,22	140	140	0,26
XL 20	20	31,83	140	140	0,28
XL 21	21	33,45	160	160	0,36
XL 22	22	35,07	160	160	0,40
XL 23	23	36,60	160	160	0,44
XL 24	24	38,30	160	160	0,48
XL 25	25	39,92	160	160	0,51
XL 26	26	41,53	160	160	0,56
XL 27	27	43,15	160	160	0,60
XL 28	28	44,77	160	160	0,65
XL 29	29	46,39	160	160	0,70
XL 30	30	48,00	160	160	0,75
XL 32	32	51,24	160	160	0,87
XL 33	33	52,85	160	160	0,92
XL 34	34	54,47	160	160	0,98
XL 35	35	56,09	160	160	1,04
XL 36	36	57,70	160	160	1,10
XL 38	38	60,94	160	160	1,23
XL 39	39	62,56	160	160	1,30
XL 40	40	64,17	160	160	1,37
XL 41	41	65,79	160	160	1,43
XL 42	42	67,41	160	160	1,51
XL 43	43	69,02	160	160	1,58
XL 44	44	70,64	160	160	1,65
XL 48	48	77,11	160	160	1,98
XL 56	56	90,04	160	160	2,71
XL 60	60	96,51	160	160	3,10
XL 72	72	115,92	160	160	4,52

L PASSO 3/8" (9,525 mm)

MATERIALE: ALLUMINIO UNI 9006 - T6

codice	Z	de	L1	L	Kg.
L 10	10	29,56	140	140	0,23
L 11	11	32,59	140	140	0,28
L 12	12	35,62	160	160	0,39
L 13	13	38,65	160	160	0,46
L 14	14	41,68	160	160	0,55
L 15	15	44,72	160	160	0,63
L 16	16	47,75	160	160	0,73
L 17	17	50,78	160	160	0,82
L 18	18	53,81	160	160	0,93
L 19	19	56,84	160	160	1,04
L 20	20	59,88	160	160	1,16
L 21	21	62,91	160	160	1,28
L 22	22	65,94	160	160	1,41
L 23	23	68,97	160	160	1,55
L 24	24	72,00	160	160	1,69
L 27	27	81,10	160	160	2,15
L 30	30	90,20	160	160	2,67

L PASSO 3/8" (9,525 mm)

MATERIALE: ACCIAIO

codice	Z	de	L1	L	Kg.
L 10	10	29,56	140	140	0,66
L 11	11	32,59	140	140	0,81
L 12	12	35,62	160	160	1,12
L 13	13	38,65	160	160	1,32
L 14	14	41,68	160	160	1,57
L 15	15	44,72	160	160	1,81
L 16	16	47,75	160	160	2,08
L 17	17	50,78	160	160	2,34
L 18	18	53,81	160	160	2,64
L 19	19	56,84	160	160	2,96
L 20	20	59,88	160	160	3,32
L 21	21	62,91	160	160	3,67
L 22	22	65,94	160	160	4,07
L 23	23	68,97	160	160	4,44
L 24	24	72,00	160	160	4,86
L 27	27	81,10	160	160	6,20
L 30	30	90,20	160	160	7,72

Mondial Tecnica Srl
Via Arenaccia 52 - 80141 Napoli
Tel. 081.5542121 Fax. 081.281937
info@mondialtecnicaizzo.com
www.mondialtecnicaizzo.com

BARRE DENTATE PER CINGHIE SYNCHROBELT® - "HTD" TIMING BELTS BARS "HTD"

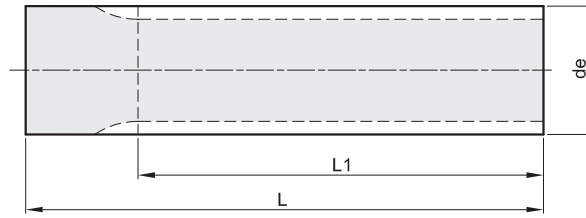

HTD 5M PASSO 5 mm MATERIALE: ALLUMINIO UNI 9006 - T6

codice	Z	de	L1	L	Kg.
5M 12	12	17,96	160	160	0,08
5M 13	13	19,55	160	160	0,10
5M 14	14	21,14	175	200	0,16
5M 15	15	22,73	175	200	0,19
5M 16	16	24,32	175	200	0,21
5M 17	17	25,92	175	200	0,24
5M 18	18	27,51	200	200	0,27
5M 19	19	29,10	200	200	0,31
5M 20	20	30,69	200	200	0,35
5M 21	21	32,28	200	200	0,39
5M 22	22	33,87	200	200	0,43
5M 23	23	35,47	200	200	0,48
5M 24	24	37,06	200	200	0,52
5M 25	25	38,65	200	200	0,57
5M 26	26	40,24	200	200	0,62
5M 27	27	41,83	200	200	0,67
5M 28	28	43,42	200	200	0,73
5M 30	30	46,61	200	200	0,84
5M 32	32	49,79	200	200	0,97
5M 34	34	52,97	200	200	1,11
5M 36	36	56,16	200	200	1,25
5M 38	38	59,34	200	200	1,40
5M 40	40	62,52	200	200	1,55
5M 42	42	65,71	200	200	1,73
5M 44	44	68,89	200	200	1,90
5M 45	45	70,48	200	200	1,99
5M 48	48	75,25	200	200	2,27
5M 50	50	78,44	200	200	2,48
5M 60	60	94,35	200	200	3,60
5M 72	72	113,45	200	200	5,28

HTD 8M PASSO 8 mm MATERIALE: ACCIAIO

codice	Z	de	L1	L	Kg.
8M 18	18	44,47	200	200	2,03
8M 19	19	47,01	200	200	2,30
8M 20	20	49,56	200	200	2,57
8M 21	21	52,11	200	200	2,88
8M 22	22	54,65	200	200	3,18
8M 23	23	57,20	200	200	3,52
8M 24	24	59,75	200	200	3,86
8M 25	25	62,29	200	200	4,23
8M 26	26	64,84	200	200	4,60
8M 28	28	69,93	200	200	5,40
8M 30	30	75,02	200	200	6,27
8M 32	32	80,12	200	200	7,20
8M 34	34	85,21	200	200	8,20
8M 35	35	87,76	200	200	8,71
8M 36	36	90,30	200	200	9,26
8M 38	38	95,40	200	200	10,39
8M 40	40	100,49	200	200	11,58
8M 44	44	110,68	200	200	14,16
8M 48	48	120,86	200	200	16,99

Mondial Tecnica Srl
Via Arenaccia 52 - 80141 Napoli
Tel. 081.5542121 Fax. 081.281937
info@mondialtecnicaizzo.com
www.mondialtecnicaizzo.com

BARRE DENTATE PASSO METRICO SERIE "T" - DIN 7721-2

METRIC BARS "T" - DIN 7721-2

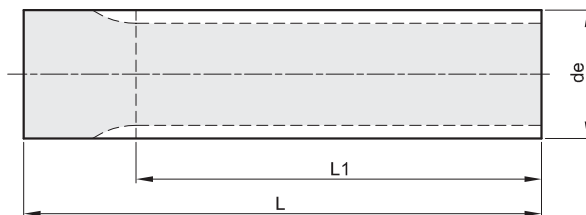

T 2,5 PASSO 2,5 mm

MATERIALE: ALLUMINIO UNI 9006 - T6

codice	Z	de	L1	L	Kg.
T 2,5 10	10	7,42	50	75	0,01
T 2,5 12	12	9,00	50	75	0,01
T 2,5 13	13	9,80	50	75	0,02
T 2,5 14	14	10,60	50	75	0,02
T 2,5 15	15	11,40	75	75	0,02
T 2,5 16	16	12,20	75	75	0,02
T 2,5 17	17	13,00	75	75	0,03
T 2,5 18	18	13,80	75	75	0,03
T 2,5 19	19	14,60	120	120	0,05
T 2,5 20	20	15,40	120	120	0,05
T 2,5 21	21	16,20	120	120	0,06
T 2,5 22	22	17,00	140	140	0,08
T 2,5 24	24	18,55	140	140	0,09
T 2,5 26	26	20,15	140	140	0,12
T 2,5 27	27	20,95	140	140	0,13
T 2,5 28	28	21,75	140	140	0,14
T 2,5 29	29	22,55	140	140	0,15
T 2,5 30	30	23,35	140	140	0,15
T 2,5 32	32	24,95	140	140	0,18
T 2,5 34	34	26,55	140	140	0,21
T 2,5 35	35	27,35	140	140	0,21
T 2,5 36	36	28,10	140	140	0,22
T 2,5 38	38	29,70	140	140	0,26
T 2,5 40	40	31,30	140	140	0,27
T 2,5 42	42	32,90	140	140	0,32
T 2,5 44	44	34,50	140	140	0,33
T 2,5 45	45	35,30	140	140	0,37
T 2,5 48	48	37,70	140	140	0,40
T 2,5 50	50	39,29	160	160	0,52
T 2,5 60	60	47,25	160	160	0,72
T 2,5 65	65	51,20	160	160	0,87
T 2,5 70	70	55,20	160	160	1,05
T 2,5 72	72	56,80	160	160	1,11
T 2,5 90	90	71,12	160	160	1,75
T 2,5 100	100	79,08	160	160	2,18

T 5 PASSO 5 mm

MATERIALE: ALLUMINIO UNI 9006 - T6

codice	Z	de	L1	L	Kg.
T 5 10	10	15,05	140	140	0,06
T 5 11	11	16,65	140	140	0,07
T 5 12	12	18,25	140	140	0,09
T 5 13	13	19,85	140	140	0,10
T 5 14	14	21,45	140	140	0,12
T 5 15	15	23,05	140	140	0,14
T 5 16	16	24,60	140	140	0,16
T 5 17	17	26,20	140	140	0,19
T 5 18	18	27,80	140	140	0,21
T 5 19	19	29,40	140	140	0,24
T 5 20	20	31,00	160	160	0,31
T 5 21	21	32,70	160	160	0,33
T 5 22	22	34,25	160	160	0,36
T 5 23	23	35,85	160	160	0,39
T 5 24	24	37,40	160	160	0,43
T 5 25	25	38,95	160	160	0,47
T 5 26	26	40,60	160	160	0,51
T 5 27	27	42,20	160	160	0,55
T 5 28	28	43,75	160	160	0,60
T 5 29	29	45,35	160	160	0,65
T 5 30	30	46,95	160	160	0,70
T 5 32	32	50,10	160	160	0,80
T 5 34	34	53,25	160	160	0,91
T 5 35	35	54,85	160	160	0,98
T 5 36	36	56,45	160	160	1,02
T 5 37	37	58,06	160	160	1,08
T 5 38	38	59,65	160	160	1,14
T 5 40	40	62,85	160	160	1,27
T 5 42	42	66,00	160	160	1,41
T 5 44	44	69,20	160	160	1,55
T 5 45	45	70,80	160	160	1,63
T 5 46	46	72,40	160	160	1,69
T 5 48	48	75,55	160	160	1,85
T 5 50	50	78,75	160	160	2,02
T 5 60	60	94,65	160	160	2,95
T 5 72	72	113,75	160	160	4,28
T 5 80	80	126,48	160	160	5,39
T 5 90	90	142,40	160	160	6,76
T 5 100	100	158,31	160	160	8,34

T 10 PASSO 10 mm

MATERIALE: ALLUMINIO UNI 9006 - T6

codice	Z	de	L1	L	Kg.
T 10 10	10	29,98	140	140	0,22
T 10 11	11	33,16	140	140	0,29
T 10 12	12	36,35	140	140	0,34
T 10 13	13	39,55	140	140	0,42
T 10 14	14	42,70	160	160	0,55
T 10 15	15	45,90	160	160	0,64
T 10 16	16	49,10	160	160	0,74
T 10 17	17	52,25	160	160	0,85
T 10 18	18	55,45	160	160	0,96
T 10 19	19	58,65	160	160	1,07
T 10 20	20	61,80	160	160	1,20
T 10 21	21	65,00	160	160	1,29
T 10 22	22	68,20	160	160	1,43
T 10 23	23	71,35	160	160	1,58
T 10 24	24	74,55	160	160	1,73
T 10 26	26	80,90	160	160	2,05
T 10 28	28	87,25	160	160	2,39
T 10 30	30	93,65	160	160	2,76
T 10 32	32	100,00	160	160	3,18
T 10 34	34	106,40	160	160	3,61
T 10 36	36	112,75	160	160	4,06
T 10 38	38	119,10	160	160	4,62
T 10 40	40	125,45	160	160	5,13
T 10 45	45	141,40	160	160	6,50
T 10 48	48	150,95	160	160	7,39
T 10 60	60	189,15	160	160	11,76
T 10 72	72	227,29	160	160	17,03

BARRE DENTATE PASSO METRICO SERIE BAT PER CINGHIE "AT"

METRIC BARS "AT"

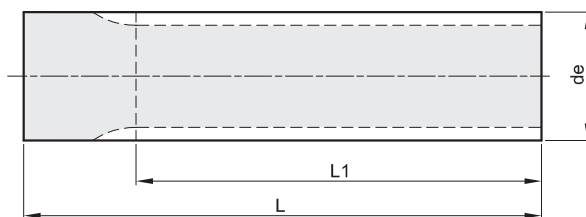

BAT 5 PASSO 5 mm

MATERIALE: ALLUMINIO UNI 9006 - T6

BAT 10 PASSO 10 mm

MATERIALE: ALLUMINIO UNI 9006 - T6

codice	Z	de	L1	L	Kg.
BAT 5 12	12	17,85	140	140	0,08
BAT 5 13	13	19,45	140	140	0,10
BAT 5 14	14	21,05	140	140	0,12
BAT 5 15	15	22,65	140	140	0,14
BAT 5 16	16	24,20	140	140	0,15
BAT 5 17	17	25,80	140	140	0,18
BAT 5 18	18	27,40	140	140	0,20
BAT 5 19	19	29,00	140	140	0,23
BAT 5 20	20	30,60	160	160	0,30
BAT 5 21	21	32,30	160	160	0,33
BAT 5 22	22	33,85	160	160	0,36
BAT 5 23	23	35,45	160	160	0,40
BAT 5 24	24	37,00	160	160	0,44
BAT 5 25	25	38,55	160	160	0,47
BAT 5 26	26	40,20	160	160	0,51
BAT 5 27	27	41,80	160	160	0,55
BAT 5 28	28	43,35	160	160	0,60
BAT 5 30	30	46,55	160	160	0,69
BAT 5 32	32	49,70	160	160	0,81
BAT 5 34	34	52,85	160	160	0,90
BAT 5 36	36	56,05	160	160	1,02
BAT 5 38	38	59,25	160	160	1,14
BAT 5 40	40	62,45	160	160	1,28
BAT 5 42	42	65,60	160	160	1,41
BAT 5 44	44	68,80	160	160	1,55
BAT 5 46	46	72,00	160	160	1,70
BAT 5 48	48	75,15	160	160	1,85
BAT 5 52	52	81,55	160	160	2,19
BAT 5 56	56	87,90	160	160	2,55
BAT 5 58	58	91,10	160	160	2,74
BAT 5 60	60	94,25	160	160	2,94
BAT 5 64	64	100,65	160	160	3,36
BAT 5 72	72	113,35	160	160	4,29

codice	Z	de	L1	L	Kg.
BAT 10 15	15	45,90	160	160	0,62
BAT 10 16	16	49,10	160	160	0,72
BAT 10 17	17	52,25	160	160	0,82
BAT 10 18	18	55,45	160	160	0,94
BAT 10 19	19	58,65	160	160	1,05
BAT 10 20	20	61,80	160	160	1,17
BAT 10 21	21	65,00	160	160	1,31
BAT 10 22	22	68,20	160	160	1,44
BAT 10 23	23	71,35	160	160	1,60
BAT 10 24	24	74,55	160	160	1,75
BAT 10 25	25	77,75	160	160	1,91
BAT 10 26	26	80,90	160	160	2,06
BAT 10 27	27	84,05	160	160	2,23
BAT 10 28	28	87,25	160	160	2,42
BAT 10 30	30	93,65	160	160	2,79
BAT 10 32	32	100,00	160	160	3,20
BAT 10 34	34	106,40	160	160	3,65
BAT 10 36	36	112,75	160	160	4,09
BAT 10 38	38	119,10	160	160	4,59
BAT 10 40	40	125,45	160	160	5,16
BAT 10 42	42	131,85	160	160	5,65
BAT 10 44	44	138,20	160	160	6,22
BAT 10 46	46	144,55	160	160	6,84
BAT 10 48	48	150,95	160	160	7,45
BAT 10 52	52	163,65	160	160	8,93
BAT 10 56	56	176,40	160	160	10,39
BAT 10 58	58	182,75	160	160	10,96
BAT 10 60	60	189,15	160	160	11,78
BAT 10 70	70	220,95	160	160	16,18

Mondial Tecnica Srl
 Via Arenaccia 52 - 80141 Napoli
 Tel. 081.5542121 Fax. 081.281937
 info@mondialtecnicaizzo.com
 www.mondialtecnicaizzo.com

PULEGGE DENTATE A BUSSOLA CONICA PER CINGHIE POSITIVE SYNCHROBELT® - ISO 5294

TIMING BELTS PULLEYS FOR TAPER BUSHES - ISO 5294

L 050

PASSO 3/8" (9,525 mm)

PER CINGHIE LARGHEZZA 1/2" (12,7 mm)

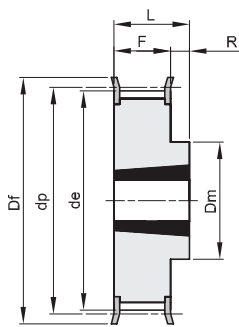

10F

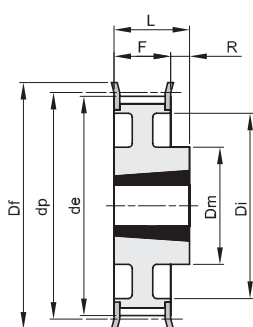

11F

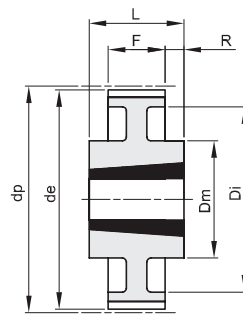

13

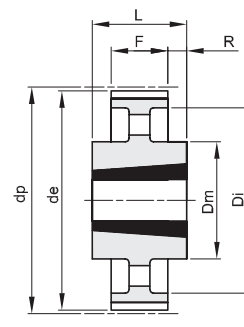

14

Materiale: Acciaio (St)

Materiale: Ghisa (GG)

codice	tipo	materiale	denti	bussola	foro max	dp	de	Df	Dm	Di	F	L	R	n° flangia	Kg.
TL 18 L 050	10F	St	18	1108	28	54,57	53,81	60	44		19,0	22,0	3	308	0,20
TL 19 L 050	10F	St	19	1108	28	57,61	56,84	63	44		19,0	22,0	3	309	0,23
TL 20 L 050	10F	St	20	1108	28	60,64	59,88	66	48		19,0	22,0	3	310	0,27
TL 21 L 050	10F	St	21	1108	28	63,67	62,91	71	48		19,0	22,0	3	311	0,30
TL 22 L 050	10F	St	22	1108	28	66,70	65,94	75	51		19,0	22,0	3	312	0,34
TL 23 L 050	10F	St	23	1108	28	69,73	68,97	79	54		19,0	22,0	3	313	0,40
TL 24 L 050	10F	St	24	1108	28	72,77	72,00	79	54		19,0	22,0	3	313	0,45
TL 25 L 050	10F	St	25	1108	28	75,80	75,04	83	56		19,0	22,0	3	314	0,50
TL 26 L 050	10F	St	26	1108	28	78,83	78,07	87	60		19,0	22,0	3	315	0,55
TL 27 L 050	10F	St	27	1108	28	81,86	81,10	87	62		19,0	22,0	3	315	0,60
TL 28 L 050	10F	St	28	1108	28	84,89	84,13	91	65		19,0	22,0	3	316	0,65
TL 30 L 050	10F	St	30	1108	28	90,96	90,20	97	70		19,0	22,0	3	318	0,80
TL 32 L 050	10F	St	32	1108	28	97,02	96,26	103	74		19,0	22,0	3	320	0,98
TL 36 L 050	10F	St	36	1108	28	109,15	108,39	115	85		19,0	22,0	3	323	1,20
TL 40 L 050	10F	St	40	1610	42	121,28	120,51	127	97		19,0	25,0	6	327	1,40
TL 48 L 050	11F	St	48	1610	42	145,53	144,77	152	88	120	19,0	25,0	6	334	2,30
TL 60 L 050	13	St	60	1610	42	181,91	181,15		92	166	19,0	25,0	3		2,20
TL 72 L 050	14	GG	72	1610	42	218,30	217,53		92	202	19,0	25,0	3		2,10
TL 84 L 050	14	GG	84	1610	42	254,68	253,90		92	236	19,0	25,0	3		2,46
TL 96 L 050	14	GG	96	2012	50	291,06	290,30		106	270	19,0	32,0	6,5		3,36
TL120 L 050	14	GG	120	2012	50	363,83	363,07		106	343	19,0	32,0	6,5		4,44

PULEGGE DENTATE A BUSSOLA CONICA PER CINGHIE POSITIVE SYNCHROBELT® - ISO 5294
TIMING BELTS PULLEYS FOR TAPER BUSHES - ISO 5294

L 075

PASSO 3/8" (9,525 mm)

PER CINGHIE LARGHEZZA 3/4" (19,05 mm)

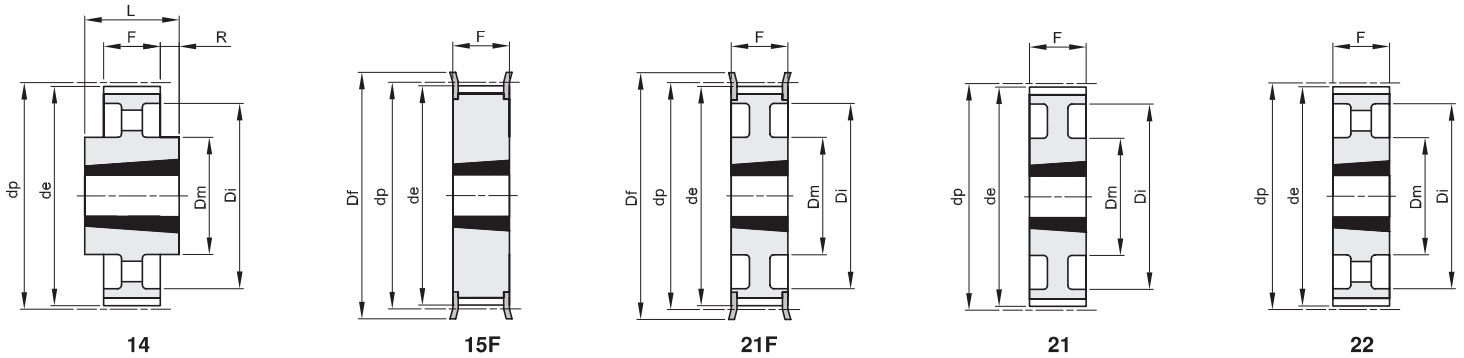

Materiale: Acciaio (St)
 Materiale: Ghisa (GG)

codice	tipo	materiale	denti	bussola	foro max	dp	de	Df	Dm	Di	F	L	R	n° flangia	Kg.
TL 18 L 075	15F	St	18	1108	28	54,57	53,81	60			25,0	25,0		308	0,25
TL 19 L 075	15F	St	19	1108	28	57,61	56,84	63			25,0	25,0		309	0,32
TL 20 L 075	15F	St	20	1108	28	60,64	59,88	66			25,0	25,0		310	0,35
TL 21 L 075	15F	St	21	1108	28	63,67	62,91	71			25,0	25,0		311	0,40
TL 22 L 075	15F	St	22	1108	28	66,70	65,94	75			25,0	25,0		312	0,44
TL 23 L 075	15F	St	23	1108	28	69,73	68,97	79			25,0	25,0		313	0,48
TL 24 L 075	15F	St	24	1108	28	72,77	72,00	79			25,0	25,0		313	0,55
TL 25 L 075	15F	St	25	1108	28	75,80	75,04	83			25,0	25,0		314	0,63
TL 26 L 075	15F	St	26	1108	28	78,83	78,07	87			25,0	25,0		315	0,66
TL 27 L 075	15F	St	27	1108	28	81,86	81,10	87			25,0	25,0		315	0,70
TL 28 L 075	15F	St	28	1108	28	84,89	84,13	91			25,0	25,0		316	0,72
TL 30 L 075	15F	St	30	1108	28	90,96	90,20	97			25,0	25,0		318	0,93
TL 32 L 075	15F	St	32	1108	28	97,02	96,26	103			25,0	25,0		320	1,10
TL 36 L 075	15F	St	36	1610	42	109,15	108,39	115			25,0	25,0		323	1,20
TL 40 L 075	15F	St	40	1610	42	121,28	120,51	127			25,0	25,0		327	1,70
TL 48 L 075	21F	St	48	1610	42	145,53	144,77	152	92	120	25,0	25,0		334	2,60
TL 60 L 075	21	St	60	1610	42	181,91	181,15		92	166	25,0	25,0			3,00
TL 72 L 075	22	GG	72	1610	42	218,30	217,53		92	202	25,0	25,0			2,33
TL 84 L 075	14	GG	84	2012	50	254,68	253,90		106	236	25,0	32,0	3,5		3,55
TL 96 L 075	14	GG	96	2012	50	291,06	290,30		106	270	25,0	32,0	3,5		3,95
TL120 L 075	14	GG	120	2012	50	363,83	363,07		106	343	25,0	32,0	3,5		5,61

PULEGGE DENTATE A BUSSOLA CONICA PER CINGHIE POSITIVE SYNCHROBELT® - ISO 5294

TIMING BELTS PULLEYS FOR TAPER BUSHES - ISO 5294

L 100

PASSO 3/8" (9,525 mm)

PER CINGHIE LARGHEZZA 1" (25,4 mm)

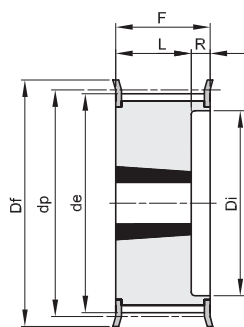

16F

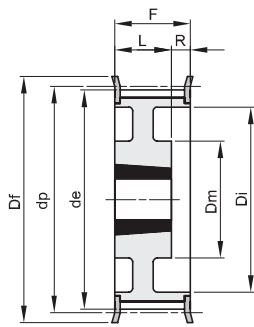

17F

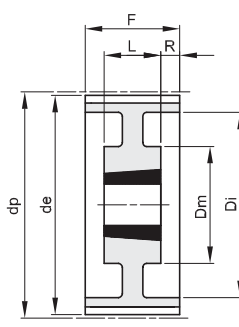

19

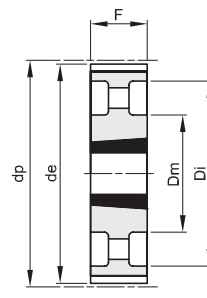

22

Materiale: Acciaio (St)

Materiale: Ghisa (GG)

codice	tipo	materiale	denti	bussola	foro max	dp	de	Df	Dm	Di	F	L	R	n° flangia	Kg.
TL 18 L 100	16F	St	18	1108	28	54,57	53,81	60		38	31,0	22,0	9,0	308	0,20
TL 19 L 100	16F	St	19	1108	28	57,61	56,84	63		38	31,0	22,0	9,0	309	0,32
TL 20 L 100	16F	St	20	1108	28	60,64	59,88	66		45	31,0	22,0	9,0	310	0,41
TL 21 L 100	16F	St	21	1108	28	63,67	62,91	71		45	31,0	22,0	9,0	311	0,45
TL 22 L 100	16F	St	22	1108	28	66,70	65,94	75		48	31,0	22,0	9,0	312	0,47
TL 23 L 100	16F	St	23	1108	28	69,73	68,97	79		52	32,0	22,0	10,0	313	0,50
TL 24 L 100	16F	St	24	1108	28	72,77	72,00	79		52	32,0	22,0	10,0	313	0,64
TL 25 L 100	16F	St	25	1108	28	75,80	75,04	83		54	32,0	22,0	10,0	314	0,68
TL 26 L 100	16F	St	26	1108	28	78,83	78,07	87		60	32,0	22,0	10,0	315	0,70
TL 27 L 100	16F	St	27	1108	28	81,86	81,10	87		60	32,0	22,0	10,0	315	0,83
TL 28 L 100	16F	St	28	1108	28	84,89	84,13	91		65	32,0	22,0	10,0	316	0,85
TL 30 L 100	16F	St	30	1210	32	90,96	90,20	97		71	32,0	25,0	7,0	318	0,90
TL 32 L 100	16F	St	32	1210	32	97,02	96,26	103		75	32,0	25,0	7,0	320	1,05
TL 36 L 100	16F	St	36	1610	42	109,15	108,39	115		86	32,0	25,0	7,0	323	1,40
TL 40 L 100	16F	St	40	1610	42	121,28	120,51	127		96	32,0	25,0	7,0	327	1,65
TL 48 L 100	17F	St	48	1610	42	145,53	144,77	152	92	120	32,0	25,0	7,0	334	2,80
TL 60 L 100	19	St	60	1610	42	181,91	181,15		92	166	32,0	25,0	3,5		2,70
TL 72 L 100	22	GG	72	2012	50	218,30	217,53		106	202	32,0	32,0			2,96
TL 84 L 100	22	GG	84	2012	50	254,68	253,90		106	236	32,0	32,0			3,87
TL 96 L 100	22	GG	96	2012	50	291,06	290,30		106	270	32,0	32,0			4,64
TL120 L 100	22	GG	120	2012	50	363,83	363,07		106	343	32,0	32,0			6,37

PULEGGE DENTATE A BUSSOLA CONICA PER CINGHIE POSITIVE SYNCHROBELT® - ISO 5294
TIMING BELTS PULLEYS FOR TAPER BUSHES - ISO 5294

H 100

PASSO 1/2" (12,7 mm)

PER CINGHIE LARGHEZZA 1" (25,4 mm)

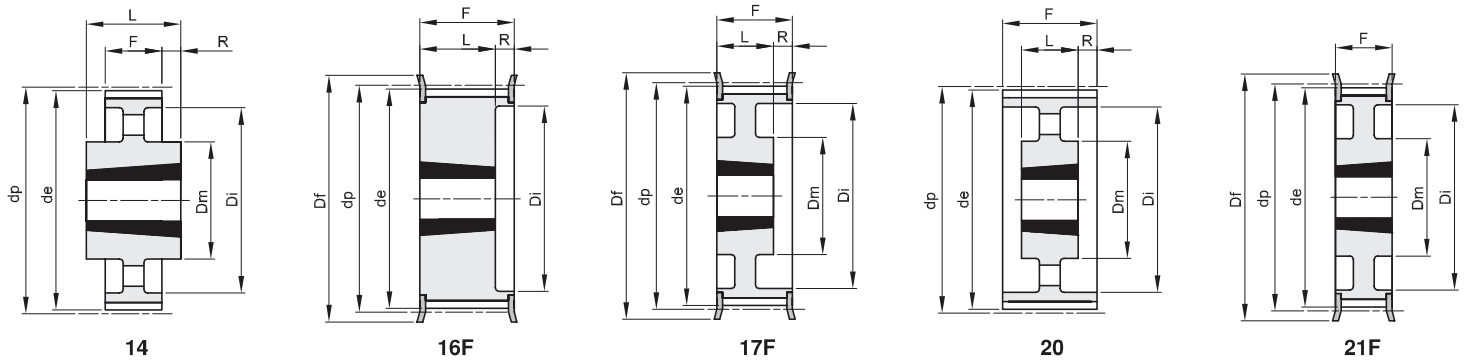

Materiale: Acciaio (St)
 Materiale: Ghisa (GG)

codice	tipo	materiale	denti	bussola	foro max	dp	de	Df	Dm	Di	F	L	R	n° flangia	Kg.
TL 16 H 100	16F	St	16	1108	28	64,68	63,31	71		45	31,0	22,0	9,0	311	0,42
TL 18 H 100	16F	St	18	1210	32	72,77	71,39	79		52	31,0	25,0	6,0	313	0,49
TL 19 H 100	16F	St	19	1210	32	76,81	75,44	83		56	31,0	25,0	6,0	314	0,62
TL 20 H 100	16F	St	20	1210	32	80,85	79,48	87		60	31,0	25,0	6,0	315	0,73
TL 21 H 100	16F	St	21	1210	32	84,89	83,52	91		64	32,0	25,0	7,0	316	0,80
TL 22 H 100	16F	St	22	1210	32	88,94	87,56	93		67	32,0	25,0	7,0	317	0,94
TL 23 H 100	16F	St	23	1610	42	92,98	91,61	97		70	32,0	25,0	7,0	318	0,97
TL 24 H 100	16F	St	24	1610	42	97,02	95,65	103		73,5	32,0	25,0	7,0	320	1,05
TL 25 H 100	16F	St	25	1610	42	101,06	99,69	106		77	32,0	25,0	7,0	321	1,10
TL 26 H 100	16F	St	26	1610	42	105,11	103,73	111		82	32,0	25,0	7,0	322	1,20
TL 27 H 100	16F	St	27	1610	42	109,15	107,78	115		85	32,0	25,0	7,0	323	1,35
TL 28 H 100	16F	St	28	1610	42	113,19	111,82	119		90,5	32,0	25,0	7,0	325	1,50
TL 30 H 100	16F	St	30	1610	42	121,28	119,90	127		98	32,0	25,0	7,0	327	1,78
TL 32 H 100	17F	St	32	1610	42	129,36	127,99	135	90	106	32,0	25,0	7,0	328	2,05
TL 36 H 100	17F	St	36	1610	42	145,53	144,16	152	92	121	32,0	25,0	7,0	334	2,80
TL 40 H 100	17F	St	40	1610	42	161,70	160,33	168	92	138	32,0	25,0	7,0	338	3,65
TL 44 H 100	21F	St	44	2012	50	177,87	176,50	184	106	152	32,0	32,0		339	3,86
TL 48 H 100	21F	St	48	2012	50	194,04	192,67	200	106	169	32,0	32,0		342	4,20
TL 60 H 100	20	GG	60	2012	50	242,55	241,18		106	223	34,0	32,0	1,0		3,76
TL 72 H 100	20	GG	72	2012	50	291,06	289,69		106	270	34,0	32,0	1,0		4,88
TL 84 H 100	20	GG	84	2012	50	339,57	338,20		106	318	34,0	32,0	1,0		6,12
TL 96 H 100	14	GG	96	2517	60	388,08	386,71		119	366	34,0	45,0	5,5		7,95
TL120H 100	14	GG	120	2517	60	485,10	483,73		119	462	34,0	45,0	5,5		10,05

PULEGGE DENTATE A BUSSOLA CONICA PER CINGHIE POSITIVE SYNCHROBELT® - ISO 5294

TIMING BELTS PULLEYS FOR TAPER BUSHES - ISO 5294

H 150

PASSO 1/2" (12,7 mm)

PER CINGHIE LARGHEZZA 1 1/2 (38,1 mm)

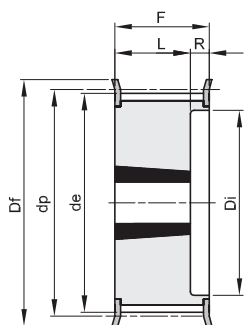

16F

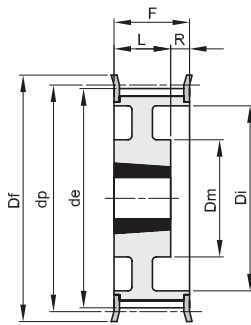

17F

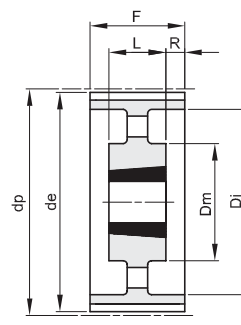

20

Materiale: Acciaio (St)

Materiale: Ghisa (GG)

codice	tipo	materiale	denti	bussola	foro max	dp	de	Df	Dm	Di	F	L	R	n° flangia	Kg.
TL 18 H 150	16F	St	18	1210	32	72,77	71,39	79		52	45,0	25,0	20,0	313	0,60
TL 19 H 150	16F	St	19	1210	32	76,81	75,44	83		56	45,0	25,0	20,0	314	0,72
TL 20 H 150	16F	St	20	1210	32	80,85	79,48	87		60	45,0	25,0	20,0	315	0,83
TL 21 H 150	16F	St	21	1210	32	84,89	83,52	91		64	45,0	25,0	20,0	316	1,00
TL 22 H 150	16F	St	22	1210	32	88,94	87,56	93		67	45,0	25,0	20,0	317	1,25
TL 23 H 150	16F	St	23	1610	42	92,98	91,61	97		70	45,0	25,0	20,0	318	1,05
TL 24 H 150	16F	St	24	1610	42	97,02	95,65	103		73,5	45,0	25,0	20,0	320	1,10
TL 25 H 150	16F	St	25	1610	42	101,06	99,69	106		77	45,0	25,0	20,0	321	1,30
TL 26 H 150	16F	St	26	1610	42	105,11	103,73	111		82	45,0	25,0	20,0	322	1,42
TL 27 H 150	16F	St	27	1610	42	109,15	107,78	115		85	45,0	25,0	20,0	323	1,65
TL 28 H 150	16F	St	28	1610	42	113,19	111,82	119		90,5	45,0	25,0	20,0	325	1,88
TL 30 H 150	16F	St	30	1610	42	121,28	119,90	127		98	45,0	25,0	20,0	327	2,05
TL 32 H 150	17F	St	32	1610	42	129,36	127,99	135	90	106	45,0	25,0	20,0	328	2,35
TL 36 H 150	17F	St	36	1610	42	145,53	144,16	152	92	121	45,0	25,0	20,0	334	3,20
TL 40 H 150	17F	St	40	1610	42	161,70	160,33	168	92	138	45,0	25,0	20,0	338	4,10
TL 44 H 150	17F	St	44	2012	50	177,87	176,50	184	106	152	45,0	32,0	13,0	339	4,50
TL 48 H 150	17F	St	48	2012	50	194,04	192,67	200	106	169	45,0	32,0	13,0	342	4,80
TL 60 H 150	20	GG	60	2012	50	242,55	241,18		106	223	46,0	32,0	7,0		4,51
TL 72 H 150	20	GG	72	2012	50	291,06	289,69		106	270	46,0	32,0	7,0		6,16
TL 84 H 150	20	GG	84	2012	50	339,57	338,20		106	320	46,0	32,0	7,0		7,40
TL 96 H 150	20	GG	96	2517	60	388,08	386,71		119	366	46,0	45,0	0,5		9,87
TL120H 150	20	GG	120	2517	60	485,10	483,73		119	462	46,0	45,0	0,5		13,50

PULEGGE DENTATE A BUSSOLA CONICA PER CINGHIE POSITIVE SYNCHROBELT® - ISO 5294

TIMING BELTS PULLEYS FOR TAPER BUSHES - ISO 5294

H 200

PASSO 1/2" (12,7 mm)

PER CINGHIE LARGHEZZA 2" (50,8 mm)

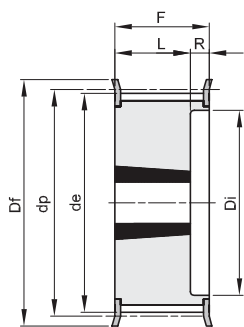

16F

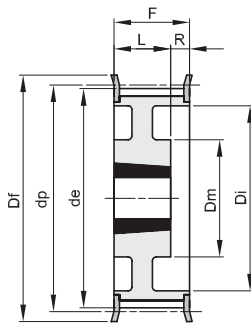

17F

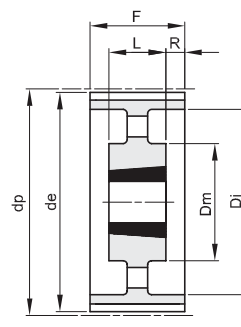

20

Materiale: Acciaio (St)

Materiale: Ghisa (GG)

codice	tipo	materiale	denti	bussola	foro max	dp	de	Df	Dm	Di	F	L	R	n° flangia	Kg.
TL 18 H 200	16F	St	18	1210	32	72,77	71,39	79		52	58,0	25,0	33,0	313	0,84
TL 19 H 200	16F	St	19	1210	32	76,81	75,44	83		56	58,0	25,0	33,0	314	0,96
TL 20 H 200	16F	St	20	1610	42	80,85	79,48	87		60	58,0	25,0	33,0	315	0,93
TL 21 H 200	16F	St	21	1610	42	84,89	83,52	91		64	58,0	25,0	33,0	316	1,07
TL 22 H 200	16F	St	22	1610	42	88,94	87,56	93		67	58,0	25,0	33,0	317	1,25
TL 23 H 200	16F	St	23	1610	42	92,98	91,61	97		70	58,0	25,0	33,0	318	1,40
TL 24 H 200	16F	St	24	1610	42	97,02	95,65	103		73,5	58,0	25,0	33,0	320	1,55
TL 25 H 200	16F	St	25	1610	42	101,06	99,69	106		77	58,0	25,0	33,0	321	1,71
TL 26 H 200	16F	St	26	1610	42	105,11	103,73	111		82	58,0	25,0	33,0	322	1,84
TL 27 H 200	16F	St	27	1610	42	109,15	107,78	115		85	58,0	25,0	33,0	323	2,06
TL 28 H 200	16F	St	28	1610	42	113,19	111,82	119		90,5	58,0	25,0	33,0	325	2,17
TL 30 H 200	16F	St	30	1610	42	121,28	119,90	127		98	58,0	25,0	33,0	327	2,60
TL 32 H 200	16F	St	32	2012	50	129,36	127,99	135		106	58,0	32,0	26,0	328	2,95
TL 36 H 200	17F	St	36	2012	50	145,53	144,16	152	102	121	58,0	32,0	26,0	334	3,62
TL 40 H 200	17F	St	40	2012	50	161,70	160,33	168	106	138	58,0	32,0	26,0	338	4,33
TL 44 H 200	17F	St	44	2012	50	177,87	176,50	184	106	152	58,0	32,0	26,0	339	5,33
TL 48 H 200	17F	St	48	2517	60	194,04	192,67	200	119	169	58,0	45,0	13,0	342	6,47
TL 60 H 200	20	GG	60	2517	60	242,55	241,18		119	223	60,0	45,0	7,5		5,86
TL 72 H 200	20	GG	72	2517	60	291,06	289,69		119	270	60,0	45,0	7,5		7,42
TL 84 H 200	20	GG	84	2517	60	339,57	338,20		119	320	60,0	45,0	7,5		8,73
TL 96 H 200	20	GG	96	2517	60	388,08	386,71		119	366	60,0	45,0	7,5		10,83
TL120H 200	20	GG	120	2517	60	485,10	483,73		119	462	60,0	45,0	7,5		14,95

PULEGGE DENTATE A BUSSOLA CONICA PER CINGHIE POSITIVE SYNCHROBELT® - ISO 5294

TIMING BELTS PULLEYS FOR TAPER BUSHES - ISO 5294

H 300

PASSO 1/2" (12,7 mm)

PER CINGHIE LARGHEZZA 3" (76,2 mm)

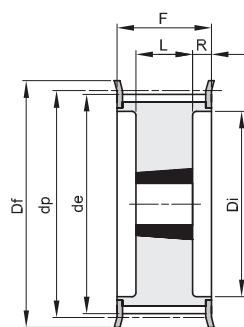

18F

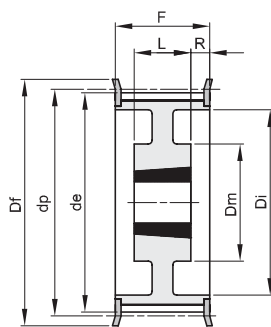

19F

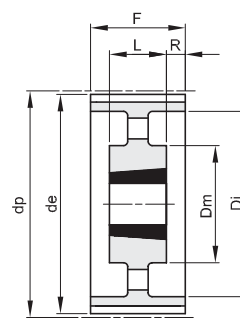

20

Materiale: Acciaio (St)

Materiale: Ghisa (GG)

codice	tipo	materiale	denti	bussola	foro max	dp	de	Df	Dm	Di	F	L	R	n° flangia	Kg.
TL 20 H 300	18F	St	20	1615	42	80,85	79,48	87		64,5	84,0	38,0	23,0	315	1,22
TL 21 H 300	18F	St	21	1615	42	84,89	83,52	91		65	84,0	38,0	23,0	316	1,52
TL 22 H 300	18F	St	22	1615	42	88,94	87,56	93		67	84,0	38,0	23,0	317	1,80
TL 23 H 300	18F	St	23	1615	42	92,98	91,61	97		70	84,0	38,0	23,0	318	2,04
TL 24 H 300	18F	St	24	1615	42	97,02	95,65	103		73,5	84,0	38,0	23,0	320	2,29
TL 25 H 300	18F	St	25	1615	42	101,06	99,69	106		77	84,0	38,0	23,0	321	2,54
TL 26 H 300	18F	St	26	1615	42	105,11	103,73	111		82	84,0	38,0	23,0	322	2,73
TL 27 H 300	18F	St	27	2012	50	109,15	107,78	115		85	84,0	32,0	26,0	323	2,54
TL 28 H 300	18F	St	28	2012	50	113,19	111,82	119		90,5	84,0	32,0	26,0	325	2,68
TL 30 H 300	18F	St	30	2012	50	121,28	119,90	127		98	84,0	32,0	26,0	327	3,21
TL 32 H 300	18F	St	32	2517	60	129,36	127,99	135		106	84,0	45,0	19,5	328	3,58
TL 36 H 300	18F	St	36	2517	60	145,53	144,16	152		121	84,0	45,0	19,5	334	4,99
TL 40 H 300	18F	St	40	2517	60	161,70	160,33	168		138	84,0	45,0	19,5	338	6,50
TL 44 H 300	19F	St	44	2517	60	177,87	176,50	184	119	152	86,0	45,0	20,5	339	7,55
TL 48 H 300	19F	St	48	2517	60	194,04	192,67	200	119	169	86,0	45,0	20,5	342	8,66
TL 60 H 300	20	GG	60	2517	60	242,55	241,18		119	223	86,0	45,0	20,5		7,42
TL 72 H 300	20	GG	72	2517	60	291,06	289,69		119	270	86,0	45,0	20,5		9,33
TL 84 H 300	20	GG	84	2517	60	339,57	338,20		119	320	86,0	45,0	20,5		11,19
TL 96 H 300	20	GG	96	3030	75	388,08	386,71		150	362	86,0	76,0	5,0		17,96
TL120 H 300	20	GG	120	3030	75	485,10	483,73		150	460	86,0	76,0	5,0		22,23

PULEGGE DENTATE PASSO METRICO SERIE "T" - DIN 7721-2

METRIC PULLEYS "T" - DIN 7721-2

T 2,5
PASSO 2,5 mm
 PER CINGHIA LARGHEZZA 6 mm

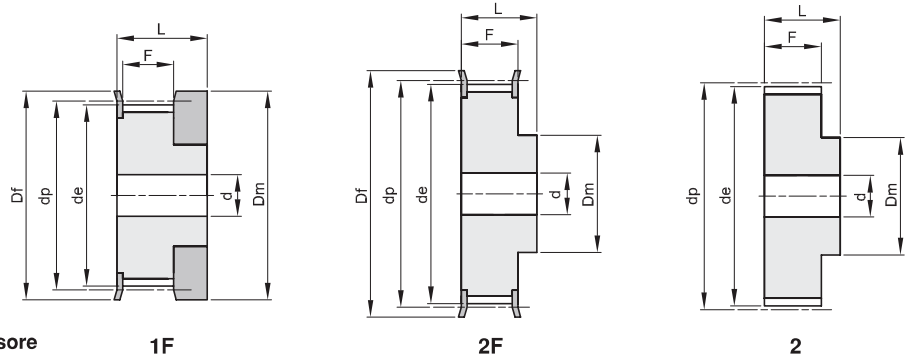

Materiale: Alluminio UNI 9006 - T6 (Al)
 adatto per l'ossidazione dura a spessore

codice	tipo	materiale	denti	de	Df	Dm	F	L	d	n° flangia	Kg.
16 T 2,5 12	1F	Al	12	9,00	13	12	9	16		100	0,01
16 T 2,5 14	1F	Al	14	10,60	15	14	9	16		101	0,01
16 T 2,5 15	1F	Al	15	11,40	15	15	9	16		101	0,01
16 T 2,5 16	1F	Al	16	12,20	16	16	9	16		102	0,01
16 T 2,5 18	2F	Al	18	13,80	18	10	10	16	3	104	0,01
16 T 2,5 19	2F	Al	19	14,60	18	10	10	16	3	104	0,01
16 T 2,5 20	2F	Al	20	15,40	19,5	11	10	16	3	105	0,01
16 T 2,5 22	2F	Al	22	17,00	23	11	10	16	3	106	0,01
16 T 2,5 24	2F	Al	24	18,55	23	12	10	16	3	107	0,01
16 T 2,5 25	2F	Al	25	19,35	23	13	10	16	3	107	0,01
16 T 2,5 26	2F	Al	26	20,15	25	14	10	16	4	108	0,01
16 T 2,5 28	2F	Al	28	21,75	25	14	10	16	4	108	0,02
16 T 2,5 30	2F	Al	30	23,35	28	16	10	16	6	109	0,02
16 T 2,5 32	2F	Al	32	24,95	32	16	10	16	6	110	0,02
16 T 2,5 36	2F	Al	36	28,10	36	20	10	16	6	111	0,03
16 T 2,5 40	2F	Al	40	31,30	38	22	10	16	6	112	0,03
16 T 2,5 44	2	Al	44	34,50		24	10	16	6		0,04
16 T 2,5 48	2	Al	48	37,70		26	10	16	6		0,05
16 T 2,5 60	2	Al	60	47,25		34	10	16	8		0,07

PULEGGE DENTATE PASSO METRICO SERIE "T" - DIN 7721-2

METRIC PULLEYS "T" - DIN 7721-2

T 5
PASSO 5 mm
 PER CINGHIA LARGHEZZA 10 mm

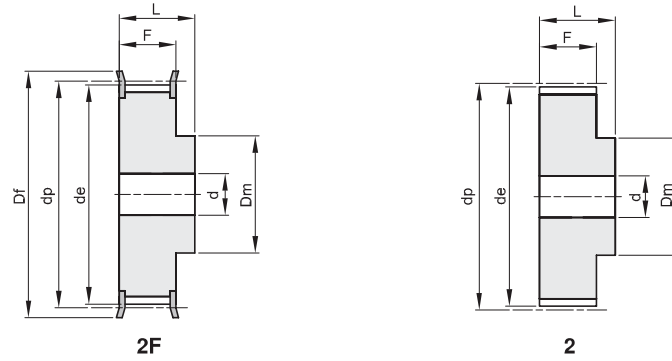

Materiale: Alluminio UNI 9006 - T6 (Al)
 adatto per l'ossidazione dura a spessore

codice	tipo	materiale	denti	de	Df	Dm	F	L	d	n° flangia	Kg.
21 T 5 10	2F	Al	10	15,05	19,5	8	15	21		200	0,01
21 T 5 12	2F	Al	12	18,25	23	10	15	21		201	0,01
21 T 5 14	2F	Al	14	21,45	25	13	15	21		203	0,02
21 T 5 15	2F	Al	15	23,05	28	16	15	21		204	0,02
21 T 5 16	2F	Al	16	24,60	32	18	15	21		205	0,03
21 T 5 18	2F	Al	18	27,80	32	20	15	21		205	0,03
21 T 5 19	2F	Al	19	29,40	36	22	15	21		206	0,04
21 T 5 20	2F	Al	20	31,00	36	23	15	21		206	0,04
21 T 5 22	2F	Al	22	34,25	38	24	15	21		207	0,05
21 T 5 24	2F	Al	24	37,40	42	26	15	21		208	0,06
21 T 5 25	2F	Al	25	38,95	44	26	15	21		209	0,06
21 T 5 26	2F	Al	26	40,60	44	26	15	21		209	0,06
21 T 5 27	2F	Al	27	42,20	48	30	15	21	8	210	0,07
21 T 5 28	2F	Al	28	43,75	48	32	15	21	8	210	0,07
21 T 5 30	2F	Al	30	46,95	51	34	15	21	8	211	0,07
21 T 5 32	2F	Al	32	50,10	54	38	15	21	8	212	0,09
21 T 5 36	2F	Al	36	56,45	63	38	15	21	8	215	0,11
21 T 5 40	2F	Al	40	62,85	66	40	15	21	8	216	0,14
21 T 5 42	2F	Al	42	66,00	71	40	15	21	8	217	0,18
21 T 5 44	2	Al	44	69,20		45	15	21	8		0,18
21 T 5 48	2	Al	48	75,55		50	15	21	8		0,20
21 T 5 60	2	Al	60	94,65		65	15	21	8		0,31

PULEGGE DENTATE PASSO METRICO SERIE "T" - DIN 7721-2

METRIC PULLEYS "T" - DIN 7721-2

T 5

PASSO 5 mm

PER CINGHIA LARGHEZZA 16 mm

Materiale: Alluminio UNI 9006 - T6 (Al)
adatto per l'ossidazione dura a spessore

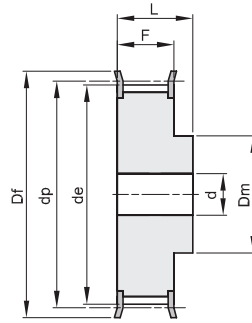

2F

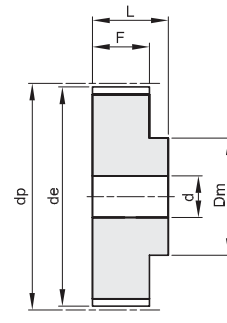

2

codice	tipo	materiale	denti	de	Df	Dm	F	L	d	n° flangia	Kg.
27 T 5 10	2F	Al	10	15,05	19,5	8	21	27		200	0,02
27 T 5 12	2F	Al	12	18,25	23	10	21	27		201	0,02
27 T 5 14	2F	Al	14	21,45	25	13	21	27		203	0,03
27 T 5 15	2F	Al	15	23,05	28	16	21	27		204	0,03
27 T 5 16	2F	Al	16	24,60	32	18	21	27		205	0,04
27 T 5 18	2F	Al	18	27,80	32	20	21	27		205	0,04
27 T 5 19	2F	Al	19	29,40	36	22	21	27		206	0,05
27 T 5 20	2F	Al	20	31,00	36	23	21	27		206	0,06
27 T 5 22	2F	Al	22	34,25	38	24	21	27		207	0,06
27 T 5 24	2F	Al	24	37,40	42	26	21	27		208	0,08
27 T 5 25	2F	Al	25	38,95	44	26	21	27		209	0,08
27 T 5 26	2F	Al	26	40,60	44	26	21	27		209	0,09
27 T 5 27	2F	Al	27	42,20	48	30	21	27	8	210	0,09
27 T 5 28	2F	Al	28	43,75	48	32	21	27	8	210	0,09
27 T 5 30	2F	Al	30	46,95	51	34	21	27	8	211	0,10
27 T 5 32	2F	Al	32	50,10	54	38	21	27	8	212	0,12
27 T 5 36	2F	Al	36	56,45	63	38	21	27	8	215	0,16
27 T 5 40	2F	Al	40	62,85	66	40	21	27	8	216	0,19
27 T 5 42	2F	Al	42	66,00	71	40	21	27	8	217	0,20
27 T 5 44	2	Al	44	69,20		45	21	27	8		0,23
27 T 5 48	2	Al	48	75,55		50	21	27	8		0,28
27 T 5 60	2	Al	60	94,65		65	21	27	8		0,43

Mondial Tecnica Srl
Via Arenaccia 52 - 80141 Napoli
Tel. 081.5542121 Fax. 081.281937
info@mondialtecnicaizzo.com
www.mondialtecnicaizzo.com

PULEGGE DENTATE PASSO METRICO SERIE "T" - DIN 7721-2

METRIC PULLEYS "T" - DIN 7721-2

T 5
PASSO 5 mm
 PER CINGHIA LARGHEZZA 25 mm

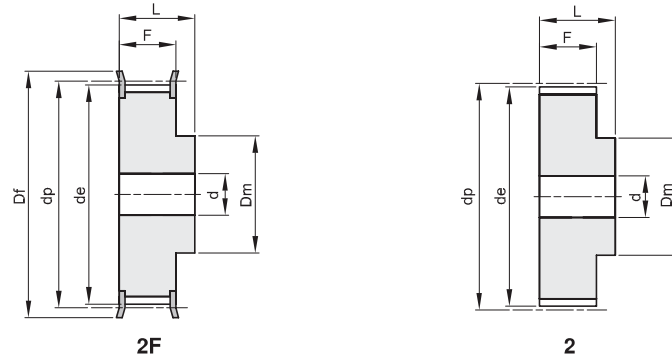

Materiale: Alluminio UNI 9006 - T6 (Al)
 adatto per l'ossidazione dura a spessore

codice	tipo	materiale	denti	de	Df	Dm	F	L	d	n° flangia	Kg.
36 T 5 10	2F	Al	10	15,05	19,5	8	30	36		200	0,02
36 T 5 12	2F	Al	12	18,25	23	10	30	36		201	0,03
36 T 5 14	2F	Al	14	21,45	25	13	30	36		203	0,04
36 T 5 15	2F	Al	15	23,05	28	16	30	36		204	0,04
36 T 5 16	2F	Al	16	24,60	32	18	30	36		205	0,05
36 T 5 18	2F	Al	18	27,80	32	20	30	36		205	0,06
36 T 5 19	2F	Al	19	29,40	36	22	30	36		206	0,07
36 T 5 20	2F	Al	20	31,00	36	23	30	36		206	0,08
36 T 5 22	2F	Al	22	34,25	38	24	30	36		207	0,08
36 T 5 24	2F	Al	24	37,40	42	26	30	36		208	0,11
36 T 5 25	2F	Al	25	38,95	44	26	30	36		209	0,12
36 T 5 26	2F	Al	26	40,60	44	26	30	36		209	0,12
36 T 5 27	2F	Al	27	42,20	48	30	30	36	8	210	0,13
36 T 5 28	2F	Al	28	43,75	48	32	30	36	8	210	0,14
36 T 5 30	2F	Al	30	46,95	51	34	30	36	8	211	0,15
36 T 5 32	2F	Al	32	50,10	54	38	30	36	8	212	0,18
36 T 5 36	2F	Al	36	56,45	63	38	30	36	8	215	0,23
36 T 5 40	2F	Al	40	62,85	66	40	30	36	8	216	0,28
36 T 5 42	2F	Al	42	66,00	71	40	30	36	8	217	0,29
36 T 5 44	2	Al	44	69,20		45	30	36	8		0,31
36 T 5 48	2	Al	48	75,55		50	30	36	8		0,40
36 T 5 60	2	Al	60	94,65		65	30	36	8		0,61

Mondial Tecnica Srl
 Via Arenaccia 52 - 80141 Napoli
 Tel. 081.5542121 Fax. 081.281937
 info@mondialtecnicaizzo.com
 www.mondialtecnicaizzo.com

PULEGGE DENTATE PASSO METRICO SERIE "T" - DIN 7721-2

METRIC PULLEYS "T" - DIN 7721-2

T 10
PASSO 10 mm
 PER CINGHIA LARGHEZZA 16 mm

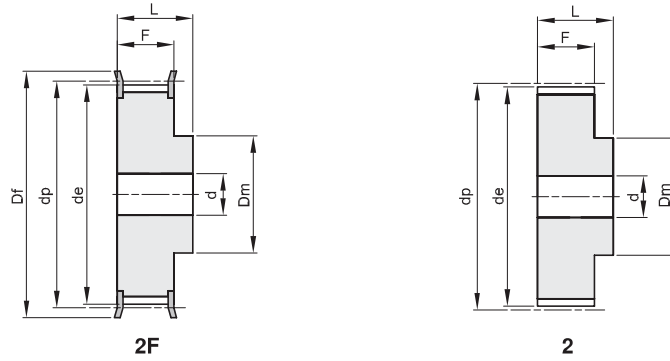

Materiale: Alluminio UNI 9006 - T6 (Al)
 adatto per l'ossidazione dura a spessore

codice	tipo	materiale	denti	de	Df	Dm	F	L	d	n° flangia	Kg.
31 T 10 12	2F	Al	12	36,35	42	28	21	31	6	208	0,08
31 T 10 14	2F	Al	14	42,70	48	32	21	31	8	210	0,10
31 T 10 15	2F	Al	15	45,90	51	32	21	31	8	211	0,12
31 T 10 16	2F	Al	16	49,10	54	35	21	31	8	212	0,13
31 T 10 18	2F	Al	18	55,45	60	40	21	31	8	214	0,17
31 T 10 19	2F	Al	19	58,65	66	44	21	31	8	216	0,18
31 T 10 20	2F	Al	20	61,80	66	46	21	31	8	216	0,21
31 T 10 22	2F	Al	22	68,20	75	52	21	31	8	218	0,25
31 T 10 24	2F	Al	24	74,55	83	58	21	31	8	219	0,29
31 T 10 25	2F	Al	25	77,75	83	60	21	31	8	219	0,31
31 T 10 26	2F	Al	26	80,90	87	60	21	31	8	220	0,36
31 T 10 27	2F	Al	27	84,10	91	60	21	31	8	221	0,37
31 T 10 28	2F	Al	28	87,25	93	60	21	31	8	222	0,40
31 T 10 30	2F	Al	30	93,65	97	60	21	31	8	223	0,44
31 T 10 32	2F	Al	32	100,00	106	65	21	31	10	224	0,49
31 T 10 36	2F	Al	36	112,75	119	70	21	31	10	225	0,62
31 T 10 40	2F	Al	40	125,45	131	80	21	31	10	226	0,77
31 T 10 44	2	Al	44	138,20		88	21	31	10		1,00
31 T 10 48	2	Al	48	150,95		95	21	31	16		1,10
31 T 10 60	2	Al	60	189,15		110	21	31	16		1,70

Mondial Tecnica Srl
 Via Arenaccia 52 - 80141 Napoli
 Tel. 081.5542121 Fax. 081.281937
 info@mondialtecnicaizzo.com
 www.mondialtecnicaizzo.com

PULEGGE DENTATE PASSO METRICO SERIE "T" - DIN 7721-2

METRIC PULLEYS "T" - DIN 7721-2

T 10
PASSO 10 mm
 PER CINGHIA LARGHEZZA 25 mm

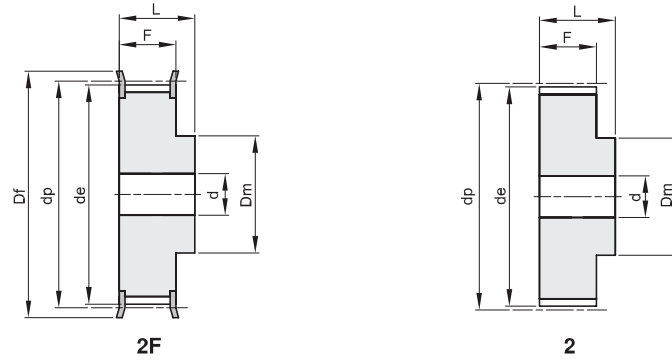

Materiale: Alluminio UNI 9006 - T6 (Al)
 adatto per l'ossidazione dura a spessore

codice	tipo	materiale	denti	de	Df	Dm	F	L	d	n° flangia	Kg.
40 T 10 12	2F	Al	12	36,35	42	28	30	40	6	208	0,10
40 T 10 14	2F	Al	14	42,70	48	32	30	40	8	210	0,13
40 T 10 15	2F	Al	15	45,90	51	32	30	40	8	211	0,15
40 T 10 16	2F	Al	16	49,10	54	35	30	40	8	212	0,18
40 T 10 18	2F	Al	18	55,45	60	40	30	40	8	214	0,22
40 T 10 19	2F	Al	19	58,65	66	44	30	40	8	216	0,25
40 T 10 20	2F	Al	20	61,80	66	46	30	40	8	216	0,28
40 T 10 22	2F	Al	22	68,20	75	52	30	40	8	218	0,34
40 T 10 24	2F	Al	24	74,55	83	58	30	40	8	219	0,39
40 T 10 25	2F	Al	25	77,75	83	60	30	40	8	219	0,42
40 T 10 26	2F	Al	26	80,90	87	60	30	40	8	220	0,48
40 T 10 27	2F	Al	27	84,10	91	60	30	40	8	221	0,54
40 T 10 28	2F	Al	28	87,25	93	60	30	40	8	222	0,55
40 T 10 30	2F	Al	30	93,65	97	60	30	40	8	223	0,64
40 T 10 32	2F	Al	32	100,00	106	65	30	40	10	224	0,69
40 T 10 36	2F	Al	36	112,75	119	70	30	40	10	225	0,87
40 T 10 40	2F	Al	40	125,45	131	80	30	40	10	226	1,07
40 T 10 44	2	Al	44	138,20		88	30	40	10		1,35
40 T 10 48	2	Al	48	150,95		95	30	40	16		1,52
40 T 10 60	2	Al	60	189,15		110	30	40	16		2,34

Mondial Tecnica Srl
 Via Arenaccia 52 - 80141 Napoli
 Tel. 081.5542121 Fax. 081.281937
 info@mondialtecnicaizzo.com
 www.mondialtecnicaizzo.com

PULEGGE DENTATE PASSO METRICO SERIE "T" - DIN 7721-2

METRIC PULLEYS "T" - DIN 7721-2

T 10
PASSO 10 mm
 PER CINGHIA LARGHEZZA 32 mm

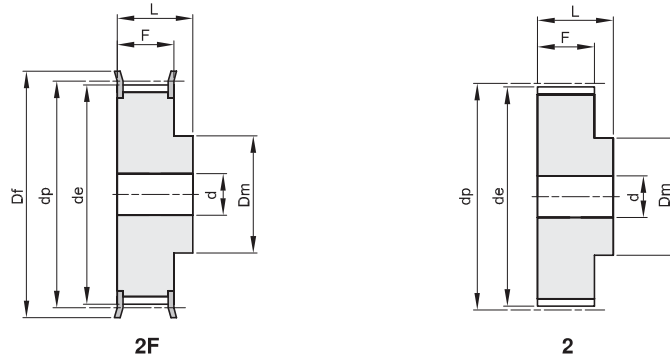

Materiale: Alluminio UNI 9006 - T6 (Al)
 adatto per l'ossidazione dura a spessore

codice	tipo	materiale	denti	de	Df	Dm	F	L	d	n° flangia	Kg.
47 T 10 18	2F	Al	18	55,45	60	40	37	47	10	214	0,25
47 T 10 19	2F	Al	19	58,65	66	44	37	47	10	216	0,29
47 T 10 20	2F	Al	20	61,80	66	46	37	47	12	216	0,32
47 T 10 22	2F	Al	22	68,20	75	52	37	47	12	218	0,39
47 T 10 24	2F	Al	24	74,55	83	58	37	47	12	219	0,47
47 T 10 25	2F	Al	25	77,75	83	60	37	47	12	219	0,53
47 T 10 26	2F	Al	26	80,90	87	60	37	47	12	220	0,56
47 T 10 27	2F	Al	27	84,10	91	60	37	47	12	221	0,60
47 T 10 28	2F	Al	28	87,25	93	60	37	47	12	222	0,64
47 T 10 30	2F	Al	30	93,65	97	60	37	47	12	223	0,74
47 T 10 32	2F	Al	32	100,00	106	65	37	47	12	224	0,84
47 T 10 36	2F	Al	36	112,75	119	70	37	47	16	225	1,06
47 T 10 40	2F	Al	40	125,45	131	80	37	47	16	226	1,32
47 T 10 44	2	Al	44	138,20		88	37	47	16		1,61
47 T 10 48	2	Al	48	150,95		95	37	47	16		1,93
47 T 10 60	2	Al	60	189,10		110	37	47	16		3,00

Mondial Tecnica Srl
 Via Arenaccia 52 - 80141 Napoli
 Tel. 081.5542121 Fax. 081.281937
 info@mondialtecnicaizzo.com
 www.mondialtecnicaizzo.com

PULEGGE DENTATE PASSO METRICO SERIE "T" - DIN 7721-2

METRIC PULLEYS "T" - DIN 7721-2

T 10
PASSO 10 mm
 PER CINGHIA LARGHEZZA 50 mm

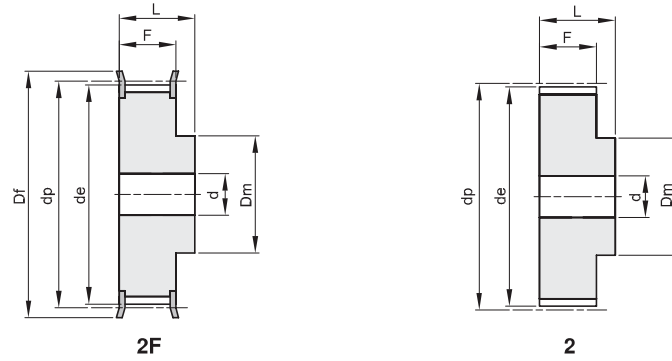

Materiale: Alluminio UNI 9006 - T6 (Al)
 adatto per l'ossidazione dura a spessore

codice	tipo	materiale	denti	de	Df	Dm	F	L	d	n° flangia	Kg.
66 T 10 18	2F	Al	18	55,45	60	40	56	66	10	214	0,42
66 T 10 19	2F	Al	19	58,65	66	44	56	66	10	216	0,47
66 T 10 20	2F	Al	20	61,80	66	46	56	66	12	216	0,52
66 T 10 22	2F	Al	22	68,20	75	52	56	66	12	218	0,57
66 T 10 24	2F	Al	24	74,55	83	58	56	66	12	219	0,74
66 T 10 25	2F	Al	25	77,75	83	60	56	66	12	219	0,77
66 T 10 26	2F	Al	26	80,90	87	60	56	66	12	220	0,82
66 T 10 27	2F	Al	27	84,10	91	60	56	66	12	221	0,95
66 T 10 28	2F	Al	28	87,25	93	60	56	66	12	222	0,96
66 T 10 30	2F	Al	30	93,65	97	60	56	66	12	223	1,17
66 T 10 32	2F	Al	32	100,00	106	65	56	66	12	224	1,30
66 T 10 36	2F	Al	36	112,75	119	70	56	66	16	225	1,64
66 T 10 40	2F	Al	40	125,45	131	80	56	66	16	226	2,00
66 T 10 44	2	Al	44	138,20		88	56	66	16		2,36
66 T 10 48	2	Al	48	150,95		95	56	66	16		2,83
66 T 10 60	2	Al	60	189,10		110	56	66	16		4,37

Mondial Tecnica Srl
 Via Arenaccia 52 - 80141 Napoli
 Tel. 081.5542121 Fax. 081.281937
 info@mondialtecnicaizzo.com
 www.mondialtecnicaizzo.com

PULEGGE DENTATE PASSO METRICO SERIE BAT PER CINGHIE "AT" METRIC PULLEYS "AT"

BAT 5
PASSO 5 mm
PER CINGHIA AT LARGHEZZA 10 mm

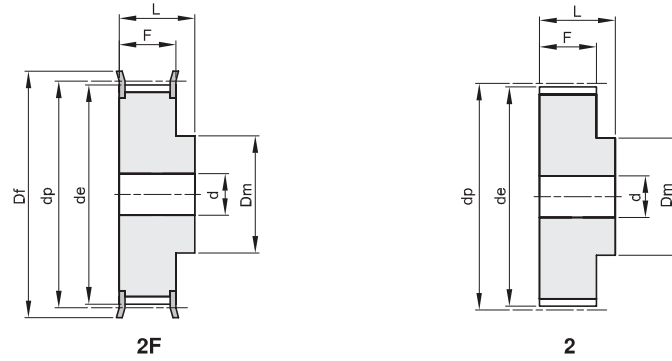

Materiale: Alluminio UNI 9006 - T6 (Al)
adatto per l'ossidazione dura a spessore

codice	tipo	materiale	denti	de	Df	Dm	F	L	d	n° flangia	Kg.
21 BAT 5 12	2F	Al	12	17,85	23	10	15	21		201	0,01
21 BAT 5 14	2F	Al	14	21,05	25	13	15	21		203	0,02
21 BAT 5 15	2F	Al	15	22,65	28	16	15	21		204	0,02
21 BAT 5 16	2F	Al	16	24,20	32	18	15	21		205	0,03
21 BAT 5 18	2F	Al	18	27,40	32	20	15	21		205	0,03
21 BAT 5 19	2F	Al	19	29,00	36	22	15	21		206	0,04
21 BAT 5 20	2F	Al	20	30,60	36	23	15	21		206	0,04
21 BAT 5 22	2F	Al	22	33,85	38	24	15	21		207	0,05
21 BAT 5 24	2F	Al	24	37,00	42	26	15	21		208	0,06
21 BAT 5 25	2F	Al	25	38,55	44	26	15	21		209	0,06
21 BAT 5 26	2F	Al	26	40,20	44	26	15	21		209	0,06
21 BAT 5 27	2F	Al	27	41,80	48	30	15	21	8	210	0,07
21 BAT 5 28	2F	Al	28	43,35	48	32	15	21	8	210	0,07
21 BAT 5 30	2F	Al	30	46,55	51	34	15	21	8	211	0,07
21 BAT 5 32	2F	Al	32	49,70	54	38	15	21	8	212	0,09
21 BAT 5 36	2F	Al	36	56,05	63	38	15	21	8	215	0,11
21 BAT 5 40	2F	Al	40	62,45	66	40	15	21	8	216	0,14
21 BAT 5 42	2F	Al	42	65,60	71	40	15	21	8	217	0,18
21 BAT 5 44	2	Al	44	68,80		45	15	21	8		0,18
21 BAT 5 48	2	Al	48	75,15		50	15	21	8		0,20
21 BAT 5 60	2	Al	60	94,25		65	15	21	8		0,31

Mondial Tecnica Srl
Via Arenaccia 52 - 80141 Napoli
Tel. 081.5542121 Fax. 081.281937
info@mondialtecnicaizzo.com
www.mondialtecnicaizzo.com

PULEGGE DENTATE PASSO METRICO SERIE BAT PER CINGHIE "AT" METRIC PULLEYS "AT"

BAT 5
PASSO 5 mm
PER CINGHIA AT LARGHEZZA 16 mm

Materiale: Alluminio UNI 9006 - T6 (Al)
adatto per l'ossidazione dura a spessore

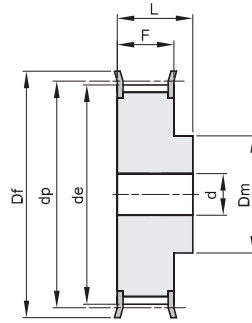

2F

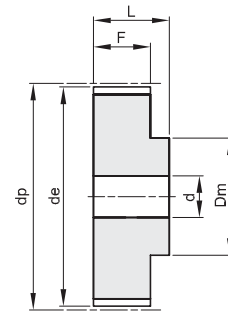

2

codice	tipo	materiale	denti	de	Df	Dm	F	L	d	n° flangia	Kg.
27 BAT 5 12	2F	Al	12	17,85	23	10	21	27		201	0,02
27 BAT 5 14	2F	Al	14	21,05	25	13	21	27		203	0,03
27 BAT 5 15	2F	Al	15	22,65	28	16	21	27		204	0,03
27 BAT 5 16	2F	Al	16	24,20	32	18	21	27		205	0,04
27 BAT 5 18	2F	Al	18	27,40	32	20	21	27		205	0,04
27 BAT 5 19	2F	Al	19	29,00	36	22	21	27		206	0,05
27 BAT 5 20	2F	Al	20	30,60	36	23	21	27		206	0,06
27 BAT 5 22	2F	Al	22	33,85	38	24	21	27		207	0,06
27 BAT 5 24	2F	Al	24	37,00	42	26	21	27		208	0,08
27 BAT 5 25	2F	Al	25	38,55	44	26	21	27		209	0,08
27 BAT 5 26	2F	Al	26	40,20	44	26	21	27		209	0,09
27 BAT 5 27	2F	Al	27	41,80	48	30	21	27	8	210	0,09
27 BAT 5 28	2F	Al	28	43,35	48	32	21	27	8	210	0,09
27 BAT 5 30	2F	Al	30	46,55	51	34	21	27	8	211	0,10
27 BAT 5 32	2F	Al	32	49,70	54	38	21	27	8	212	0,12
27 BAT 5 36	2F	Al	36	56,05	63	38	21	27	8	215	0,16
27 BAT 5 40	2F	Al	40	62,45	66	40	21	27	8	216	0,19
27 BAT 5 42	2F	Al	42	65,60	71	40	21	27	8	217	0,20
27 BAT 5 44	2	Al	44	68,80		45	21	27	8		0,23
27 BAT 5 48	2	Al	48	75,15		50	21	27	8		0,28
27 BAT 5 60	2	Al	60	94,25		65	21	27	8		0,43

Mondial Tecnica Srl
Via Arenaccia 52 - 80141 Napoli
Tel. 081.5542121 Fax. 081.281937
info@mondialtecnicaizzo.com
www.mondialtecnicaizzo.com

PULEGGE DENTATE PASSO METRICO SERIE BAT PER CINGHIE "AT" METRIC PULLEYS "AT"

BAT 5

PASSO 5 mm

PER CINGHIA AT LARGHEZZA 25 mm

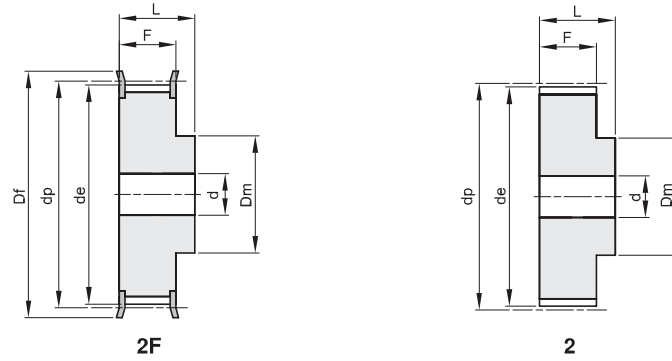

Materiale: Alluminio UNI 9006 - T6 (Al)
adatto per l'ossidazione dura a spessore

codice	tipo	materiale	denti	de	Df	Dm	F	L	d	n° flangia	Kg.
36 BAT 5 12	2F	Al	12	17,85	23	10	30	36		201	0,03
36 BAT 5 14	2F	Al	14	21,05	25	13	30	36		203	0,04
36 BAT 5 15	2F	Al	15	22,65	28	16	30	36		204	0,04
36 BAT 5 16	2F	Al	16	24,20	32	18	30	36		205	0,05
36 BAT 5 18	2F	Al	18	27,40	32	20	30	36		205	0,06
36 BAT 5 19	2F	Al	19	29,00	36	22	30	36		206	0,07
36 BAT 5 20	2F	Al	20	30,60	36	23	30	36		206	0,08
36 BAT 5 22	2F	Al	22	33,85	38	24	30	36		207	0,08
36 BAT 5 24	2F	Al	24	37,00	42	26	30	36	8	208	0,11
36 BAT 5 25	2F	Al	25	38,55	44	26	30	36	8	209	0,12
36 BAT 5 26	2F	Al	26	40,20	44	26	30	36	8	209	0,12
36 BAT 5 27	2F	Al	27	41,80	48	30	30	36	8	210	0,13
36 BAT 5 28	2F	Al	28	43,35	48	32	30	36	8	210	0,14
36 BAT 5 30	2F	Al	30	46,55	51	34	30	36	8	211	0,15
36 BAT 5 32	2F	Al	32	49,70	54	38	30	36	8	212	0,18
36 BAT 5 36	2F	Al	36	56,05	63	38	30	36	8	215	0,23
36 BAT 5 40	2F	Al	40	62,45	66	40	30	36	8	216	0,28
36 BAT 5 42	2F	Al	42	65,60	71	40	30	36	8	217	0,29
36 BAT 5 44	2	Al	44	68,80		45	30	36	8		0,31
36 BAT 5 48	2	Al	48	75,15		50	30	36	8		0,40
36 BAT 5 60	2	Al	60	94,25		65	30	36	8		0,61

Mondial Tecnica Srl
Via Arenaccia 52 - 80141 Napoli
Tel. 081.5542121 Fax. 081.281937
info@mondialtecnicaizzo.com
www.mondialtecnicaizzo.com

PULEGGE DENTATE PASSO METRICO SERIE BAT PER CINGHIE "AT" METRIC PULLEYS "AT"

BAT 10
PASSO 10 mm
PER CINGHIA AT LARGHEZZA 16 mm

Materiale: Alluminio UNI 9006 - T6 (Al)
adatto per l'ossidazione dura a spessore

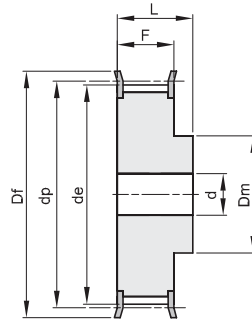

2F

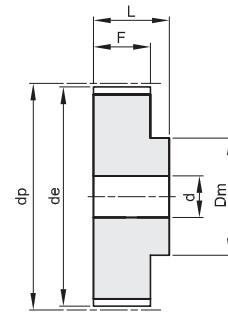

2

codice	tipo	materiale	dent	de	Df	Dm	F	L	d	n° flangia	Kg.
31 BAT 10 15	2F	Al	15	45,90	51	32	21	31	8	211	0,12
31 BAT 10 16	2F	Al	16	49,10	54	35	21	31	8	212	0,13
31 BAT 10 18	2F	Al	18	55,45	60	40	21	31	8	214	0,17
31 BAT 10 19	2F	Al	19	58,65	66	44	21	31	8	216	0,18
31 BAT 10 20	2F	Al	20	61,80	66	46	21	31	8	216	0,21
31 BAT 10 22	2F	Al	22	68,20	75	52	21	31	8	218	0,25
31 BAT 10 24	2F	Al	24	74,55	83	58	21	31	8	219	0,29
31 BAT 10 25	2F	Al	25	77,75	83	60	21	31	8	219	0,31
31 BAT 10 26	2F	Al	26	80,90	87	60	21	31	8	220	0,36
31 BAT 10 27	2F	Al	27	84,05	91	60	21	31	8	221	0,37
31 BAT 10 28	2F	Al	28	87,25	93	60	21	31	8	222	0,40
31 BAT 10 30	2F	Al	30	93,65	97	60	21	31	8	223	0,44
31 BAT 10 32	2F	Al	32	100,00	106	65	21	31	10	224	0,49
31 BAT 10 36	2F	Al	36	112,75	119	70	21	31	10	225	0,62
31 BAT 10 40	2F	Al	40	125,45	131	80	21	31	10	226	0,77
31 BAT 10 44	2	Al	44	138,20		88	21	31	10		1,00
31 BAT 10 48	2	Al	48	150,95		95	21	31	16		1,10
31 BAT 10 60	2	Al	60	189,15		110	21	31	16		1,70

Mondial Tecnica Srl
Via Arenaccia 52 - 80141 Napoli
Tel. 081.5542121 Fax. 081.281937
info@mondialtecnicaizzo.com
www.mondialtecnicaizzo.com

PULEGGE DENTATE PASSO METRICO SERIE BAT PER CINGHIE "AT"

METRIC PULLEYS "AT"

BAT 10
PASSO 10 mm
 PER CINGHIA AT LARGHEZZA 25 mm

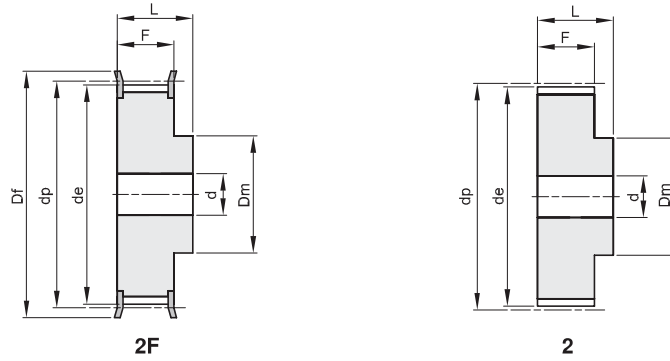

Materiale: Alluminio UNI 9006 - T6 (Al)
 adatto per l'ossidazione dura a spessore

codice	tipo	materiale	denti	de	Df	Dm	F	L	d	n° flangia	Kg.
40 BAT 10 15	2F	Al	15	45,90	51	32	30	40	8	211	0,15
40 BAT 10 16	2F	Al	16	49,10	54	35	30	40	8	212	0,18
40 BAT 10 18	2F	Al	18	55,45	60	40	30	40	8	214	0,22
40 BAT 10 19	2F	Al	19	58,65	66	44	30	40	8	216	0,25
40 BAT 10 20	2F	Al	20	61,80	66	46	30	40	8	216	0,28
40 BAT 10 22	2F	Al	22	68,20	75	52	30	40	8	218	0,34
40 BAT 10 24	2F	Al	24	74,55	83	58	30	40	8	219	0,39
40 BAT 10 25	2F	Al	25	77,75	83	60	30	40	8	219	0,42
40 BAT 10 26	2F	Al	26	80,90	87	60	30	40	8	220	0,48
40 BAT 10 27	2F	Al	27	84,05	91	60	30	40	8	221	0,54
40 BAT 10 28	2F	Al	28	87,25	93	60	30	40	8	222	0,55
40 BAT 10 30	2F	Al	30	93,65	97	60	30	40	8	223	0,64
40 BAT 10 32	2F	Al	32	100,00	106	65	30	40	10	224	0,69
40 BAT 10 36	2F	Al	36	112,75	119	70	30	40	10	225	0,87
40 BAT 10 40	2F	Al	40	125,45	131	80	30	40	10	226	1,07
40 BAT 10 44	2	Al	44	138,20		88	30	40	10		1,35
40 BAT 10 48	2	Al	48	150,95		95	30	40	16		1,52
40 BAT 10 60	2	Al	60	189,15		110	30	40	16		2,34

Mondial Tecnica Srl
 Via Arenaccia 52 - 80141 Napoli
 Tel. 081.5542121 Fax. 081.281937
 info@mondialtecnicaizzo.com
 www.mondialtecnicaizzo.com

PULEGGE DENTATE PASSO METRICO SERIE BAT PER CINGHIE "AT" METRIC PULLEYS "AT"

BAT 10
PASSO 10 mm
PER CINGHIA AT LARGHEZZA 32 mm

Materiale: Alluminio UNI 9006 - T6 (Al)
adatto per l'ossidazione dura a spessore

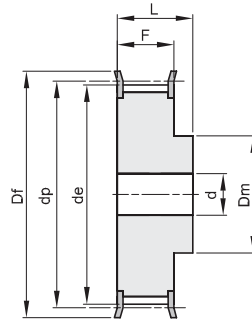

2F

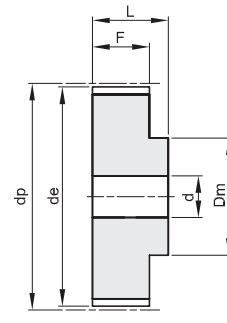

2

codice	tipo	materiale	denti	de	Df	Dm	F	L	d	n° flangia	Kg.
47 BAT 10 18	2F	Al	18	55,45	60	40	37	47	10	214	0,25
47 BAT 10 19	2F	Al	19	58,65	66	44	37	47	10	216	0,29
47 BAT 10 20	2F	Al	20	61,80	66	46	37	47	12	216	0,32
47 BAT 10 22	2F	Al	22	68,20	75	52	37	47	12	218	0,39
47 BAT 10 24	2F	Al	24	74,55	83	58	37	47	12	219	0,47
47 BAT 10 25	2F	Al	25	77,75	83	60	37	47	12	219	0,53
47 BAT 10 26	2F	Al	26	80,90	87	60	37	47	12	220	0,56
47 BAT 10 27	2F	Al	27	84,05	91	60	37	47	12	221	0,60
47 BAT 10 28	2F	Al	28	87,25	93	60	37	47	12	222	0,64
47 BAT 10 30	2F	Al	30	93,65	97	60	37	47	12	223	0,74
47 BAT 10 32	2F	Al	32	100,00	106	65	37	47	12	224	0,84
47 BAT 10 36	2F	Al	36	112,75	119	70	37	47	16	225	1,06
47 BAT 10 40	2F	Al	40	125,45	131	80	37	47	16	226	1,32
47 BAT 10 44	2	Al	44	138,20		88	37	47	16		1,61
47 BAT 10 48	2	Al	48	150,95		95	37	47	16		1,93
47 BAT 10 60	2	Al	60	189,15		110	37	47	16		3,00

Mondial Tecnica Srl
Via Arenaccia 52 - 80141 Napoli
Tel. 081.5542121 Fax. 081.281937
info@mondialtecnicaizzo.com
www.mondialtecnicaizzo.com

PULEGGE DENTATE PASSO METRICO SERIE BAT PER CINGHIE "AT"

METRIC PULLEYS "AT"

BAT 10
PASSO 10 mm
 PER CINGHIA AT LARGHEZZA 50 mm

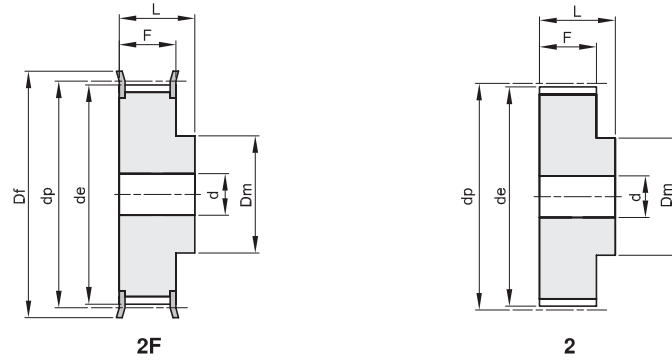

Materiale: Alluminio UNI 9006 - T6 (Al)
 adatto per l'ossidazione dura a spessore

codice	tipo	materiale	denti	de	Df	Dm	F	L	d	n° flangia	Kg.
66 BAT 10 18	2F	Al	18	55,45	60	40	56	66	10	214	0,42
66 BAT 10 19	2F	Al	19	58,65	66	44	56	66	10	216	0,47
66 BAT 10 20	2F	Al	20	61,80	66	46	56	66	12	216	0,52
66 BAT 10 22	2F	Al	22	68,20	75	52	56	66	12	218	0,57
66 BAT 10 24	2F	Al	24	74,55	83	58	56	66	12	219	0,74
66 BAT 10 25	2F	Al	25	77,75	83	60	56	66	12	219	0,77
66 BAT 10 26	2F	Al	26	80,90	87	60	56	66	12	220	0,82
66 BAT 10 27	2F	Al	27	84,05	91	60	56	66	12	221	0,95
66 BAT 10 28	2F	Al	28	87,25	93	60	56	66	12	222	0,96
66 BAT 10 30	2F	Al	30	93,65	97	60	56	66	12	223	1,17
66 BAT 10 32	2F	Al	32	100,00	106	65	56	66	12	224	1,30
66 BAT 10 36	2F	Al	36	112,75	119	70	56	66	16	225	1,64
66 BAT 10 40	2F	Al	40	125,45	131	80	56	66	16	226	2,00
66 BAT 10 44	2	Al	44	138,20		88	56	66	16		2,36
66 BAT 10 48	2	Al	48	150,95		95	56	66	16		2,83
66 BAT 10 60	2	Al	60	189,15		110	56	66	16		4,37

Mondial Tecnica Srl
 Via Arenaccia 52 - 80141 Napoli
 Tel. 081.5542121 Fax. 081.281937
 info@mondialtecnicaizzo.com
 www.mondialtecnicaizzo.com

PULEGGE DENTATE PER CINGHIE SYNCHROBELT® - “HTD”

SYNCHROBELT® “HTD” TIMING BELTS PULLEYS

3M

PASSO 3 mm

PER CINGHIE LARGHEZZA 9 mm

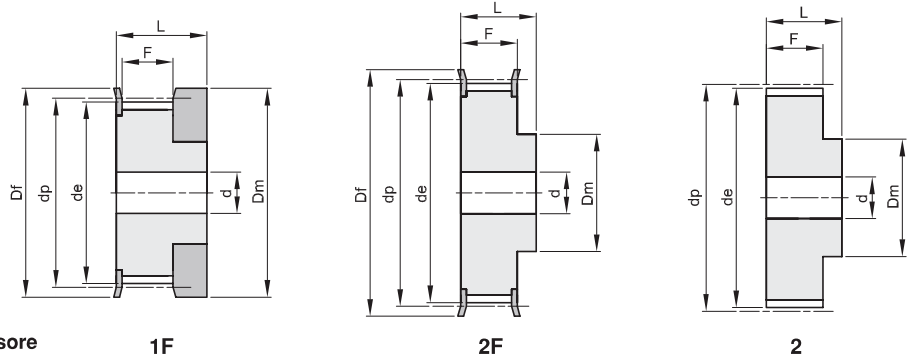

Materiale: Alluminio UNI 9006 - T6 (Al)
adatto per l'ossidazione dura a spessore

codice	tipo	materiale	denti	dp	de	Df	Dm	Di	F	L	d	n° flangia	Kg.
10 3M 09	1F	Al	10	9,55	8,79	13,0	12,0		10,2	17,5		100	0,01
12 3M 09	1F	Al	12	11,46	10,70	15,0	15,0		10,2	17,5		101	0,01
14 3M 09	1F	Al	14	13,37	12,61	16,0	16,0		10,2	17,5		102	0,01
15 3M 09	1F	Al	15	14,32	13,56	18,0	17,5		10,2	17,5		104	0,01
16 3M 09	2F	Al	16	15,28	14,52	18,0	10,0		12,8	20,6	4	104	0,01
18 3M 09	2F	Al	18	17,19	16,43	19,5	11,0		12,8	20,6	6	105	0,01
20 3M 09	2F	Al	20	19,10	18,34	23,0	13,0		12,8	20,6	6	107	0,01
21 3M 09	2F	Al	21	20,05	19,29	25,0	14,0		12,8	20,6	6	108	0,01
22 3M 09	2F	Al	22	21,01	20,25	25,0	14,0		12,8	20,6	6	108	0,01
24 3M 09	2F	Al	24	22,92	22,16	25,0	14,0		12,8	20,6	6	108	0,02
26 3M 09	2F	Al	26	24,83	24,07	28,0	16,0		12,8	20,6	6	109	0,02
28 3M 09	2F	Al	28	26,74	25,98	32,0	18,0		12,8	20,6	6	110	0,02
30 3M 09	2F	Al	30	28,65	27,89	32,0	20,0		12,8	20,6	6	110	0,03
32 3M 09	2F	Al	32	30,56	29,80	36,0	22,0		12,8	20,6	6	111	0,03
36 3M 09	2F	Al	36	34,38	33,62	38,0	26,0		13,4	22,2	6	112	0,05
40 3M 09	2F	Al	40	38,20	37,44	42,0	28,0		13,4	22,2	6	113	0,06
44 3M 09	2F	Al	44	42,02	41,26	48,0	33,0		13,4	22,2	6	114	0,07
48 3M 09	2	Al	48	45,84	45,08		33,0		13,4	22,2	8		0,11
60 3M 09	2	Al	60	57,30	56,54		33,0		13,4	22,2	8		0,11
72 3M 09	2	Al	72	68,76	68,00		33,0		13,4	22,2	8		0,15

Mondial Tecnica Srl
Via Arenaccia 52 - 80141 Napoli
Tel. 081.5542121 Fax. 081.281937
info@mondialtecnicaizzo.com
www.mondialtecnicaizzo.com

PULEGGE DENTATE PER CINGHIE SYNCHROBELT® - "HTD"

SYNCHROBELT® "HTD" TIMING BELTS PULLEYS

3M

PASSO 3 mm

PER CINGHIE LARGHEZZA 15 mm

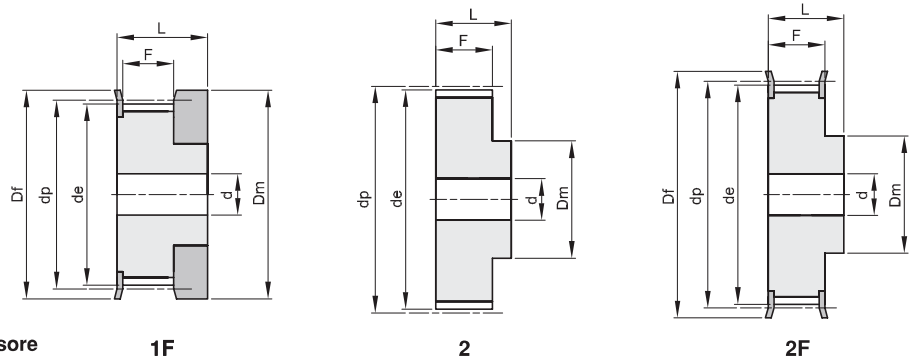

Materiale: Alluminio UNI 9006 - T6 (Al)
adatto per l'ossidazione dura a spessore

1F

2

2F

codice	tipo	materiale	denti	dp	de	Df	Dm	Di	F	L	d	n° flangia	Kg.
10 3M 15	1F	Al	10	9,55	8,79	13,0	12,0		17,0	26,0		100	0,01
12 3M 15	1F	Al	12	11,46	10,70	15,0	15,0		17,0	26,0		101	0,01
14 3M 15	1F	Al	14	13,37	12,61	16,0	16,0		17,0	26,0		102	0,01
15 3M 15	1F	Al	15	14,32	13,56	18,0	17,5		17,0	26,0		104	0,01
16 3M 15	2F	Al	16	15,28	14,52	18,0	10,0		19,5	26,0	4	104	0,01
18 3M 15	2F	Al	18	17,19	16,43	19,5	11,0		19,5	26,0	6	105	0,01
20 3M 15	2F	Al	20	19,10	18,34	23,0	13,0		19,5	26,0	6	107	0,01
21 3M 15	2F	Al	21	20,05	19,29	25,0	14,0		19,5	26,0	6	108	0,02
22 3M 15	2F	Al	22	21,01	20,25	25,0	14,0		19,5	26,0	6	108	0,02
24 3M 15	2F	Al	24	22,92	22,16	25,0	14,0		19,5	26,0	6	108	0,02
26 3M 15	2F	Al	26	24,83	24,07	28,0	16,0		19,5	26,0	6	109	0,03
28 3M 15	2F	Al	28	26,74	25,98	32,0	18,0		19,5	26,0	6	110	0,03
30 3M 15	2F	Al	30	28,65	27,89	32,0	20,0		19,5	26,0	6	110	0,04
32 3M 15	2F	Al	32	30,56	29,80	36,0	22,0		19,5	26,0	6	111	0,04
36 3M 15	2F	Al	36	34,38	33,62	38,0	26,0		20,0	30,0	6	112	0,06
40 3M 15	2F	Al	40	38,20	37,44	42,0	28,0		20,0	30,0	6	113	0,08
44 3M 15	2F	Al	44	42,02	41,26	48,0	33,0		20,0	30,0	6	114	0,10
48 3M 15	2	Al	48	45,84	45,08		33,0		20,0	30,0	8		0,10
60 3M 15	2	Al	60	57,30	56,54		33,0		20,0	30,0	8		0,15
72 3M 15	2	Al	72	68,76	68,00		33,0		20,0	30,0	8		0,21

Mondial Tecnica Srl
Via Arenaccia 52 - 80141 Napoli
Tel. 081.5542121 Fax. 081.281937
info@mondialtecnicaizzo.com
www.mondialtecnicaizzo.com

PULEGGE DENTATE PER CINGHIE SYNCHROBELT® - “HTD” SYNCHROBELT® “HTD” TIMING BELTS PULLEYS

5M

PASSO 5 mm

PER CINGHIE LARGHEZZA 9 mm

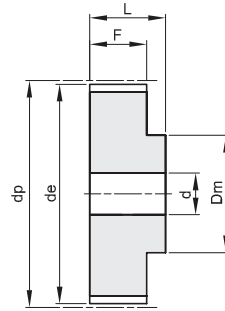

2

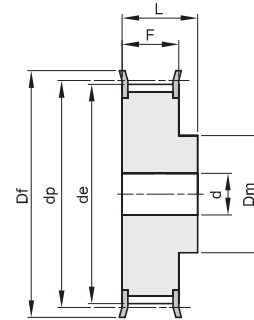

2F

Materiale: Acciaio (St)

Materiale: Alluminio UNI 9006 - T6 (Al)

adatto per l'ossidazione dura a spessore

codice	tipo	materiale	denti	dp	de	Df	Dm	Di	F	L	d	n° flangia	Kg.
12 5M 09	2F	St	12	19,10	17,96	23	12,5		14,5	20,0	6	202	0,03
14 5M 09	2F	St	14	22,28	21,14	25	13,5		14,5	20,0	6	203	0,04
15 5M 09	2F	St	15	23,87	22,73	28	16,0		14,5	20,0	6	204	0,05
16 5M 09	2F	St	16	25,46	24,32	28	16,5		14,5	20,0	6	204	0,06
18 5M 09	2F	St	18	28,65	27,51	32	20,0		14,5	20,0	6	205	0,07
20 5M 09	2F	St	20	31,83	30,69	36	23,0		14,5	22,5	6	206	0,10
21 5M 09	2F	St	21	33,42	32,28	38	24,0		14,5	22,5	6	207	0,12
22 5M 09	2F	St	22	35,01	33,87	38	25,5		14,5	22,5	6	207	0,13
24 5M 09	2F	St	24	38,20	37,06	42	27,0		14,5	22,5	6	208	0,15
26 5M 09	2F	St	26	41,38	40,24	44	30,0		14,5	22,5	6	209	0,18
28 5M 09	2F	St	28	44,56	43,42	48	30,5		14,5	22,5	6	210	0,21
30 5M 09	2F	St	30	47,75	46,60	51	35,0		14,5	22,5	6	211	0,25
32 5M 09	2F	St	32	50,93	49,79	54	38,0		14,5	22,5	8	212	0,28
36 5M 09	2F	St	36	57,30	56,16	60	38,0		14,5	22,5	8	214	0,33
40 5M 09	2F	St	40	63,66	62,52	71	38,0		14,5	22,5	8	217	0,42
44 5M 09	2	Al	44	70,03	68,89		38,0		14,5	25,5	8		0,17
48 5M 09	2	Al	48	76,39	75,25		45,0		14,5	25,5	8		0,18
60 5M 09	2	Al	60	95,49	94,35		45,0		14,5	25,5	8		0,23
72 5M 09	2	Al	72	114,59	113,45		45,0		14,5	25,5	8		0,42

Mondial Tecnica Srl

Via Arenaccia 52 - 80141 Napoli

Tel. 081.5542121 Fax. 081.281937

info@mondialtecnicaizzo.com

www.mondialtecnicaizzo.com

PULEGGE DENTATE PER CINGHIE SYNCHROBELT® - "HTD" SYNCHROBELT® "HTD" TIMING BELTS PULLEYS

5M

PASSO 5 mm

PER CINGHIE LARGHEZZA 15 mm

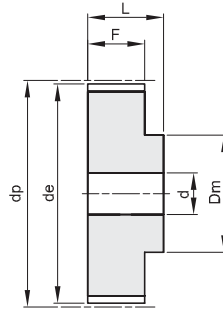

2

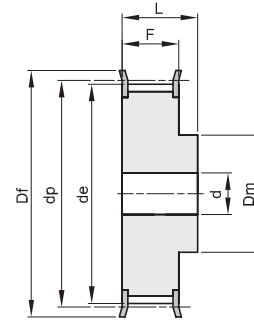

2F

Materiale: Acciaio (St)

Materiale: Alluminio UNI 9006 - T6 (Al)

adatto per l'ossidazione dura a spessore

codice	tipo	materiale	denti	dp	de	Df	Dm	Di	F	L	d	n° flangia	Kg.
12 5M 15	2F	St	12	19,10	17,96	23	12,5		20,5	26	6	202	0,03
14 5M 15	2F	St	14	22,28	21,14	25	13,5		20,5	26	6	203	0,04
15 5M 15	2F	St	15	23,87	22,73	28	16,0		20,5	26	6	204	0,05
16 5M 15	2F	St	16	25,46	24,32	28	16,5		20,5	26	6	204	0,06
18 5M 15	2F	St	18	28,65	27,51	32	20,0		20,5	26	6	205	0,09
20 5M 15	2F	St	20	31,83	30,69	36	23,0		20,5	26	6	206	0,12
21 5M 15	2F	St	21	33,42	32,28	38	24,0		20,5	26	6	207	0,14
22 5M 15	2F	St	22	35,01	33,87	38	25,5		20,5	26	6	207	0,15
24 5M 15	2F	St	24	38,20	37,06	42	27,0		20,5	28	6	208	0,19
26 5M 15	2F	St	26	41,38	40,24	44	30,0		20,5	28	6	209	0,23
28 5M 15	2F	St	28	44,56	43,42	48	30,5		20,5	28	6	210	0,26
30 5M 15	2F	St	30	47,75	46,60	51	35,0		20,5	28	6	211	0,32
32 5M 15	2F	St	32	50,93	49,79	54	38,0		20,5	28	8	212	0,35
36 5M 15	2F	St	36	57,30	56,16	60	38,0		20,5	28	8	214	0,43
40 5M 15	2F	St	40	63,66	62,52	71	38,0		20,5	28	8	217	0,52
44 5M 15	2	Al	44	70,03	68,89		38,0		20,5	30	8		0,23
48 5M 15	2	Al	48	76,39	75,25		38,0		20,5	30	8		0,29
60 5M 15	2	Al	60	95,49	94,35		50,0		20,5	30	8		0,30
72 5M 15	2	Al	72	114,59	113,45		50,0		20,5	30	8		0,59

Mondial Tecnica Srl

Via Arenaccia 52 - 80141 Napoli

Tel. 081.5542121 Fax. 081.281937

info@mondialtecnicaizzo.com

www.mondialtecnicaizzo.com

PULEGGE DENTATE PER CINGHIE SYNCHROBELT® - “HTD” SYNCHROBELT® “HTD” TIMING BELTS PULLEYS

5M

PASSO 5 mm

PER CINGHIE LARGHEZZA 25 mm

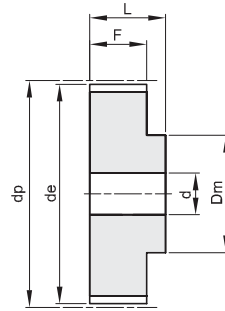

2

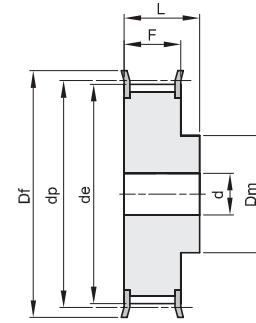

2F

Materiale: Acciaio (St)

Materiale: Alluminio UNI 9006 - T6 (Al)

adatto per l'ossidazione dura a spessore

codice	tipo	materiale	denti	dp	de	Df	Dm	Di	F	L	d	n° flangia	Kg.
12 5M 25	2F	St	12	19,10	17,96	23	12,5		30,5	36	6	202	0,05
14 5M 25	2F	St	14	22,28	21,14	25	13,5		30,5	36	6	203	0,08
15 5M 25	2F	St	15	23,87	22,73	28	16,0		30,5	36	6	204	0,09
16 5M 25	2F	St	16	25,46	24,32	28	16,5		30,5	36	6	204	0,11
18 5M 25	2F	St	18	28,65	27,51	32	20,0		30,5	36	6	205	0,13
20 5M 25	2F	St	20	31,83	30,69	36	23,0		30,5	36	6	206	0,17
21 5M 25	2F	St	21	33,42	32,28	38	24,0		30,5	38	6	207	0,20
22 5M 25	2F	St	22	35,01	33,87	38	25,5		30,5	38	6	207	0,22
24 5M 25	2F	St	24	38,20	37,06	42	27,0		30,5	38	6	208	0,26
26 5M 25	2F	St	26	41,38	40,24	44	30,0		30,5	38	6	209	0,32
28 5M 25	2F	St	28	44,56	43,42	48	30,5		30,5	38	6	210	0,37
30 5M 25	2F	St	30	47,75	46,60	51	35,0		30,5	38	6	211	0,44
32 5M 25	2F	St	32	50,93	49,79	54	38,0		30,5	38	8	212	0,48
36 5M 25	2F	St	36	57,30	56,16	60	38,0		30,5	38	8	214	0,59
40 5M 25	2F	St	40	63,66	62,52	71	38,0		30,5	38	8	217	0,75
44 5M 25	2	Al	44	70,03	68,89		38,0		30,5	40	8		0,32
48 5M 25	2	Al	48	76,39	75,25		38,0		30,5	40	8		0,28
60 5M 25	2	Al	60	95,49	94,35		50,0		30,5	40	8		0,44
72 5M 25	2	Al	72	114,59	113,45		50,0		30,5	40	8		0,85

Mondial Tecnica Srl

Via Arenaccia 52 - 80141 Napoli

Tel. 081.5542121 Fax. 081.281937

info@mondialtecnicaizzo.com

www.mondialtecnicaizzo.com

PULEGGE DENTATE PER CINGHIE SYNCHROBELT® - “HTD”

SYNCHROBELT® “HTD” TIMING BELTS PULLEYS

8M

PASSO 8 mm

PER CINGHIE LARGHEZZA 20 mm

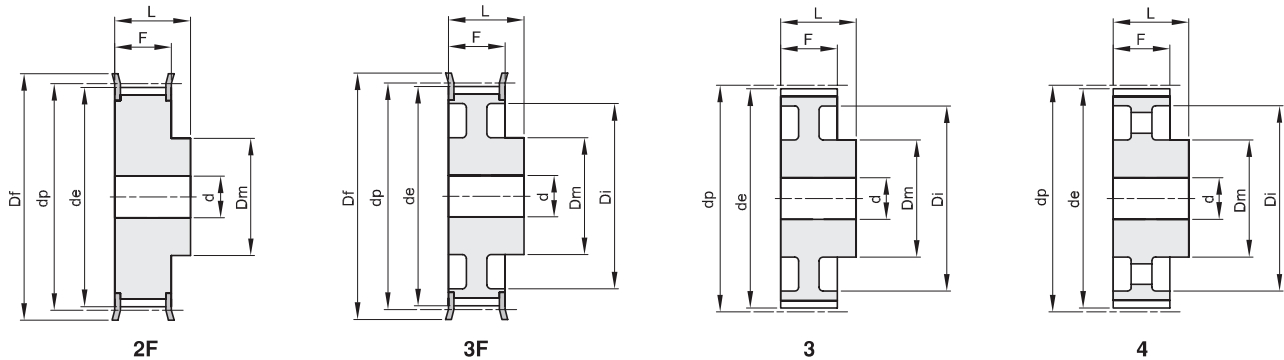

Materiale: Acciaio (St)
Materiale: Ghisa (GG)

codice	tipo	materiale	denti	dp	de	Df	Dm	Di	F	L	d	n° flangia	Kg.
22 8M 20	2F	St	22	56,02	54,65	60	43		28	38	12	308	0,54
24 8M 20	2F	St	24	61,11	59,74	66	45		28	38	12	310	0,65
26 8M 20	2F	St	26	66,21	64,84	71	48		28	38	12	311	0,80
28 8M 20	2F	St	28	71,30	70,08	75	50		28	38	14	312	0,88
30 8M 20	2F	St	30	76,39	75,13	83	55		28	38	14	314	1,00
32 8M 20	2F	St	32	81,49	80,16	87	60		28	38	14	315	1,20
34 8M 20	2F	St	34	86,58	85,21	91	66		28	38	14	316	1,40
36 8M 20	2F	St	36	91,67	90,30	98	70		28	38	14	319	1,60
38 8M 20	2F	St	38	96,77	95,39	103	75		28	38	14	320	1,70
40 8M 20	2F	St	40	101,86	100,49	106	75		28	38	14	321	1,85
44 8M 20	2F	St	44	112,05	110,67	119	75		28	38	14	325	2,10
48 8M 20	2F	St	48	122,23	120,86	127	75		28	38	14	327	2,50
56 8M 20	3F	St	56	142,60	141,23	148	80	116	28	38	14	333	2,82
64 8M 20	3F	St	64	162,97	161,60	168	80	137	28	38	14	338	3,22
72 8M 20	3F	St	72	183,35	181,97	192	80	158	28	38	14	340	3,74
80 8M 20	3	GG	80	203,72	202,35		90	180	28	38	14		3,78
90 8M 20	3	GG	90	229,18	227,81		90	204	28	38	14		4,57
* 112 8M 20	4	GG	112	285,21	283,83		90	254	28	38	18		
* 144 8M 20	4	GG	144	366,69	365,32		90	336	28	38	20		
* 168 8M 20	4	GG	168	427,81	426,44		100	400	28	38	20		
* 192 8M 20	4	GG	192	488,92	487,55		100	460	28	38	20		

Mondial Tecnica Srl
Via Arenaccia 52 - 80141 Napoli
Tel. 081.5542121 Fax. 081.281937
info@mondialtecnicaizzo.com
www.mondialtecnicaizzo.com

* Costruite a richiesta - Manufactured on request.

PULEGGE DENTATE PER CINGHIE SYNCHROBELT® - “HTD”

SYNCHROBELT® “HTD” TIMING BELTS PULLEYS

8M

PASSO 8 mm

PER CINGHIE LARGHEZZA 30 mm

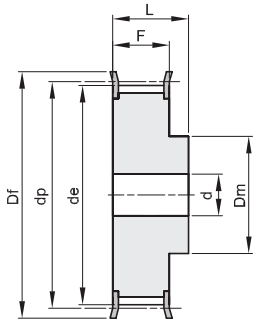

2F

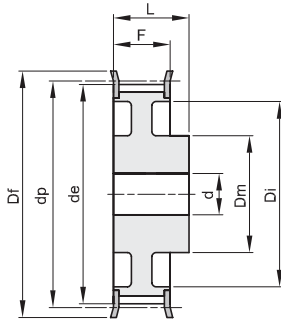

3F

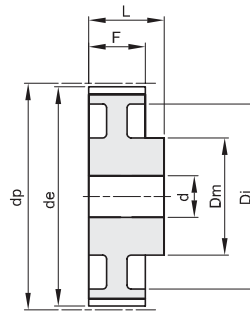

3

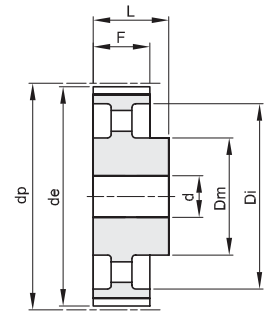

4

Materiale: Acciaio (St)
Materiale: Ghisa (GG)

codice	tipo	materiale	denti	dp	de	Df	Dm	Di	F	L	d	n° flangia	Kg.
22 8M 30	2F	St	22	56,02	54,65	60	43		38	48	12	308	0,75
24 8M 30	2F	St	24	61,11	59,74	66	45		38	48	12	310	0,90
26 8M 30	2F	St	26	66,21	64,84	71	48		38	48	12	311	1,10
28 8M 30	2F	St	28	71,30	70,08	75	50		38	48	14	312	1,20
30 8M 30	2F	St	30	76,39	75,13	83	55		38	48	14	314	1,32
32 8M 30	2F	St	32	81,49	80,16	87	60		38	48	14	315	1,55
34 8M 30	2F	St	34	86,58	85,21	91	66		38	48	14	316	1,80
36 8M 30	2F	St	36	91,67	90,30	98	70		38	48	14	319	2,10
38 8M 30	2F	St	38	96,77	95,39	103	75		38	48	14	320	2,30
40 8M 30	2F	St	40	101,86	100,49	106	75		38	48	14	321	2,47
44 8M 30	2F	St	44	112,05	110,67	119	75		38	48	14	325	2,95
48 8M 30	2F	St	48	122,23	120,86	127	75		38	48	14	327	3,30
56 8M 30	3F	St	56	142,60	141,23	148	90	116	38	48	14	333	4,02
64 8M 30	3F	St	64	162,97	161,60	168	90	137	38	48	14	338	4,60
72 8M 30	3F	St	72	183,35	181,97	192	95	158	38	48	14	340	5,41
80 8M 30	3	GG	80	203,72	202,35		100	180	38	48	14		5,23
90 8M 30	3	GG	90	229,18	227,81		100	204	38	48	14		6,42
112 8M 30	4	GG	112	285,21	283,83		100	254	38	48	18		8,12
144 8M 30	4	GG	144	366,69	365,32		100	336	38	48	20		10,36
168 8M 30	4	GG	168	427,81	426,44		100	400	38	48	20		12,37
192 8M 30	4	GG	192	488,92	487,55		100	460	38	48	20		14,31

Mondial Tecnica Srl

Via Arenaccia 52 - 80141 Napoli

Tel. 081.5542121 Fax. 081.281937

info@mondialtecnicaizzo.com

www.mondialtecnicaizzo.com

PULEGGE DENTATE PER CINGHIE SYNCHROBELT® - "HTD" SYNCHROBELT® "HTD" TIMING BELTS PULLEYS

8M

PASSO 8 mm

PER CINGHIE LARGHEZZA 50 mm

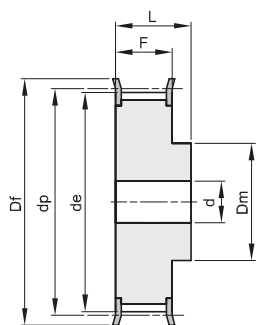

2F

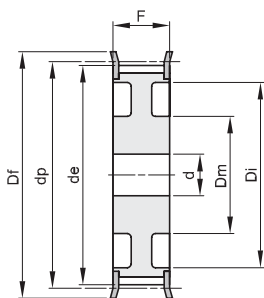

7F

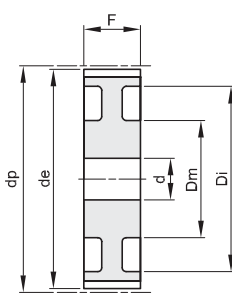

7

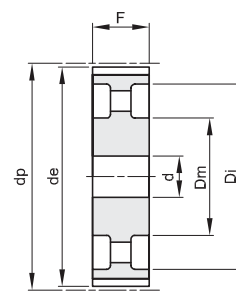

8

Materiale: Acciaio (St)

Materiale: Ghisa (GG)

codice	tipo	materiale	denti	dp	de	Df	Dm	Di	F	L	d	n° flangia	Kg.
22 8M 50	2F	St	22	56,02	54,65	60	43		60	70	12	308	1,10
24 8M 50	2F	St	24	61,11	59,74	66	45		60	70	12	310	1,30
26 8M 50	2F	St	26	66,21	64,84	71	48		60	70	12	311	1,60
28 8M 50	2F	St	28	71,30	70,08	75	50		60	70	14	312	1,70
30 8M 50	2F	St	30	76,39	75,13	83	55		60	70	14	314	2,00
32 8M 50	2F	St	32	81,49	80,16	87	60		60	70	14	315	2,35
34 8M 50	2F	St	34	86,58	85,21	91	66		60	70	14	316	2,80
36 8M 50	2F	St	36	91,67	90,30	98	70		60	70	14	319	3,10
38 8M 50	2F	St	38	96,77	95,39	103	75		60	70	14	320	3,30
40 8M 50	2F	St	40	101,86	100,49	106	75		60	70	14	321	3,60
44 8M 50	2F	St	44	112,05	110,67	119	75		60	70	14	325	4,40
48 8M 50	2F	St	48	122,23	120,86	127	75		60	70	14	327	5,00
56 8M 50	7F	St	56	142,60	141,23	148	90	116	60	60	18	333	5,68
64 8M 50	7F	St	64	162,97	161,60	168	100	137	60	60	18	338	6,93
72 8M 50	7F	St	72	183,35	181,97	192	100	158	60	60	18	340	7,95
80 8M 50	7	GG	80	203,72	202,35		110	180	60	60	18		7,96
90 8M 50	7	GG	90	229,18	227,81		110	204	60	60	18		9,20
112 8M 50	8	GG	112	285,21	283,83		110	254	60	60	18		12,16
144 8M 50	8	GG	144	366,69	365,32		110	336	60	60	20		15,68
168 8M 50	8	GG	168	427,81	426,44		120	400	60	60	20		18,99
192 8M 50	8	GG	192	488,92	487,55		130	460	60	60	20		24,09

Mondial Tecnica Srl

Via Arenaccia 52 - 80141 Napoli

Tel. 081.5542121 Fax. 081.281937

info@mondialtecnicaizzo.com

www.mondialtecnicaizzo.com

PULEGGE DENTATE PER CINGHIE SYNCHROBELT® - “HTD”

SYNCHROBELT® “HTD” TIMING BELTS PULLEYS

8M

PASSO 8 mm

PER CINGHIE LARGHEZZA 85 mm

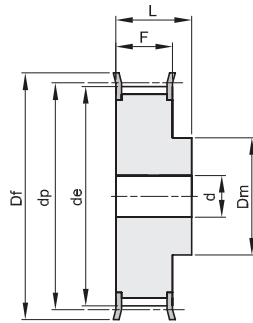

2F

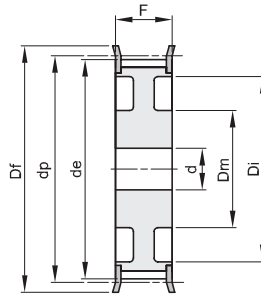

7F

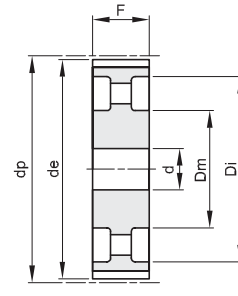

8

Materiale: Acciaio (St)
Materiale: Ghisa (GG)

codice	tipo	materiale	denti	dp	de	Df	Dm	Di	F	L	d	n° flangia	Kg.
22 8M 85	2F	St	22	56,02	54,65	60	43		95	105	12	308	1,60
24 8M 85	2F	St	24	61,11	59,74	66	45		95	105	12	310	1,95
26 8M 85	2F	St	26	66,21	64,84	71	48		95	105	12	311	2,30
28 8M 85	2F	St	28	71,30	70,08	75	50		95	105	14	312	2,60
30 8M 85	2F	St	30	76,39	75,13	83	55		95	105	14	314	3,10
32 8M 85	2F	St	32	81,49	80,16	87	60		95	105	14	315	3,70
34 8M 85	2F	St	34	86,58	85,21	91	66		95	105	14	316	4,00
36 8M 85	2F	St	36	91,67	90,30	98	70		95	105	14	319	4,70
38 8M 85	2F	St	38	96,77	95,39	103	75		95	105	14	320	5,10
40 8M 85	2F	St	40	101,86	100,49	106	75		95	105	14	321	5,40
44 8M 85	2F	St	44	112,05	110,67	119	75		95	105	14	325	6,70
48 8M 85	2F	St	48	122,23	120,86	127	75		95	105	14	327	7,20
56 8M 85	2F	St	56	142,60	141,23	148	80		95	105	18	333	11,48
64 8M 85	7F	St	64	162,97	161,60	168	100	137	95	95	18	338	11,02
72 8M 85	7F	St	72	183,35	181,97	192	110	158	95	95	18	340	13,45
80 8M 85	8	GG	80	203,72	202,35		110	180	95	95	20		12,36
90 8M 85	8	GG	90	229,18	227,81		110	204	95	95	20		14,38
112 8M 85	8	GG	112	285,21	283,83		110	254	95	95	24		18,66
144 8M 85	8	GG	144	366,69	365,32		110	341	95	95	24		23,00
* 168 8M 85	8	GG	168	427,81	426,44		120	400	95	95	24		
* 192 8M 85	8	GG	192	488,92	487,55		130	460	95	95	24		

Mondial Tecnica Srl

Via Arenaccia 52 - 80141 Napoli

Tel. 081.5542121 Fax. 081.281937

info@mondialtecnicaizzo.com

www.mondialtecnicaizzo.com

* Costruite a richiesta - Manufactured on request.

PULEGGE DENTATE PER CINGHIE SYNCHROBELT® - "HTD" SYNCHROBELT® "HTD" TIMING BELTS PULLEYS

14M

PASSO 14 mm

PER CINGHIE LARGHEZZA 40 mm

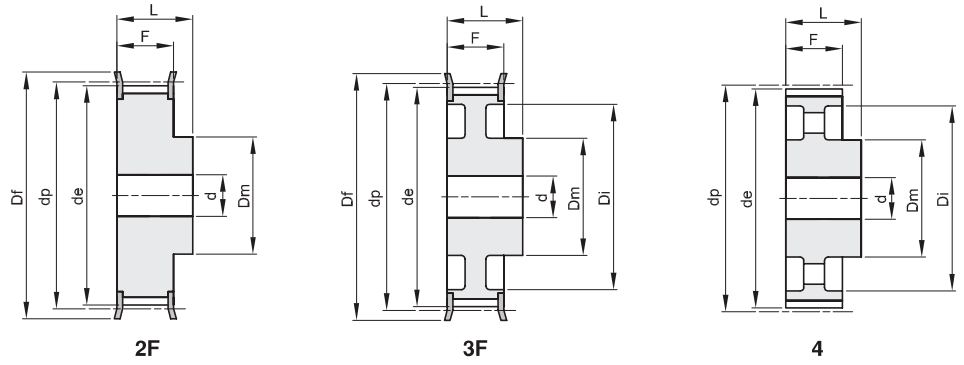

Materiale: Acciaio (St)
Materiale: Ghisa (GG)

codice	tipo	materiale	denti	dp	de	Df	Dm	Di	F	L	d	n° flangia	Kg.
28 14M 40	2F	St	28	124,78	122,12	127	100		54	69	24	400	4,80
30 14M 40	2F	St	30	133,69	130,99	138	100		54	69	24	401	5,60
32 14M 40	2F	St	32	142,60	139,88	154	100		54	69	24	403	6,20
34 14M 40	2F	St	34	151,52	148,79	160	100		54	69	24	404	6,90
36 14M 40	2F	St	36	160,43	157,68	168	100		54	69	24	405	7,70
38 14M 40	2F	St	38	169,34	166,60	183	120		54	69	24	406	8,90
40 14M 40	2F	St	40	178,25	175,49	188	120		54	69	24	407	9,80
44 14M 40	2F	St	44	196,08	193,28	211	120		54	69	24	411	12,00
48 14M 40	3F	GG	48	213,90	211,11	226	135	170	54	69	24	412	11,98
56 14M 40	3F	GG	56	249,55	246,76	256	135	207	54	69	28	416	14,01
64 14M 40	3F	GG	64	285,21	282,41	296	135	240	54	69	28	418	16,65
72 14M 40	4	GG	72	320,86	318,06		135	278	54	69	28		15,52
80 14M 40	4	GG	80	356,51	353,71		135	314	54	69	28		17,23
90 14M 40	4	GG	90	401,07	398,28		135	358	54	69	28		19,40
112 14M 40	4	GG	112	499,11	496,32		135	456	54	69	28		24,14
* 144 14M 40	4	GG	144	641,71	638,92		135	600	54	69	28		
* 168 14M 40	4	GG	168	748,66	745,87		135	706	54	69	28		
* 192 14M 40	4	GG	192	855,62	852,82		135	813	54	69	28		

PULEGGE DENTATE PER CINGHIE SYNCHROBELT® - “HTD”

SYNCHROBELT® “HTD” TIMING BELTS PULLEYS

14M
PASSO 14 mm
 PER CINGHIE LARGHEZZA 55 mm

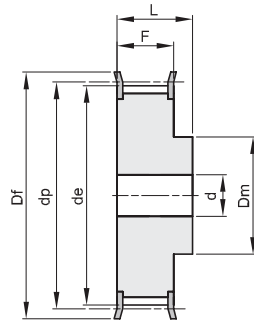

2F

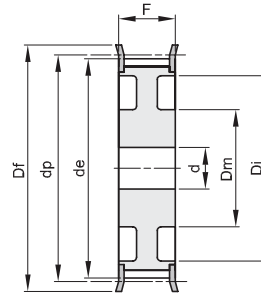

7F

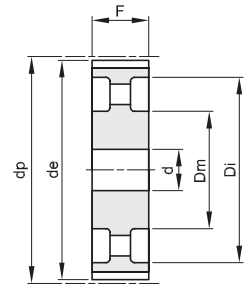

8

Materiale: Acciaio (St)
 Materiale: Ghisa (GG)

codice	tipo	materiale	denti	dp	de	Df	Dm	Di	F	L	d	n° flangia	Kg.
28 14M 55	2F	St	28	124,78	122,12	127	100		70	85	24	400	5,70
30 14M 55	2F	St	30	133,69	130,99	138	100		70	85	24	401	7,10
32 14M 55	2F	St	32	142,60	139,88	154	100		70	85	24	403	7,90
34 14M 55	2F	St	34	151,52	148,79	160	100		70	85	24	404	9,33
36 14M 55	2F	St	36	160,43	157,68	168	100		70	85	24	405	10,49
38 14M 55	2F	St	38	169,34	166,60	183	120		70	85	24	406	12,11
40 14M 55	2F	St	40	178,25	175,49	188	120		70	85	24	407	13,30
44 14M 55	2F	St	44	196,08	193,28	211	120		70	85	24	411	16,12
48 14M 55	7F	GG	48	213,90	211,11	226	135	170	70	70	24	412	13,50
56 14M 55	7F	GG	56	249,55	246,76	256	135	207	70	70	28	416	15,78
64 14M 55	7F	GG	64	285,21	282,41	296	135	240	70	70	28	418	19,04
72 14M 55	8	GG	72	320,86	318,06		135	278	70	70	28		18,41
80 14M 55	8	GG	80	356,51	353,71		135	314	70	70	28		20,27
90 14M 55	8	GG	90	401,07	398,28		135	358	70	70	28		22,98
112 14M 55	8	GG	112	499,11	496,32		135	456	70	70	28		29,29
144 14M 55	8	GG	144	641,71	638,92		135	600	70	70	28		36,00
168 14M 55	8	GG	168	748,66	745,87		135	706	70	70	28		40,00
192 14M 55	8	GG	192	855,62	852,82		135	813	70	70	28		47,50

PULEGGE DENTATE PER CINGHIE SYNCHROBELT® - "HTD" SYNCHROBELT® "HTD" TIMING BELTS PULLEYS

14M

PASSO 14 mm

PER CINGHIE LARGHEZZA 85 mm

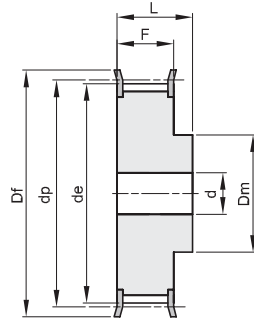

2F

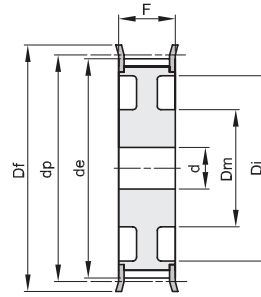

7F

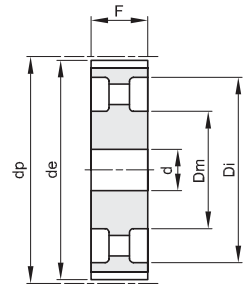

8

Materiale: Acciaio (St)
Materiale: Ghisa (GG)

codice	tipo	materiale	denti	dp	de	Df	Dm	Di	F	L	d	n° flangia	Kg.
28 14M 85	2F	St	28	124,78	122,12	127	100		102	117	24	400	8,77
30 14M 85	2F	St	30	133,69	130,99	138	100		102	117	24	401	10,13
32 14M 85	2F	St	32	142,60	139,88	154	100		102	117	24	403	11,65
34 14M 85	2F	St	34	151,52	148,79	160	100		102	117	24	404	13,15
36 14M 85	2F	St	36	160,43	157,68	168	100		102	117	32	405	14,48
38 14M 85	2F	St	38	169,34	166,60	183	120		102	117	32	406	16,62
40 14M 85	2F	St	40	178,25	175,49	188	135		102	117	32	407	18,84
44 14M 85	2F	St	44	196,08	193,28	211	135		102	117	32	411	22,86
48 14M 85	2F	St	48	213,90	211,11	226	150		102	117	32	412	27,58
56 14M 85	7F	GG	56	249,55	246,76	256	150	207	102	102	32	416	24,19
64 14M 85	7F	GG	64	285,21	282,41	296	150	240	102	102	32	418	28,57
72 14M 85	8	GG	72	320,86	318,06		150	278	102	102	32		28,26
80 14M 85	8	GG	80	356,51	353,71		150	314	102	102	32		31,00
90 14M 85	8	GG	90	401,07	398,28		150	358	102	102	32		35,00
112 14M 85	8	GG	112	499,11	496,32		150	456	102	102	32		43,50
144 14M 85	8	GG	144	641,71	638,92		150	600	102	102	32		50,00
168 14M 85	8	GG	168	748,66	745,87		150	706	102	102	32		63,00
192 14M 85	8	GG	192	855,62	852,82		165	813	102	102	32		76,00

PULEGGE DENTATE PER CINGHIE SYNCHROBELT® - “HTD”

SYNCHROBELT® “HTD” TIMING BELTS PULLEYS

14M
PASSO 14 mm
 PER CINGHIE LARGHEZZA 115 mm

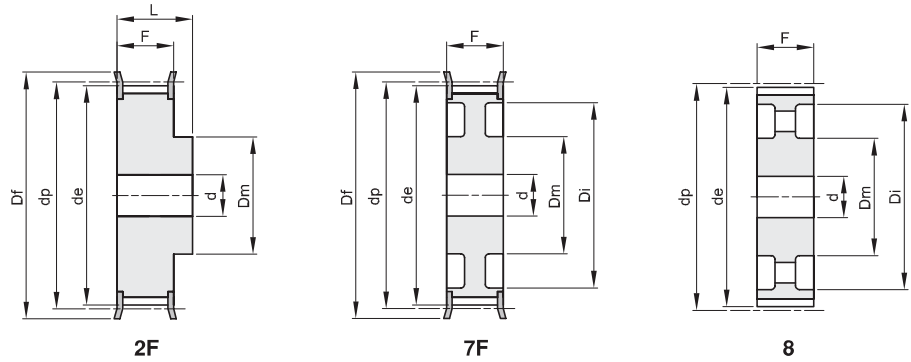

Materiale: Acciaio (St)
 Materiale: Ghisa (GG)

codice	tipo	materiale	denti	dp	de	Df	Dm	Di	F	L	d	n° flangia	Kg.
28 14M 115	2F	St	28	124,78	122,12	127	100		133	148	32	400	10,75
30 14M 115	2F	St	30	133,69	130,99	138	100		133	148	32	401	12,52
32 14M 115	2F	St	32	142,60	139,88	154	100		133	148	32	403	14,48
34 14M 115	2F	St	34	151,52	148,79	160	100		133	148	32	404	16,45
36 14M 115	2F	St	36	160,43	157,68	168	120		133	148	32	405	18,99
38 14M 115	2F	St	38	169,34	166,60	183	120		133	148	32	406	21,31
40 14M 115	2F	St	40	178,25	175,49	188	135		133	148	32	407	24,04
44 14M 115	2F	St	44	196,08	193,28	211	140		133	148	32	411	29,41
48 14M 115	2F	St	48	213,90	211,11	226	150		133	148	32	412	35,00
56 14M 115	2F	St	56	249,55	246,76	256	150		133	148	32	416	48,00
64 14M 115	7F	GG	64	285,21	282,41	296	150	240	133	133	32	418	36,00
72 14M 115	8	GG	72	320,86	318,06		150	278	133	133	32		36,00
80 14M 115	8	GG	80	356,51	353,71		150	314	133	133	32		40,00
90 14M 115	8	GG	90	401,07	398,28		150	358	133	133	32		45,00
112 14M 115	8	GG	112	499,11	496,32		150	456	133	133	32		55,50
144 14M 115	8	GG	144	641,71	638,92		165	600	133	133	32		71,00
168 14M 115	8	GG	168	748,66	745,87		165	706	133	133	32		83,00
192 14M 115	8	GG	192	855,62	852,82		165	813	133	133	32		96,00

PULEGGE DENTATE PER CINGHIE SYNCHROBELT® - "HTD"

SYNCHROBELT® "HTD" TIMING BELTS PULLEYS

14M
PASSO 14 mm
 PER CINGHIE LARGHEZZA 170 mm

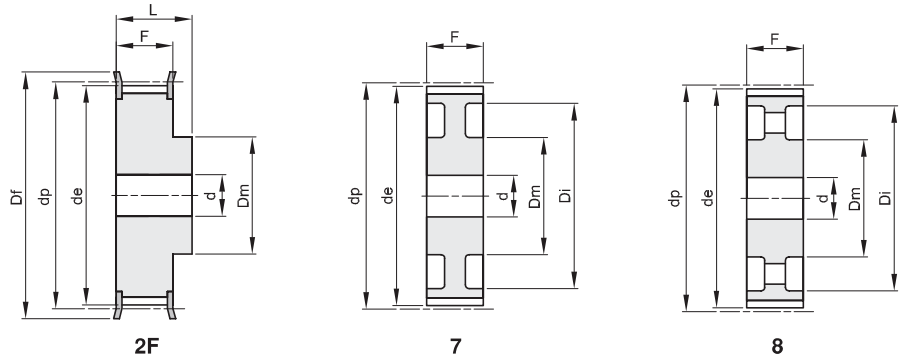

Materiale: Acciaio (St)
 Materiale: Ghisa (GG)

codice	tipo	materiale	denti	dp	de	Df	Dm	Di	F	L	d	n° flangia	Kg.
28 14M 170	2F	St	28	124,78	122,12	127	100		187	202	32	400	14,79
30 14M 170	2F	St	30	133,69	130,99	138	100		187	202	32	401	17,24
32 14M 170	2F	St	32	142,60	139,88	154	100		187	202	32	403	19,92
34 14M 170	2F	St	34	151,52	148,79	160	100		187	202	32	404	22,72
36 14M 170	2F	St	36	160,43	157,68	168	120		187	202	32	405	26,07
38 14M 170	2F	St	38	169,34	166,60	183	135		187	202	32	406	29,71
40 14M 170	2F	St	40	178,25	175,49	188	140		187	202	32	407	33,50
*44 14M 170	2F	St	44	196,08	193,28	211	160		187	202	32	411	
*48 14M 170	2F	St	48	213,90	211,11	226	160		187	202	32	412	
*56 14M 170	2F	St	56	249,55	246,76	256	160		187	202	32	416	
*64 14M 170	2F	St	64	285,21	282,41	296	180		187	202	32	418	
*72 14M 170	7	GG	72	320,86	318,06		180	278	187	187	32		
80 14M 170	7	GG	80	356,51	353,71		180	314	187	187	32		71,00
90 14M 170	8	GG	90	401,07	398,28		180	358	187	187	38		73,00
112 14M 170	8	GG	112	499,11	496,32		200	456	187	187	38		95,00
144 14M 170	8	GG	144	641,71	638,92		220	600	187	187	38		114,00
168 14M 170	8	GG	168	748,66	745,87		220	706	187	187	38		142,00
*192 14M 170	8	GG	192	855,62	852,82		220	813	187	187	38		

PULEGGE DENTATE A BUSSOLA CONICA PER CINGHIE SYNCHROBELT® - "HTD" SYNCHROBELT® "HTD" TIMING BELTS PULLEYS FOR TAPER BUSHES

5M

PASSO 5 mm

PER CINGHIE LARGHEZZA 15 mm

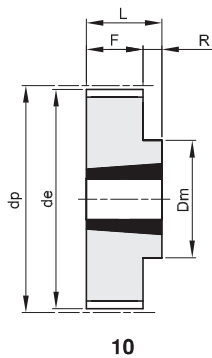

10

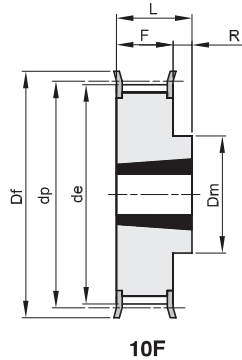

10F

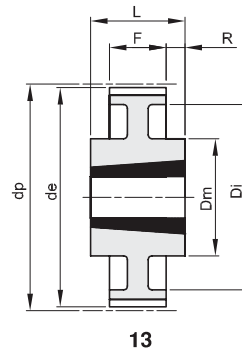

13

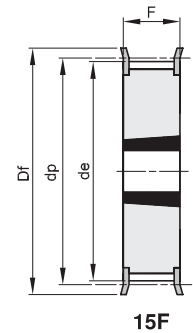

15F

Materiale: Acciaio (St)

codice	tipo	materiale	denti	bussola	foro max	dp	de	Df	Dm	Di	F	L	R	n° flangia	Kg.
TL 34 5M 15	15F	St	34	1008	25	54,11	52,97	57			22	22		213	0,20
TL 36 5M 15	15F	St	36	1108	25	57,30	56,15	60			22	22		214	0,25
TL 38 5M 15	15F	St	38	1108	25	60,48	59,34	66			22	22		216	0,30
TL 40 5M 15	15F	St	40	1108	25	63,66	62,52	71			22	22		217	0,35
TL 44 5M 15	15F	St	44	1108	25	70,03	68,89	75			22	22		218	0,40
TL 48 5M 15	10F	St	48	1210	32	76,39	75,25	83	59		22	25	3	219	0,46
TL 56 5M 15	10F	St	56	1210	32	89,13	87,99	93	70		22	25	3	222	0,60
TL 64 5M 15	10F	St	64	1210	32	101,86	100,72	106	80		22	25	3	224	0,80
TL 72 5M 15	10	St	72	1610	42	114,59	113,45		92		22	25	3		1,20
TL 80 5M 15	10	St	80	1610	42	127,32	126,18		92		22	25	3		1,76
TL 90 5M 15	10	St	90	1610	42	143,24	142,10		92		22	25	3		2,32
TL112 5M 15	10	St	112	2012	50	178,25	177,11		110		20	32	12		3,72
TL136 5M 15	13	St	136	2012	50	216,45	215,31		110	199	20	32	6		3,82

PULEGGE DENTATE A BUSSOLA CONICA PER CINGHIE SYNCHROBELT® - "HTD" SYNCHROBELT® "HTD" TIMING BELTS PULLEYS FOR TAPER BUSHES

8M

PASSO 8 mm

PER CINGHIE LARGHEZZA 20 mm

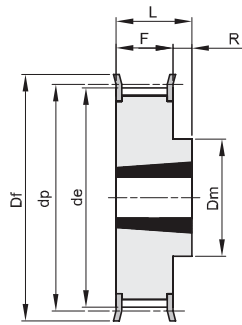

10F

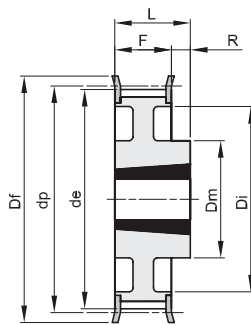

11F

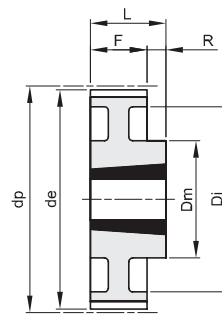

11

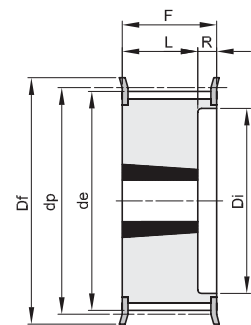

16F

Materiale: Acciaio (St)

Materiale: Ghisa (GG)

codice	tipo	materiale	denti	bussola	foro max	dp	de	Df	Dm	Di	F	L	R	n° flangia	Kg.
TL 22 8M 20	16F	St	22	1008	25	56,02	54,65	60		37	28	22	6	308	0,25
TL 24 8M 20	16F	St	24	1108	25	61,11	59,74	66		44	28	22	6	310	0,30
TL 26 8M 20	16F	St	26	1108	25	66,21	64,84	71		45	28	22	6	311	0,36
TL 28 8M 20	16F	St	28	1108	25	71,30	70,08	75		50	28	22	6	312	0,45
TL 30 8M 20	16F	St	30	1108	25	76,39	75,13	83		58	28	22	6	314	0,55
TL 32 8M 20	16F	St	32	1610	42	81,49	80,16	87		63	28	25	3	315	0,43
TL 34 8M 20	16F	St	34	1610	42	86,58	85,21	91		64	28	25	3	316	0,57
TL 36 8M 20	16F	St	36	1610	42	91,67	90,30	98		68	28	25	3	319	0,70
TL 38 8M 20	16F	St	38	1610	42	96,77	95,39	103		72	28	25	3	320	0,82
TL 40 8M 20	16F	St	40	1610	42	101,86	100,49	106		76	28	25	3	321	1,10
TL 44 8M 20	10F	St	44	2012	50	112,05	110,67	119	92		28	32	4	325	1,20
TL 48 8M 20	10F	St	48	2012	50	122,23	120,86	127	96		28	32	4	327	1,65
TL 56 8M 20	10F	St	56	2012	50	142,60	141,23	148	110		28	32	4	333	2,50
TL 64 8M 20	11F	St	64	2012	50	162,97	161,60	168	110	137	28	32	4	338	2,60
TL 72 8M 20	11F	St	72	2012	50	183,35	181,97	192	110	158	28	32	4	340	3,40
TL 80 8M 20	11	GG	80	2012	50	203,72	202,35		110	180	28	32	4		3,60
TL 90 8M 20	11	GG	90	2012	50	229,18	227,81		110	204	28	32	4		4,10

PULEGGE DENTATE A BUSSOLA CONICA PER CINGHIE SYNCHROBELT® - "HTD" SYNCHROBELT® "HTD" TIMING BELTS PULLEYS FOR TAPER BUSHES

8M
PASSO 8 mm
PER CINGHIE LARGHEZZA 30 mm

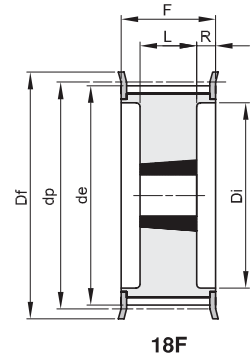
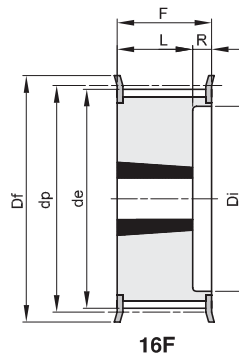
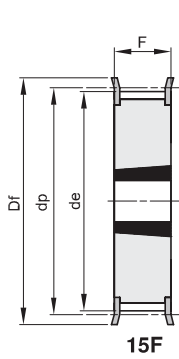
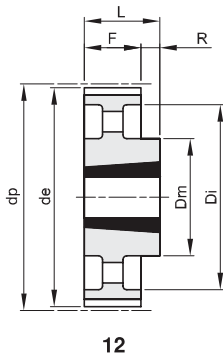
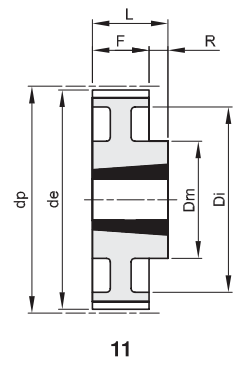
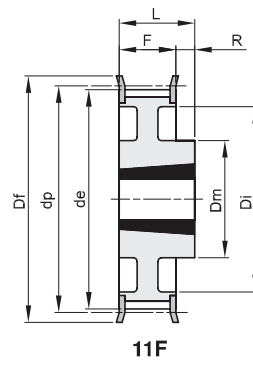
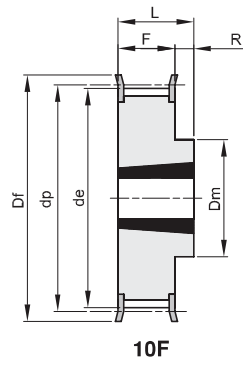

Materiale: Acciaio (St)
Materiale: Ghisa (GG)

codice	tipo	materiale	denti	bussola	foro max	dp	de	Df	Dm	Di	F	L	R	n° flangia	Kg.
TL 22 8M 30	16F	St	22	1008	25	56,02	54,65	60		37	38	22	16	308	0,33
TL 24 8M 30	16F	St	24	1108	25	61,11	59,74	66		44	38	22	16	310	0,40
TL 26 8M 30	16F	St	26	1108	25	66,21	64,84	71		44	38	22	16	311	0,45
TL 28 8M 30	16F	St	28	1210	32	71,30	70,08	75		50	38	25	13	312	0,50
TL 30 8M 30	15F	St	30	1615	42	76,39	75,13	83			38	38		314	0,55
TL 32 8M 30	15F	St	32	1615	42	81,49	80,16	87			38	38		315	0,60
TL 34 8M 30	15F	St	34	1615	42	86,58	85,21	91			38	38		316	0,80
TL 36 8M 30	15F	St	36	1615	42	91,67	90,30	98			38	38		319	1,00
TL 38 8M 30	15F	St	38	1615	42	96,77	95,39	103			38	38		320	1,10
TL 40 8M 30	15F	St	40	1615	42	101,86	100,49	106			38	38		321	1,34
TL 44 8M 30	18F	St	44	2012	50	112,05	110,67	119		86	38	32	3	325	1,30
TL 48 8M 30	18F	St	48	2012	50	122,23	120,86	127		90	38	32	3	327	1,80
TL 56 8M 30	18F	St	56	2012	50	142,60	141,23	148		110	38	32	3	333	3,80
TL 64 8M 30	10F	St	64	2517	60	162,97	161,60	168	125		38	45	7	338	4,30
TL 72 8M 30	11F	St	72	2517	60	183,35	181,97	192	125	158	38	45	7	340	4,40
TL 80 8M 30	11	GG	80	2517	60	203,72	202,35		125	180	38	45	7		4,65
TL 90 8M 30	11	GG	90	2517	60	229,18	227,81		125	204	38	45	7		5,80
TL112 8M 30	12	GG	112	2517	60	285,21	283,83		125	254	38	45	7		6,20
TL144 8M 30	12	GG	144	2517	60	366,69	365,32		125	336	38	45	7		9,00

PULEGGE DENTATE A BUSSOLA CONICA PER CINGHIE SYNCHROBELT® - "HTD" SYNCHROBELT® "HTD" TIMING BELTS PULLEYS FOR TAPER BUSHES

8M

PASSO 8 mm

PER CINGHIE LARGHEZZA 50 mm

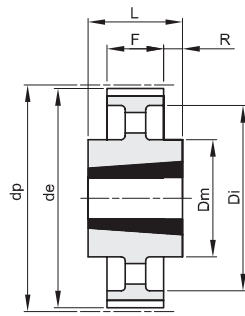

14

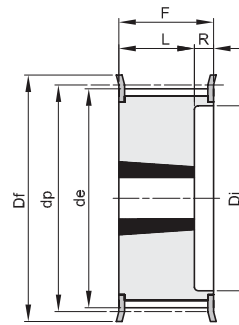

16F

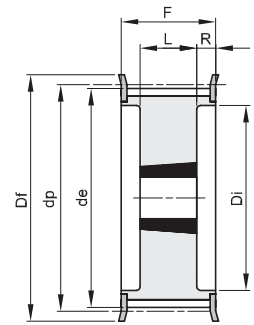

18F

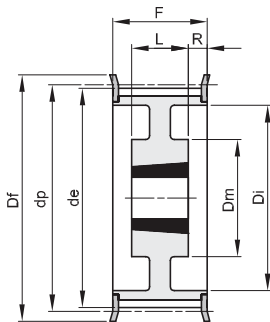

19F

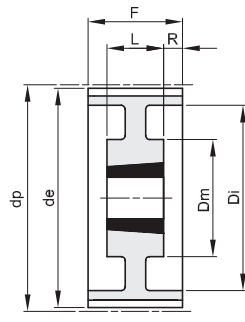

19

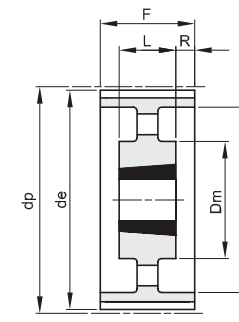

20

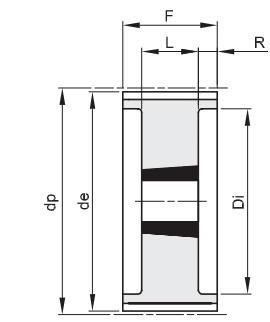

18

Materiale: Acciaio (St)
Materiale: Ghisa (GG)

codice	tipo	materiale	denti	bussola	foro max	dp	de	Df	Dm	Di	F	L	R	n° flangia	Kg.
TL 28 8M 50	16F	St	28	1210	32	71,30	70,08	75		50	60	25	35	312	0,60
TL 30 8M 50	16F	St	30	1615	42	76,39	75,13	83		58	60	38	22	314	0,65
TL 32 8M 50	16F	St	32	1615	42	81,49	80,16	87		63	60	38	22	315	0,80
TL 34 8M 50	16F	St	34	1615	42	86,58	85,21	91		65	60	38	22	316	1,08
TL 36 8M 50	16F	St	36	1615	42	91,67	90,30	98		68	60	38	22	319	1,35
TL 38 8M 50	16F	St	38	1615	42	96,77	95,39	103		72	60	38	22	320	1,65
TL 40 8M 50	18F	St	40	2012	50	101,86	100,49	106		80	60	32	14	321	1,70
TL 44 8M 50	18F	St	44	2012	50	112,05	110,67	119		86	60	32	14	325	1,80
TL 48 8M 50	18F	St	48	2012	50	122,23	120,86	127		95	60	32	14	327	2,35
TL 56 8M 50	18F	St	56	2517	60	142,60	141,23	148		116	60	45	7,5	333	3,35
TL 64 8M 50	18F	St	64	2517	60	162,97	161,60	168		136	60	45	7,5	338	4,90
TL 72 8M 50	19F	St	72	2517	60	183,35	181,97	192	125	158	60	45	7,5	340	6,90
TL 80 8M 50	18	GG	80	3020	75	203,72	202,35			180	60	51	4,5		8,90
TL 90 8M 50	19	GG	90	3020	75	229,18	227,81		160	204	60	51	4,5		9,90
TL112 8M 50	19	GG	112	3020	75	285,21	283,83		170	254	60	51	4,5		12,10
TL144 8M 50	20	GG	144	3020	75	366,69	365,32		170	336	60	51	4,5		15,40
TL168 8M 50	14	GG	168	3525	90	427,81	426,44		198	395	60	65	2,5		22,80
TL192 8M 50	14	GG	192	3525	90	488,92	487,55		198	455	60	65	2,5		26,50

PULEGGE DENTATE A BUSSOLA CONICA PER CINGHIE SYNCHROBELT® - "HTD" SYNCHROBELT® "HTD" TIMING BELTS PULLEYS FOR TAPER BUSHES

8M

PASSO 8 mm

PER CINGHIE LARGHEZZA 85 mm

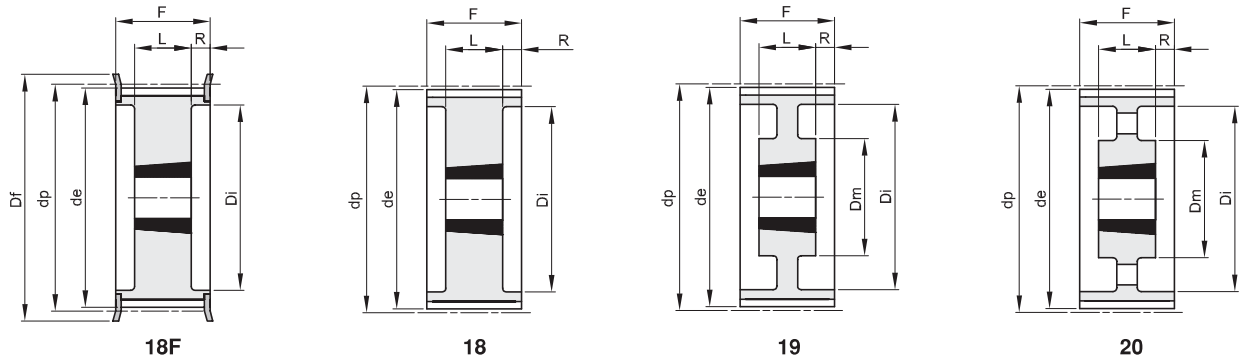

Materiale: Acciaio (St)
 Materiale: Ghisa (GG)

codice	tipo	materiale	denti	bussola	foro max	dp	de	Df	Dm	Di	F	L	R	n° flangia	Kg.
TL 34 8M 85	18F	St	34	1615	42	86,58	85,22	91		65	95	38	28,5	316	1,50
TL 36 8M 85	18F	St	36	1615	42	91,67	90,30	98		68	95	38	28,5	319	1,90
TL 38 8M 85	18F	St	38	1615	42	96,77	95,39	103		72	95	38	28,5	320	2,20
TL 40 8M 85	18F	St	40	2012	50	101,86	100,49	106		80	95	32	31,5	321	1,90
TL 44 8M 85	18F	St	44	2012	50	112,05	110,67	119		86	95	32	31,5	325	2,30
TL 48 8M 85	18F	St	48	2517	60	122,23	120,86	127		97	95	45	25	327	2,70
TL 56 8M 85	18F	St	56	2517	60	142,60	141,23	148		116	95	45	25	333	4,50
TL 64 8M 85	18F	St	64	2517	60	162,97	161,60	168		136	95	45	25	338	6,30
TL 72 8M 85	18F	St	72	3020	75	183,35	181,97	192		150	95	51	22	340	8,10
TL 80 8M 85	18	GG	80	3020	75	203,72	202,35			180	95	51	22		10,20
TL 90 8M 85	19	GG	90	3020	75	229,18	227,81		170	204	95	51	22		11,20
TL112 8M 85	19	GG	112	3020	75	285,21	283,83		170	254	95	51	22		15,00
TL144 8M 85	20	GG	144	3525	90	366,69	365,32		198	336	95	65	15		20,20
TL168 8M 85	20	GG	168	3525	90	427,81	426,44		198	395	95	65	15		22,40
TL192 8M 85	20	GG	192	3525	90	488,92	487,55		198	455	95	65	15		28,20

PULEGGE DENTATE A BUSSOLA CONICA PER CINGHIE SYNCHROBELT® - "HTD" SYNCHROBELT® "HTD" TIMING BELTS PULLEYS FOR TAPER BUSHES

14M

PASSO 14 mm

PER CINGHIE LARGHEZZA 40 mm

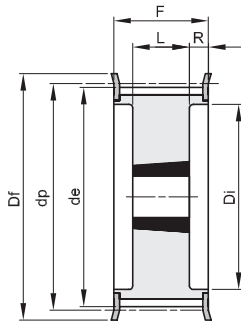

18F

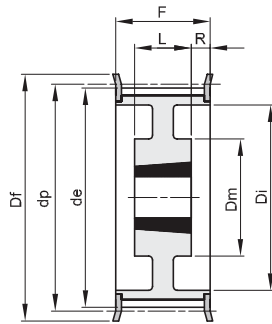

19F

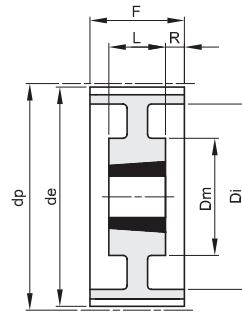

19

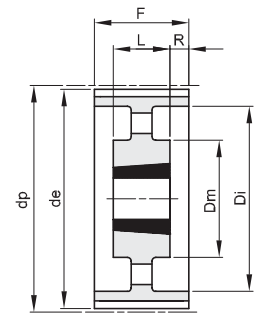

20

Materiale: Acciaio (St)
Materiale: Ghisa (GG)

codice	tipo	materiale	denti	bussola	foro max	dp	de	Df	Dm	Di	F	L	R	n° flangia	Kg.
TL 28 14M 40	18F	St	28	2012	50	124,78	122,12	127		94	54	32	11	400	2,10
TL 30 14M 40	18F	St	30	2012	50	133,69	130,99	138		98	54	32	11	401	2,70
TL 32 14M 40	18F	St	32	2012	50	142,60	139,88	154		108	54	32	11	403	3,40
TL 34 14M 40	18F	St	34	2517	60	151,52	148,79	160		110	54	45	4,5	404	3,90
TL 36 14M 40	18F	St	36	2517	60	160,43	157,68	168		120	54	45	4,5	405	4,80
TL 38 14M 40	18F	St	38	2517	60	169,34	166,60	183		130	54	45	4,5	406	5,40
TL 40 14M 40	18F	St	40	2517	60	178,25	175,49	188		138	54	45	4,5	407	6,00
TL 44 14M 40	18F	St	44	3020	75	196,08	193,28	211		155	54	51	1,5	411	7,50
TL 48 14M 40	18F	St	48	3020	75	213,90	211,11	226		170	54	51	1,5	412	8,50
TL 56 14M 40	18F	GG	56	3020	75	249,55	246,76	256		208	54	51	1,5	416	10,10
* TL 64 14M 40	19F	GG	64	3020	75	285,21	282,41	296	170	240	54	51	1,5	418	
TL 72 14M 40	19	GG	72	3020	75	320,86	318,06		170	280	54	51	1,5		15,00
TL 80 14M 40	20	GG	80	3020	75	356,51	353,71		170	315	54	51	1,5		16,00
TL 90 14M 40	20	GG	90	3020	75	401,07	398,28		170	360	54	51	1,5		18,00
TL112 14M 40	20	GG	112	3020	75	499,11	496,32		170	457	54	51	1,5		25,50
TL144 14M 40	20	GG	144	3020	75	641,71	638,92		170	600	54	51	1,5		32,00
TL168 14M 40	20	GG	168	3020	75	748,66	745,87		170	706	54	51	1,5		43,50
TL192 14M 40	20	GG	192	3020	75	855,62	852,82		170	813	54	51	1,5		49,50



* Costruite a richiesta - Manufactured on request.

PULEGGE DENTATE A BUSSOLA CONICA PER CINGHIE SYNCHROBELT® - "HTD" SYNCHROBELT® "HTD" TIMING BELTS PULLEYS FOR TAPER BUSHES

14M

PASSO 14 mm

PER CINGHIE LARGHEZZA 55 mm

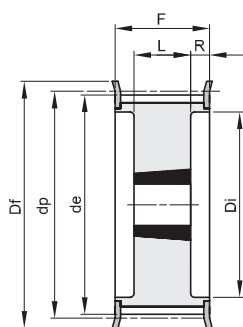

18F

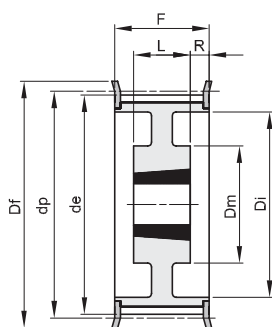

19F

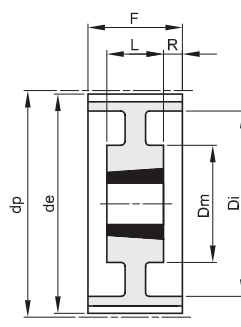

19

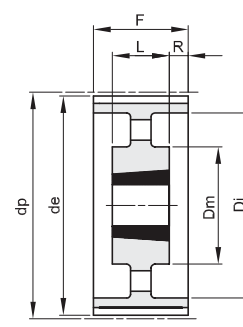

20

Materiale: Acciaio (St)

Materiale: Ghisa (GG)

codice	tipo	materiale	denti	bussola	foro max	dp	de	Df	Dm	Di	F	L	R	n° flangia	Kg.
TL 28 14M 55	18F	St	28	2012	50	124,78	122,12	127		94	70	32	19	400	2,20
TL 30 14M 55	18F	St	30	2517	60	133,69	130,99	138		100	70	45	12,5	401	2,70
TL 32 14M 55	18F	St	32	2517	60	142,60	139,88	154		108	70	45	12,5	403	3,60
TL 34 14M 55	18F	St	34	2517	60	151,52	148,79	160		110	70	45	12,5	404	4,50
TL 36 14M 55	18F	St	36	2517	60	160,43	157,68	168		120	70	45	12,5	405	5,20
TL 38 14M 55	18F	St	38	2517	60	169,34	166,60	183		130	70	45	12,5	406	6,20
TL 40 14M 55	18F	St	40	2517	60	178,25	175,49	188		138	70	45	12,5	407	6,90
TL 44 14M 55	18F	St	44	3020	75	196,08	193,28	211		155	70	51	9,5	411	8,60
TL 48 14M 55	18F	St	48	3020	75	213,90	211,11	226		170	70	51	9,5	412	10,50
TL 56 14M 55	18F	GG	56	3020	75	249,55	246,76	256		208	70	51	9,5	416	13,50
TL 64 14M 55	19F	GG	64	3020	75	285,21	282,41	296	170	240	70	51	9,5	418	14,50
TL 72 14M 55	19	GG	72	3020	75	320,86	318,06		170	280	70	51	9,5		16,30
TL 80 14M 55	20	GG	80	3020	75	356,51	353,71		170	315	70	51	9,5		17,50
TL 90 14M 55	20	GG	90	3020	75	401,07	398,28		170	360	70	51	9,5		20,00
TL112 14M 55	20	GG	112	3020	75	499,11	496,32		170	457	70	51	9,5		28,20
TL144 14M 55	20	GG	144	3020	75	641,71	638,92		170	600	70	51	9,5		36,00
TL168 14M 55	20	GG	168	3020	75	748,66	745,87		170	706	70	51	9,5		48,50
TL192 14M 55	20	GG	192	3020	75	855,62	852,82		170	813	70	51	9,5		52,00

PULEGGE DENTATE A BUSSOLA CONICA PER CINGHIE SYNCHROBELT® - "HTD" SYNCHROBELT® "HTD" TIMING BELTS PULLEYS FOR TAPER BUSHES

14M

PASSO 14 mm

PER CINGHIE LARGHEZZA 85 mm

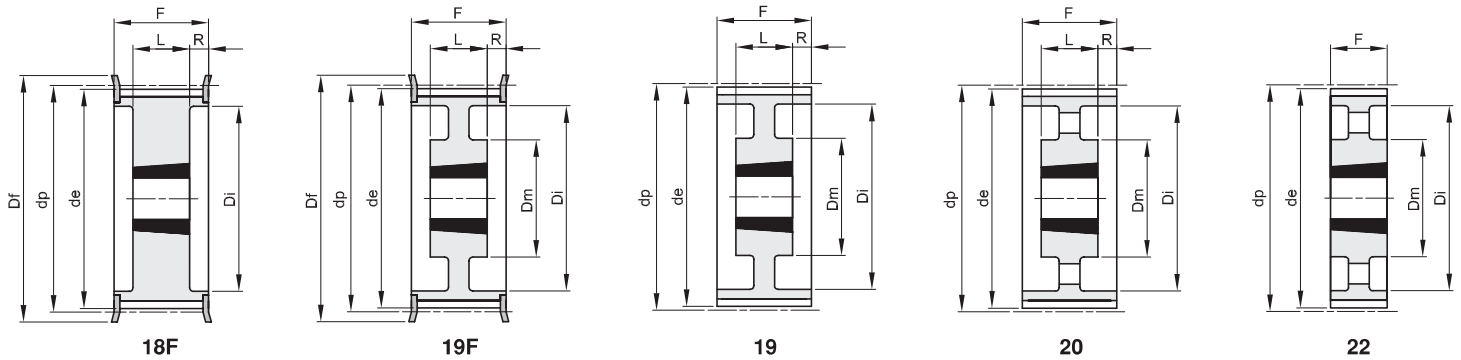

Materiale: Acciaio (St)
Materiale: Ghisa (GG)

codice	tipo	materiale	denti	bussola	foro max	dp	de	Df	Dm	Di	F	L	R	n° flangia	Kg.
TL 28 14M 85	18F	St	28	2517	60	124,78	122,12	127		98	102	45	28,5	400	2,70
TL 30 14M 85	18F	St	30	2517	60	133,69	130,99	138		100	102	45	28,5	401	3,80
TL 32 14M 85	18F	St	32	2517	60	142,60	139,88	154		108	102	45	28,5	403	4,70
TL 34 14M 85	18F	St	34	2517	60	151,52	148,79	160		110	102	45	28,5	404	6,00
TL 36 14M 85	18F	St	36	3020	75	160,43	157,68	168		125	102	51	25,5	405	5,70
TL 38 14M 85	18F	St	38	3020	75	169,34	166,60	183		130	102	51	25,5	406	6,80
TL 40 14M 85	18F	St	40	3020	75	178,25	175,49	188		138	102	51	25,5	407	8,00
TL 44 14M 85	18F	St	44	3030	75	196,08	193,28	211		155	102	76	13	411	11,70
TL 48 14M 85	18F	St	48	3030	75	213,90	211,11	226		170	102	76	13	412	15,00
TL 56 14M 85	18F	GG	56	3525	90	249,55	246,76	256		210	102	65	18,5	416	19,00
TL 64 14M 85	19F	GG	64	3525	90	285,21	282,41	296	190	240	102	65	18,5	418	23,50
TL 72 14M 85	19	GG	72	3525	90	320,86	318,06		190	280	102	65	18,5		25,00
TL 80 14M 85	20	GG	80	3525	90	356,51	353,71		190	315	102	65	18,5		26,00
TL 90 14M 85	20	GG	90	3525	90	401,07	398,28		190	360	102	65	18,5		28,00
TL112 14M 85	20	GG	112	3525	90	499,11	496,32		190	457	102	65	18,5		36,00
TL144 14M 85	20	GG	144	3525	90	641,71	638,92		190	600	102	65	18,5		48,00
TL168 14M 85	20	GG	168	3525	90	748,66	745,87		190	706	102	65	18,5		60,00
TL192 14M 85	22	GG	192	4040	100	855,62	852,82		230	813	102	102			85,00

PULEGGE DENTATE A BUSSOLA CONICA PER CINGHIE SYNCHROBELT® - "HTD" SYNCHROBELT® "HTD" TIMING BELTS PULLEYS FOR TAPER BUSHES

14M

PASSO 14 mm

PER CINGHIE LARGHEZZA 115 mm

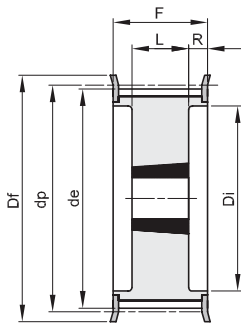

18F

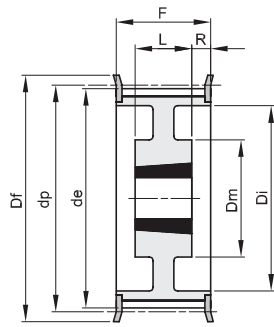

19F

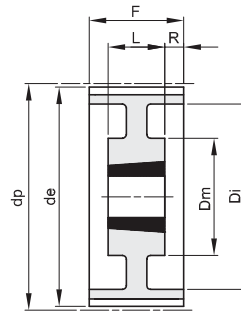

19

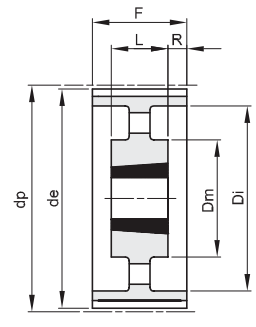

20

Materiale: Acciaio (St)
Materiale: Ghisa (GG)

codice	tipo	materiale	denti	bussola	foro max	dp	de	Df	Dm	Di	F	L	R	n° flangia	Kg.
TL 28 14M 115	18F	St	28	2517	60	124,78	122,12	127		98	133	45	44	400	3,80
TL 30 14M 115	18F	St	30	2517	60	133,69	130,99	138		100	133	45	44	401	5,00
TL 32 14M 115	18F	St	32	2517	60	142,60	139,88	154		108	133	45	44	403	6,80
TL 34 14M 115	18F	St	34	2517	60	151,52	148,79	160		110	133	45	44	404	6,90
TL 36 14M 115	18F	St	36	3020	75	160,43	157,68	168		125	133	51	41	405	7,00
TL 38 14M 115	18F	St	38	3020	75	169,34	166,60	183		130	133	51	41	406	8,50
TL 40 14M 115	18F	St	40	3020	75	178,25	175,49	188		138	133	51	41	407	9,10
TL 44 14M 115	18F	St	44	3030	75	196,08	193,28	211		155	133	76	28,5	411	13,00
TL 48 14M 115	18F	St	48	3030	75	213,90	211,11	226		170	133	76	28,5	412	16,00
TL 56 14M 115	18F	GG	56	3535	90	249,55	246,76	256		210	133	89	22	416	24,00
TL 64 14M 115	19F	GG	64	3535	90	285,21	282,41	296	190	240	133	89	22	418	32,00
TL 72 14M 115	19	GG	72	3535	90	320,86	318,06		190	280	133	89	22		31,00
TL 80 14M 115	20	GG	80	3535	90	356,51	353,71		190	315	133	89	22		32,00
TL 90 14M 115	20	GG	90	3535	90	401,07	398,28		190	360	133	89	22		37,00
TL112 14M 115	20	GG	112	3535	90	499,11	496,32		190	457	133	89	22		45,00
TL144 14M 115	20	GG	144	4040	100	641,71	638,92		230	600	133	102	15,5		63,00
TL168 14M 115	20	GG	168	4040	100	748,66	745,87		230	706	133	102	15,5		77,50
TL192 14M 115	20	GG	192	4040	100	855,62	852,82		230	813	133	102	15,5		95,00

DIMENSIONI FLANGE PER PULEGGE DENTATE - ZINCATE

PULLEYS FLANGES DIMENSIONS ZINC PLATED

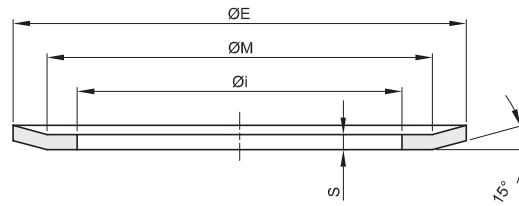

n° spessore S=0,5 mm				n° spessore S=1 mm				n° spessore S=1,5 mm				n° spessore S=2,5 mm			
flangia	Ø E	Ø M	Ø i	flangia	Ø E	Ø M	Ø i	flangia	Ø E	Ø M	Ø i	flangia	Ø E	Ø M	Ø i
100	13	10	6	200	19,5	17,5	12,5	300	36	31	25	400	127	120,2	104,7
101	15	12	8	201	23	17,5	12	301	38	34	28	401	138	130	108
102	16	13	9,5	202	23	20	14	302	42	38	30,5	402	146	138	116
104	18	15	11,5	203	25	22	15	303	44	40	33	403	154	146	122
105	19,5	17,5	12	204	28	24	18	304	48	43,5	37	404	160	150	128
106	23	17,5	12	205	32	28	21,5	305	51	47,5	40	405	168	162	135
107	23	20	14	206	36	31	25	306	54	50,5	43	406	183	170	145
108	25	22	15	207	38	34	28	307	57	53	46	407	188	180	158
109	28	24	18	208	42	38	30,5	308	60	57	47	409	198	188	165
110	32	28	21,5	209	44	40	33	309	63	57	48	410	200	192,8	172
111	36	31	25	210	48	43,5	37	310	66	61,5	52	411	211	198	173
112	38	34	28	211	51	47,5	40	311	71	65	56	412	226	214	190
113	42	38	30,5	212	54	50,5	43	312	75	68,5	60	414	240	224	192
114	48	43,5	37	213	57	53	46	313	79	73,5	64	415	256	240	220
				214	60	57	47	314	83	76,5	68	416	256	247	225
				215	63	57	48	315	87	82,5	72	418	296	287	252
				216	66	61,5	52	316	91	85,5	76				
				217	71	65	56	317	93	89	80				
				218	75	68,5	60	318	97	93	83				
				219	83	76,5	68	319	98	92	79,3				
				220	87	82,5	72	320	103	97	86				
				221	91	85,5	76	321	106	101	90				
				222	93	89	80	322	111	106	94				
				223	97	93	83	323	115	110	99				
				224	106	101	90	325	119	113,5	103				
				225	119	113,5	103	326	123	117,5	107				
				226	131	125,5	115	327	127	122	111				
								328	135	130	119				
								330	140	134,5	123				
								331	143	139	127				
								333	148	143	132				
								334	152	147,5	136				
								335	158	154	142				
								338	168	163	149,5				
								339	184	179	165				
								340	192	187	173				
								342	200	195	181				

PULEGGE DENTATE PER CINGHIE POSITIVE SYNCHROBELT® - ISO 5294

TIMING BELTS PULLEYS - ISO 5294

MXL 025

PASSO 0,80" (2,032 mm)
PER CINGHIE LARGHEZZA 1/4" (6,35 mm)

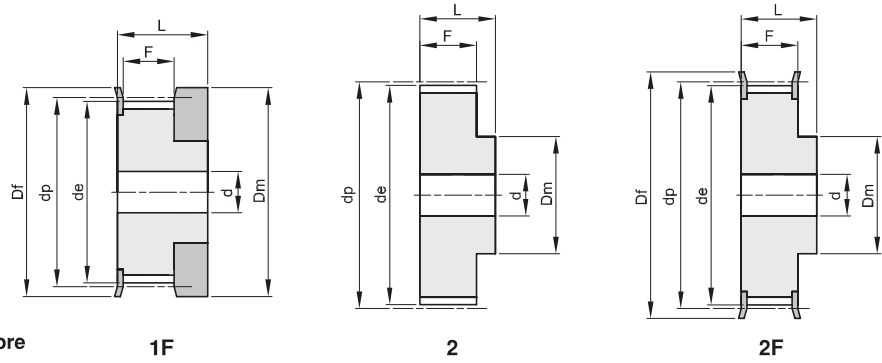

Materiale: Alluminio UNI 9006 - T6 (Al)
adatto per l'ossidazione dura a spessore

codice	tipo	materiale	denti	dp	de	Df	Dm	F	L	d	n° flangia	Kg.
16 MXL 025	1F	Al	16	10,35	9,84	15	15	8,5	16		101	0,01
18 MXL 025	1F	Al	18	11,64	11,13	16	16	8,5	16		102	0,01
20 MXL 025	1F	Al	20	12,94	12,43	16	16	8,5	16		102	0,01
22 MXL 025	2F	Al	22	14,23	13,72	18	10	11	16	3	104	0,01
24 MXL 025	2F	Al	24	15,52	15,02	18	10	11	16	3	104	0,01
28 MXL 025	2F	Al	28	18,11	17,60	23	11	11	16	3	107	0,01
30 MXL 025	2F	Al	30	19,40	18,90	23	12	11	16	4	107	0,02
32 MXL 025	2F	Al	32	20,70	20,19	25	14	11	16	4	108	0,02
36 MXL 025	2F	Al	36	23,29	22,78	28	16	11	16	4	109	0,02
40 MXL 025	2F	Al	40	25,87	25,36	32	18	11	16	4	110	0,03
42 MXL 025	2F	Al	42	27,17	26,66	32	18	11	16	5	110	0,03
44 MXL 025	2F	Al	44	28,46	27,95	36	18	11	16	5	111	0,03
48 MXL 025	2	Al	48	31,05	30,54		20	11	16	5		0,03
60 MXL 025	2	Al	60	38,81	38,30		24	11	16	5		0,04
72 MXL 025	2	Al	72	46,57	46,06		25	11	16	6		0,05

PULEGGE DENTATE PER CINGHIE POSITIVE SYNCHROBELT® - ISO 5294

TIMING BELTS PULLEYS - ISO 5294

XL 037

PASSO 1/5" (5,08 mm)

PER CINGHIE LARGHEZZA 3/8" (9,52 mm)

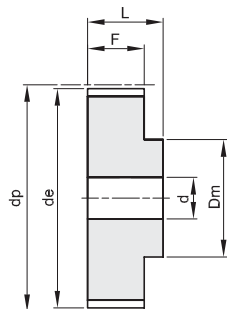

2

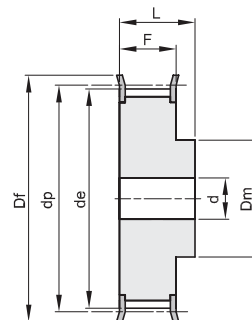

2F

Materiale: Alluminio UNI 9006 - T6 (Al)
adatto per l'ossidazione dura a spessore

codice	tipo	materiale	denti	dp	de	Df	Dm	F	L	d	n° flangia	Kg.
10 XL 037	2F	Al	10	16,17	15,66	23	10	14,3	20		201	0,01
11 XL 037	2F	Al	11	17,79	17,28	23	10	14,3	20		201	0,01
12 XL 037	2F	Al	12	19,40	18,90	25	10	14,3	20		203	0,01
13 XL 037	2F	Al	13	21,02	20,51	25	10	14,3	20		203	0,01
14 XL 037	2F	Al	14	22,64	23,13	28	16	14,3	20		204	0,02
15 XL 037	2F	Al	15	24,25	23,75	28	16	14,3	20		204	0,02
16 XL 037	2F	Al	16	25,87	25,36	32	16	14,3	20		205	0,03
17 XL 037	2F	Al	17	27,49	26,98	32	20	14,3	20		205	0,03
18 XL 037	2F	Al	18	29,11	28,60	36	20	14,3	20		206	0,04
19 XL 037	2F	Al	19	30,72	30,21	36	20	14,3	22		206	0,04
20 XL 037	2F	Al	20	32,34	31,83	38	25	14,3	22		207	0,05
21 XL 037	2F	Al	21	33,96	33,45	38	25	14,3	22		207	0,05
22 XL 037	2F	Al	22	35,57	35,07	42	25	14,3	22		208	0,06
24 XL 037	2F	Al	24	38,81	38,30	44	30	14,3	22		209	0,06
26 XL 037	2F	Al	26	42,04	41,53	48	30	14,3	22	8	210	0,09
27 XL 037	2F	Al	27	43,66	43,15	48	34	14,3	22	8	210	0,09
28 XL 037	2F	Al	28	45,28	44,77	51	34	14,3	22	8	211	0,10
30 XL 037	2F	Al	30	48,51	48,00	54	38	14,3	22	8	212	0,12
32 XL 037	2F	Al	32	51,74	51,24	57	38	14,3	25	8	213	0,12
34 XL 037	2F	Al	34	54,98	54,47	60	38	14,3	25	8	214	0,13
35 XL 037	2F	Al	35	56,60	56,09	63	38	14,3	25	8	215	0,14
36 XL 037	2	Al	36	58,21	57,70		45	14,3	25	8		0,14
38 XL 037	2	Al	38	61,45	60,94		45	14,3	25	8		0,15
40 XL 037	2	Al	40	64,68	64,17		45	14,3	25	8		0,16
42 XL 037	2	Al	42	67,91	67,41		45	14,3	25	8		0,18
44 XL 037	2	Al	44	71,15	70,64		45	14,3	25	8		0,19
48 XL 037	2	Al	48	77,62	77,11		45	14,3	25	10		0,19
52 XL 037	2	Al	52	84,08	83,57		45	14,3	25	10		0,19
60 XL 037	2	Al	60	97,02	96,51		45	14,3	25	10		0,22
72 XL 037	2	Al	72	116,42	115,92		45	14,3	25	10		0,44

PULEGGE DENTATE PER CINGHIE POSITIVE SYNCHROBELT® - ISO 5294

TIMING BELTS PULLEYS - ISO 5294

L 050

PASSO 3/8" (9,525 mm)
PER CINGHIE LARGHEZZA 1/2" (12,7 mm)

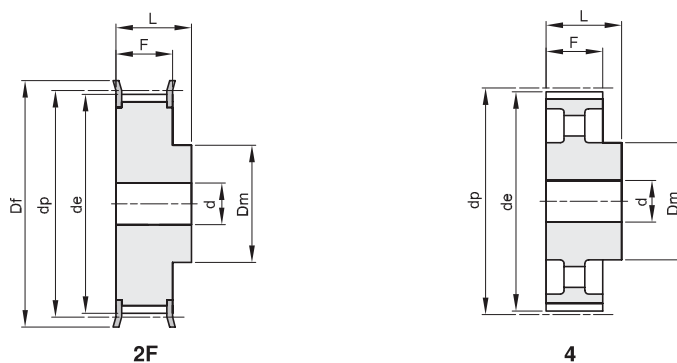

Materiale: Acciaio (St)
Materiale: Ghisa (GG)

codice	tipo	materiale	denti	dp	de	Df	Dm	F	L	d	n° flangia	Kg.
10 L 050	2F	St	10	30,32	29,56	36	20	19,0	28	8	300	0,11
11 L 050	2F	St	11	33,35	32,59	38	24	19,0	30	8	301	0,14
12 L 050	2F	St	12	36,38	35,62	42	24	19,0	30	8	302	0,17
13 L 050	2F	St	13	39,41	38,65	44	28	19,0	30	8	303	0,21
14 L 050	2F	St	14	42,44	41,68	48	28	19,0	30	8	304	0,24
15 L 050	2F	St	15	45,48	44,72	51	34	19,0	30	8	305	0,29
16 L 050	2F	St	16	48,51	47,75	54	36	19,0	32	8	306	0,33
17 L 050	2F	St	17	51,54	50,78	57	36	19,0	32	10	307	0,38
18 L 050	2F	St	18	54,57	53,81	60	40	19,0	32	10	308	0,44
19 L 050	2F	St	19	57,61	56,84	63	40	19,0	32	10	309	0,47
20 L 050	2F	St	20	60,64	59,88	66	40	19,0	32	10	310	0,51
21 L 050	2F	St	21	63,67	62,91	71	45	19,0	32	10	311	0,60
22 L 050	2F	St	22	66,70	65,94	75	45	19,0	32	10	312	0,64
23 L 050	2F	St	23	69,73	68,97	79	55	19,0	32	10	313	0,78
24 L 050	2F	St	24	72,77	72,00	79	55	19,0	32	10	313	0,81
25 L 050	2F	St	25	75,80	75,04	83	58	19,0	32	10	314	0,89
26 L 050	2F	St	26	78,83	78,07	87	58	19,0	32	12	315	0,94
27 L 050	2F	St	27	81,86	81,10	87	58	19,0	32	12	315	0,99
28 L 050	2F	St	28	84,89	84,13	91	58	19,0	32	12	316	1,04
30 L 050	2F	St	30	90,96	90,20	97	70	19,0	32	12	318	1,17
32 L 050	2F	St	32	97,03	96,26	103	70	19,0	32	12	320	1,41
33 L 050	2F	St	33	100,05	99,29	106	70	19,0	32	12	321	1,49
34 L 050	2F	St	34	103,08	102,32	111	70	19,0	32	12	322	1,57
35 L 050	2F	St	35	106,12	105,35	111	70	19,0	32	12	322	1,62
36 L 050	2F	St	36	109,15	108,39	115	70	19,0	32	12	323	1,70
40 L 050	2F	St	40	121,29	120,51	127	70	19,0	32	12	327	2,03
42 L 050	2F	St	42	127,34	126,58	135	70	19,0	32	12	328	2,21
44 L 050	2F	St	44	133,40	132,64	140	70	19,0	32	12	330	2,38
45 L 050	2F	St	45	136,44	135,67	143	70	19,0	32	12	331	2,48
48 L 050	2F	St	48	145,53	144,77	152	70	19,0	32	12	334	2,78
50 L 050	4	GG	50	151,60	150,83		70	19,0	32	14		1,74
52 L 050	4	GG	52	157,66	156,90		70	19,0	32	14		1,80
56 L 050	4	GG	56	169,79	169,02		70	19,0	32	14		1,87
57 L 050	4	GG	57	172,82	172,06		70	19,0	32	14		1,88
60 L 050	4	GG	60	181,91	181,15		75	19,0	42	14		2,41
72 L 050	4	GG	72	218,29	217,53		75	19,0	42	14		2,82
84 L 050	4	GG	84	254,68	253,92		75	19,0	42	14		3,08
96 L 050	4	GG	96	291,06	290,30		75	19,0	42	14		3,42

PULEGGE DENTATE PER CINGHIE POSITIVE SYNCHROBELT® - ISO 5294

TIMING BELTS PULLEYS - ISO 5294

L 075

PASSO 3/8" (9,525 mm)

PER CINGHIE LARGHEZZA 3/4" (19,05 mm)

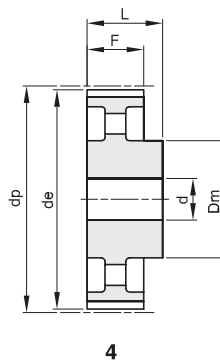
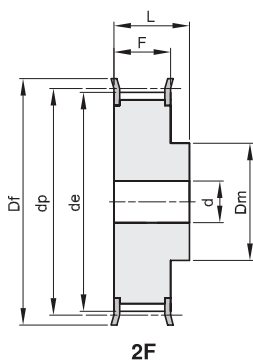

Materiale: Acciaio (St)
Materiale: Ghisa (GG)

codice	tipo	materiale	denti	dp	de	Df	Dm	F	L	d	n° flangia	Kg.
10 L 075	2F	St	10	30,32	29,56	36	20	25,4	38	8	300	0,14
11 L 075	2F	St	11	33,35	32,59	38	24	25,4	38	8	301	0,18
12 L 075	2F	St	12	36,38	35,62	42	24	25,4	38	8	302	0,22
13 L 075	2F	St	13	39,41	38,65	44	28	25,4	38	8	303	0,26
14 L 075	2F	St	14	42,44	41,68	48	28	25,4	38	8	304	0,30
15 L 075	2F	St	15	45,48	44,72	51	34	25,4	38	8	305	0,37
16 L 075	2F	St	16	48,51	47,75	54	36	25,4	38	8	306	0,43
17 L 075	2F	St	17	51,54	50,78	57	36	25,4	38	10	307	0,46
18 L 075	2F	St	18	54,57	53,81	60	40	25,4	38	10	308	0,54
19 L 075	2F	St	19	57,61	56,84	63	40	25,4	38	10	309	0,58
20 L 075	2F	St	20	60,64	59,88	66	40	25,4	38	10	310	0,64
21 L 075	2F	St	21	63,67	62,91	71	45	25,4	38	10	311	0,71
22 L 075	2F	St	22	66,70	65,94	75	45	25,4	38	10	312	0,79
23 L 075	2F	St	23	69,73	68,97	79	55	25,4	38	10	313	0,94
24 L 075	2F	St	24	72,77	72,00	79	55	25,4	38	10	313	1,00
25 L 075	2F	St	25	75,80	75,04	83	58	25,4	38	10	314	1,10
26 L 075	2F	St	26	78,83	78,07	87	58	25,4	38	12	315	1,16
27 L 075	2F	St	27	81,86	81,10	87	58	25,4	38	12	315	1,22
28 L 075	2F	St	28	84,89	84,13	91	58	25,4	38	12	316	1,30
30 L 075	2F	St	30	90,96	90,20	97	70	25,4	38	12	318	1,47
32 L 075	2F	St	32	97,03	96,26	103	70	25,4	38	12	320	1,75
33 L 075	2F	St	33	100,05	99,29	106	70	25,4	38	12	321	1,85
34 L 075	2F	St	34	103,08	102,32	111	70	25,4	38	12	322	1,93
35 L 075	2F	St	35	106,12	105,35	111	70	25,4	38	12	322	2,03
36 L 075	2F	St	36	109,15	108,39	115	70	25,4	38	12	323	2,14
40 L 075	2F	St	40	121,29	120,51	127	70	25,4	38	12	327	2,56
42 L 075	2F	St	42	127,34	126,58	135	70	25,4	38	12	328	2,81
44 L 075	2F	St	44	133,40	132,64	140	70	25,4	38	12	330	3,02
45 L 075	2F	St	45	136,44	135,67	143	70	25,4	38	12	331	3,16
48 L 075	2F	St	48	145,53	144,77	152	70	25,4	38	12	334	3,57
50 L 075	4	GG	50	151,60	150,83		70	25,4	38	14		2,10
52 L 075	4	GG	52	157,66	156,90		70	25,4	38	14		2,13
56 L 075	4	GG	56	169,79	169,02		70	25,4	38	14		2,27
57 L 075	4	GG	57	172,82	172,06		70	25,4	38	14		2,28
60 L 075	4	GG	60	181,91	181,15		75	25,4	45	14		2,70
72 L 075	4	GG	72	218,29	217,53		75	25,4	45	14		3,19
84 L 075	4	GG	84	254,68	253,92		75	25,4	45	14		3,64
96 L 075	4	GG	96	291,06	290,30		75	25,4	45	14		4,04

PULEGGE DENTATE PER CINGHIE POSITIVE SYNCHROBELT® - ISO 5294

TIMING BELTS PULLEYS - ISO 5294

L 100

PASSO 3/8" (9,525 mm)

PER CINGHIE LARGHEZZA 1" (25,4 mm)

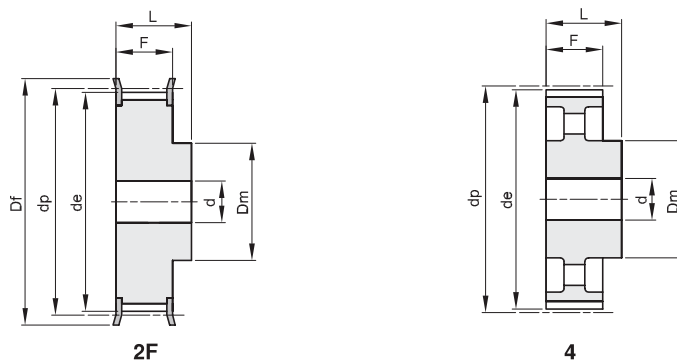

Materiale: Acciaio (St)
Materiale: Ghisa (GG)

codice	tipo	materiale	denti	dp	de	Df	Dm	F	L	d	n° flangia	Kg.
10 L 100	2F	St	10	30,32	29,56	36	20	31,8	45	8	300	0,17
11 L 100	2F	St	11	33,35	32,59	38	24	31,8	45	8	301	0,22
12 L 100	2F	St	12	36,38	35,62	42	24	31,8	45	8	302	0,26
13 L 100	2F	St	13	39,41	38,65	44	28	31,8	45	8	303	0,32
14 L 100	2F	St	14	42,44	41,68	48	28	31,8	45	10	304	0,35
15 L 100	2F	St	15	45,48	44,72	51	34	31,8	45	10	305	0,43
16 L 100	2F	St	16	48,51	47,75	54	36	31,8	45	10	306	0,50
17 L 100	2F	St	17	51,54	50,78	57	36	31,8	45	10	307	0,56
18 L 100	2F	St	18	54,57	53,81	60	40	31,8	45	10	308	0,64
19 L 100	2F	St	19	57,61	56,84	63	40	31,8	45	10	309	0,70
20 L 100	2F	St	20	60,64	59,88	66	40	31,8	45	10	310	0,77
21 L 100	2F	St	21	63,67	62,91	71	45	31,8	45	10	311	0,88
22 L 100	2F	St	22	66,70	65,94	75	45	31,8	45	12	312	0,95
23 L 100	2F	St	23	69,73	68,97	79	55	31,8	45	12	313	1,11
24 L 100	2F	St	24	72,77	72,00	79	55	31,8	45	12	313	1,18
25 L 100	2F	St	25	75,80	75,04	83	58	31,8	45	12	314	1,30
26 L 100	2F	St	26	78,83	78,07	87	58	31,8	45	12	315	1,40
27 L 100	2F	St	27	81,86	81,10	87	58	31,8	45	12	315	1,47
28 L 100	2F	St	28	84,89	84,13	91	58	31,8	45	12	316	1,58
30 L 100	2F	St	30	90,96	90,20	97	70	31,8	45	12	318	1,78
32 L 100	2F	St	32	97,03	96,26	103	70	31,8	45	12	320	2,11
33 L 100	2F	St	33	100,05	99,29	106	70	31,8	45	12	321	2,23
34 L 100	2F	St	34	103,08	102,32	111	70	31,8	45	12	322	2,39
35 L 100	2F	St	35	106,12	105,35	111	70	31,8	45	12	322	2,45
36 L 100	2F	St	36	109,15	108,39	115	70	31,8	45	12	323	2,59
40 L 100	2F	St	40	121,29	120,51	127	70	31,8	45	12	327	3,13
42 L 100	2F	St	42	127,34	126,58	135	70	31,8	45	12	328	3,43
44 L 100	2F	St	44	133,40	132,64	140	70	31,8	45	12	330	3,72
45 L 100	2F	St	45	136,44	135,67	143	70	31,8	45	12	331	3,89
48 L 100	2F	St	48	145,53	144,77	152	70	31,8	45	12	334	4,38
50 L 100	4	GG	50	151,60	150,83		70	31,8	45	14		2,41
52 L 100	4	GG	52	157,66	156,90		70	31,8	45	14		2,55
56 L 100	4	GG	56	169,79	169,02		70	31,8	45	14		2,65
57 L 100	4	GG	57	172,82	172,06		70	31,8	45	14		2,71
60 L 100	4	GG	60	181,91	181,15		75	31,8	45	14		3,11
72 L 100	4	GG	72	218,29	217,53		75	31,8	45	14		3,65
84 L 100	4	GG	84	254,68	253,92		75	31,8	45	14		4,12
96 L 100	4	GG	96	291,06	290,30		75	31,8	45	14		4,60

PULEGGE DENTATE PER CINGHIE POSITIVE SYNCHROBELT® - ISO 5294

TIMING BELTS PULLEYS - ISO 5294

H 075

PASSO 1/2" (12,7 mm)

PER CINGHIE LARGHEZZA 3/4" (19,05 mm)

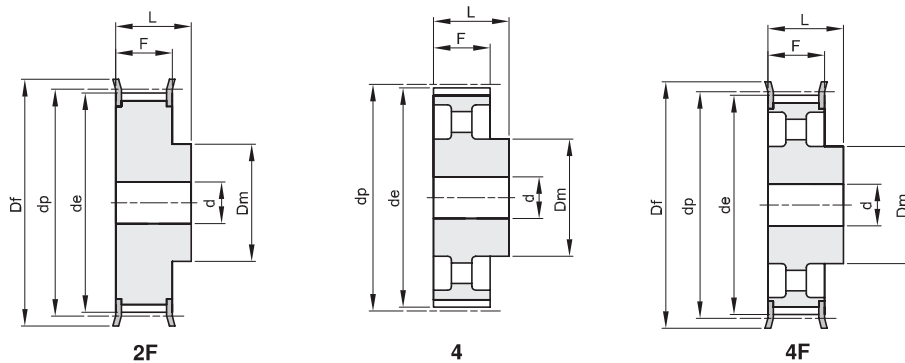

Materiale: Acciaio (St)
Materiale: Ghisa (GG)

codice	tipo	materiale	denti	dp	de	Df	Dm	F	L	d	n° flangia	Kg.
14 H 075	2F	St	14	56,59	55,22	63	40	26,4	40	10	309	0,58
15 H 075	2F	St	15	60,64	59,27	66	45	26,4	40	10	310	0,69
16 H 075	2F	St	16	64,68	63,31	71	45	26,4	40	10	311	0,77
17 H 075	2F	St	17	68,72	67,35	75	45	26,4	40	12	312	0,84
18 H 075	2F	St	18	72,77	71,39	79	55	26,4	40	12	313	1,01
19 H 075	2F	St	19	76,81	75,44	83	60	26,4	40	12	314	1,15
20 H 075	2F	St	20	80,85	79,48	87	62	26,4	40	12	315	1,27
21 H 075	2F	St	21	84,89	83,52	91	65	26,4	40	12	316	1,41
22 H 075	2F	St	22	88,94	87,56	93	68	26,4	40	12	317	1,55
23 H 075	2F	St	23	92,98	91,61	97	72	26,4	40	12	318	1,71
24 H 075	2F	St	24	97,03	95,65	103	72	26,4	40	12	320	1,83
25 H 075	2F	St	25	101,06	99,69	106	72	26,4	40	12	321	1,96
26 H 075	2F	St	26	105,11	103,73	111	80	26,4	40	12	322	2,19
27 H 075	2F	St	27	109,15	107,78	115	80	26,4	40	12	323	2,32
28 H 075	2F	St	28	113,19	111,82	119	80	26,4	40	12	325	2,47
30 H 075	2F	St	30	121,29	119,90	127	80	26,4	40	14	327	2,76
32 H 075	2F	St	32	129,36	127,99	135	80	26,4	40	14	328	3,08
33 H 075	2F	St	33	133,40	132,03	140	80	26,4	40	14	330	3,25
34 H 075	2F	St	34	137,45	136,07	143	80	26,4	40	14	331	3,42
35 H 075	2F	St	35	141,49	140,12	148	80	26,4	40	14	333	3,61
36 H 075	2F	St	36	145,53	144,16	152	80	26,4	40	14	334	3,79
38 H 075	2F	St	38	153,62	152,24	158	80	26,4	40	14	335	4,16
40 H 075	2F	St	40	161,70	160,33	168	80	26,4	40	14	338	4,58
44 H 075	4F	GG	44	177,87	176,50	184	80	26,4	40	18	339	2,57
48 H 075	4F	GG	48	194,04	192,67	200	90	26,4	45	18	342	3,56
50 H 075	4	GG	50	202,13	200,75	90	90	26,4	45	18		3,74

PULEGGE DENTATE PER CINGHIE POSITIVE SYNCHROBELT® - ISO 5294

TIMING BELTS PULLEYS - ISO 5294

H 100

PASSO 1/2" (12,7 mm)

PER CINGHIE LARGHEZZA 1" (25,4 mm)

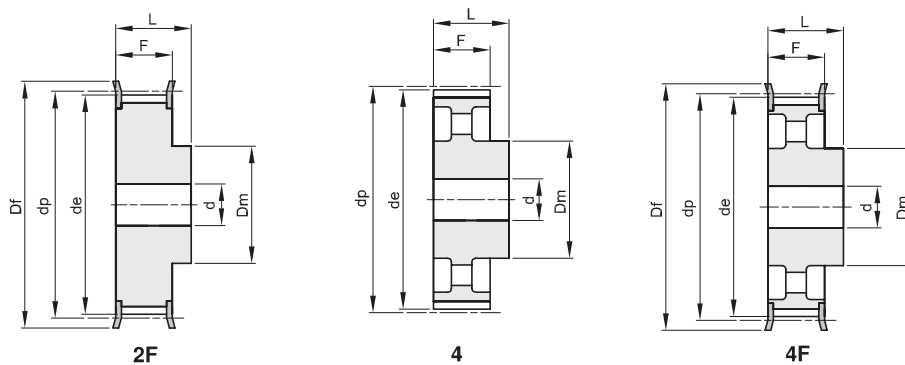

Materiale: Acciaio (St)
Materiale: Ghisa (GG)

codice	tipo	materiale	denti	dp	de	Df	Dm	F	L	d	n° flangia	Kg.
14 H 100	2F	St	14	56,59	55,22	63	40	31,8	45	12	309	0,65
15 H 100	2F	St	15	60,64	59,27	66	45	31,8	45	12	310	0,77
16 H 100	2F	St	16	64,68	63,31	71	45	31,8	45	12	311	0,87
17 H 100	2F	St	17	68,72	67,35	75	45	31,8	45	12	312	0,97
18 H 100	2F	St	18	72,77	71,39	79	55	31,8	45	12	313	1,16
19 H 100	2F	St	19	76,81	75,44	83	60	31,8	45	14	314	1,30
20 H 100	2F	St	20	80,85	79,48	87	62	31,8	45	14	315	1,44
21 H 100	2F	St	21	84,89	83,52	91	65	31,8	45	14	316	1,60
22 H 100	2F	St	22	88,94	87,56	93	68	31,8	45	14	317	1,76
23 H 100	2F	St	23	92,98	91,61	97	72	31,8	45	14	318	1,94
24 H 100	2F	St	24	97,03	95,65	103	72	31,8	45	14	320	2,09
25 H 100	2F	St	25	101,06	99,69	106	72	31,8	45	14	321	2,24
26 H 100	2F	St	26	105,11	103,73	111	80	31,8	45	14	322	2,49
27 H 100	2F	St	27	109,15	107,78	115	80	31,8	45	14	323	2,66
28 H 100	2F	St	28	113,19	111,82	119	80	31,8	45	14	325	2,83
29 H 100	2F	St	29	117,23	115,86	123	80	31,8	45	14	326	3,01
30 H 100	2F	St	30	121,29	119,90	127	80	31,8	45	14	327	3,19
32 H 100	2F	St	32	129,36	127,99	135	80	31,8	45	14	328	3,57
33 H 100	2F	St	33	133,40	132,03	140	80	31,8	45	14	330	3,79
34 H 100	2F	St	34	137,45	136,07	143	80	31,8	45	14	331	3,99
35 H 100	2F	St	35	141,49	140,12	148	80	31,8	45	14	333	4,20
36 H 100	2F	St	36	145,53	144,16	152	80	31,8	45	14	334	4,44
38 H 100	2F	St	38	153,62	152,24	158	80	31,8	45	14	335	4,90
40 H 100	2F	St	40	161,70	160,33	168	80	31,8	45	14	338	5,39
44 H 100	4F	GG	44	177,87	176,50	184	80	31,8	50	18	339	3,37
45 H 100	4F	GG	45	181,91	180,54	192	80	31,8	50	18	340	3,57
48 H 100	4F	GG	48	194,04	192,67	200	90	31,8	50	18	342	4,10
50 H 100	4	GG	50	202,13	200,75		90	31,8	50	18		4,24
52 H 100	4	GG	52	210,21	208,84		90	31,8	50	18		4,32
58 H 100	4	GG	58	234,47	233,09		90	31,8	50	18		4,61
60 H 100	4	GG	60	242,55	241,18		100	31,8	50	18		5,30
70 H 100	4	GG	70	282,98	281,61		100	31,8	55	18		6,13
72 H 100	4	GG	72	291,06	289,69		120	31,8	55	18		7,47
84 H 100	4	GG	84	339,57	338,20		120	31,8	55	18		8,52
96 H 100	4	GG	96	388,08	386,71		120	31,8	60	18		10,25
120 H 100	4	GG	120	485,10	483,73		120	31,8	60	18		13,09

PULEGGE DENTATE PER CINGHIE POSITIVE SYNCHROBELT® - ISO 5294

TIMING BELTS PULLEYS - ISO 5294

H 150

PASSO 1/2" (12,7 mm)

PER CINGHIE LARGHEZZA 1 1/2 (38,1 mm)

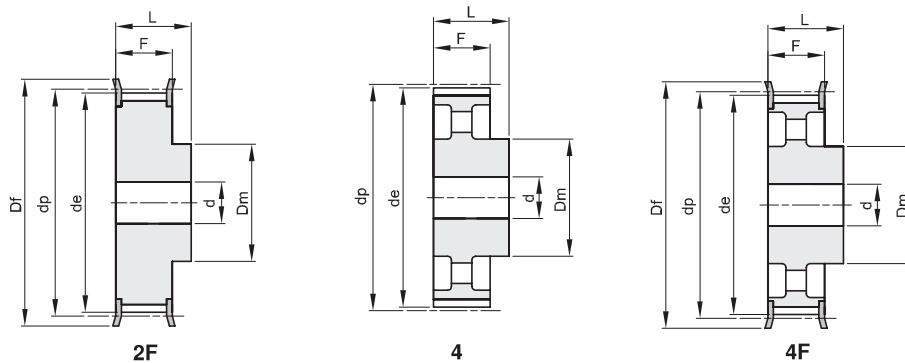

Materiale: Acciaio (St)
Materiale: Ghisa (GG)

codice	tipo	materiale	denti	dp	de	Df	Dm	F	L	d	n° flangia	Kg.
14 H 150	2F	St	14	56,59	55,22	63	40	46,0	58	18	309	0,81
15 H 150	2F	St	15	60,64	59,27	66	45	46,0	58	18	310	0,97
16 H 150	2F	St	16	64,68	63,31	71	45	46,0	58	18	311	1,11
17 H 150	2F	St	17	68,72	67,35	75	45	46,0	58	18	312	1,25
18 H 150	2F	St	18	72,77	71,39	79	55	46,0	58	18	313	1,48
19 H 150	2F	St	19	76,81	75,44	83	60	46,0	58	18	314	1,68
20 H 150	2F	St	20	80,85	79,48	87	62	46,0	58	18	315	1,88
21 H 150	2F	St	21	84,89	83,52	91	65	46,0	58	18	316	2,08
22 H 150	2F	St	22	88,94	87,56	93	68	46,0	58	18	317	2,30
23 H 150	2F	St	23	92,98	91,61	97	72	46,0	58	18	318	2,54
24 H 150	2F	St	24	97,03	95,65	103	72	46,0	58	18	320	2,75
25 H 150	2F	St	25	101,06	99,69	106	72	46,0	58	18	321	2,97
26 H 150	2F	St	26	105,11	103,73	111	80	46,0	58	18	322	3,29
27 H 150	2F	St	27	109,15	107,78	115	80	46,0	58	18	323	3,52
28 H 150	2F	St	28	113,19	111,82	119	80	46,0	58	18	325	3,78
29 H 150	2F	St	29	117,23	115,86	123	80	46,0	58	18	326	4,03
30 H 150	2F	St	30	121,29	119,90	127	80	46,0	58	18	327	4,29
32 H 150	2F	St	32	129,36	127,99	135	80	46,0	58	18	328	4,86
33 H 150	2F	St	33	133,40	132,03	140	80	46,0	58	18	330	5,15
34 H 150	2F	St	34	137,45	136,07	143	80	46,0	58	18	331	5,46
35 H 150	2F	St	35	141,49	140,12	148	80	46,0	58	18	333	5,78
36 H 150	2F	St	36	145,53	144,16	152	80	46,0	58	18	334	6,09
38 H 150	2F	St	38	153,62	152,24	158	80	46,0	58	18	335	6,74
40 H 150	2F	St	40	161,70	160,33	168	80	46,0	58	18	338	7,46
44 H 150	4F	GG	44	177,87	176,50	184	80	46,0	58	18	339	4,29
45 H 150	4F	GG	45	181,91	180,54	192	80	46,0	58	18	340	4,44
48 H 150	4F	GG	48	194,04	192,67	200	90	46,0	65	18	342	5,41
50 H 150	4	GG	50	202,13	200,75		90	46,0	65	18		5,59
52 H 150	4	GG	52	210,21	208,84		90	46,0	65	18		5,79
58 H 150	4	GG	58	234,47	233,09		90	46,0	65	18		6,15
60 H 150	4	GG	60	242,55	241,18		100	46,0	65	18		7,08
70 H 150	4	GG	70	282,98	281,61		100	46,0	65	24		7,77
72 H 150	4	GG	72	291,06	289,69		120	46,0	65	24		9,70
84 H 150	4	GG	84	339,57	338,20		120	46,0	65	24		10,99
96 H 150	4	GG	96	388,08	386,71		120	46,0	65	24		12,24
120 H 150	4	GG	120	485,10	483,73		120	46,0	65	24		16,17

PULEGGE DENTATE PER CINGHIE POSITIVE SYNCHROBELT® - ISO 5294

TIMING BELTS PULLEYS - ISO 5294

H 200

PASSO 1/2" (12,7 mm)

PER CINGHIE LARGHEZZA 2" (50,8 mm)

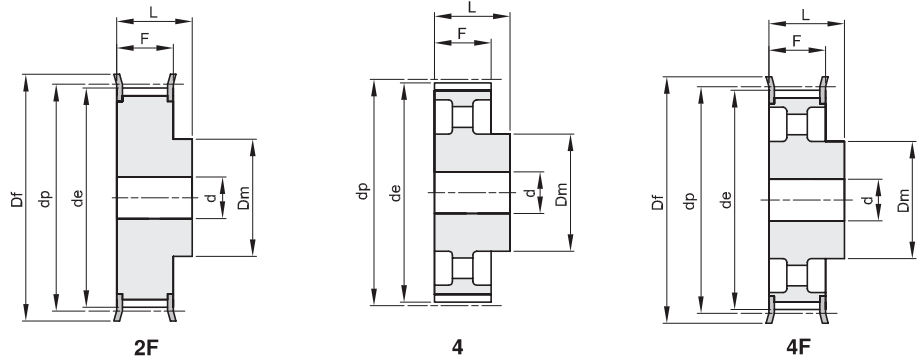

Materiale: Acciaio (St)
Materiale: Ghisa (GG)

codice	tipo	materiale	denti	dp	de	Df	Dm	F	L	d	n° flangia	Kg.
14 H 200	2F	St	14	56,59	55,22	63	40	58,7	70	18	309	1,10
15 H 200	2F	St	15	60,64	59,27	66	45	58,7	70	18	310	1,33
16 H 200	2F	St	16	64,68	63,31	71	45	58,7	70	18	311	1,54
17 H 200	2F	St	17	68,72	67,35	75	45	58,7	70	18	312	1,69
18 H 200	2F	St	18	72,77	71,39	79	55	58,7	70	18	313	1,95
19 H 200	2F	St	19	76,81	75,44	83	60	58,7	70	18	314	2,20
20 H 200	2F	St	20	80,85	79,48	87	62	58,7	70	18	315	2,44
21 H 200	2F	St	21	84,89	83,52	91	65	58,7	70	18	316	2,70
22 H 200	2F	St	22	88,94	87,56	93	68	58,7	70	18	317	2,97
23 H 200	2F	St	23	92,98	91,61	97	72	58,7	70	18	318	3,25
24 H 200	2F	St	24	97,03	95,65	103	72	58,7	70	18	320	3,56
25 H 200	2F	St	25	101,06	99,69	106	72	58,7	70	18	321	3,81
26 H 200	2F	St	26	105,11	103,73	111	80	58,7	70	18	322	4,18
27 H 200	2F	St	27	109,15	107,78	115	80	58,7	70	18	323	4,49
28 H 200	2F	St	28	113,19	111,82	119	80	58,7	70	18	325	4,81
29 H 200	2F	St	29	117,23	115,86	123	80	58,7	70	18	326	5,14
30 H 200	2F	St	30	121,29	119,90	127	80	58,7	70	18	327	5,47
32 H 200	2F	St	32	129,36	127,99	135	80	58,7	70	18	328	6,17
33 H 200	2F	St	33	133,40	132,03	140	80	58,7	70	18	330	6,56
34 H 200	2F	St	34	137,45	136,07	143	80	58,7	70	18	331	6,94
35 H 200	2F	St	35	141,49	140,12	148	80	58,7	70	18	333	7,34
36 H 200	2F	St	36	145,53	144,16	152	80	58,7	70	18	334	7,75
38 H 200	2F	St	38	153,62	152,24	158	80	58,7	70	18	335	8,62
40 H 200	2F	St	40	161,70	160,33	168	80	58,7	70	18	338	9,50
44 H 200	4F	GG	44	177,87	176,50	184	80	58,7	70	18	339	5,14
45 H 200	4F	GG	45	181,91	180,54	192	80	58,7	70	18	340	5,38
48 H 200	4F	GG	48	194,04	192,67	200	90	58,7	75	24	342	6,29
50 H 200	4	GG	50	202,13	200,75		90	58,7	75	24		6,68
52 H 200	4	GG	52	210,21	208,84		90	58,7	75	24		6,81
58 H 200	4	GG	58	234,47	233,09		90	58,7	75	24		7,26
60 H 200	4	GG	60	242,55	241,18		100	58,7	75	24		8,25
70 H 200	4	GG	70	282,98	281,61		100	58,7	75	28		9,20
72 H 200	4	GG	72	291,06	289,69		120	58,7	75	28		11,09
84 H 200	4	GG	84	339,57	338,20		120	58,7	75	28		12,63
96 H 200	4	GG	96	388,08	386,71		120	58,7	75	28		14,51
120 H 200	4	GG	120	485,10	483,73		120	58,7	75	28		19,15

PULEGGE DENTATE PER CINGHIE POSITIVE SYNCHROBELT® - ISO 5294

TIMING BELTS PULLEYS - ISO 5294

H 300

PASSO 1/2" (12,7 mm)
PER CINGHIE LARGHEZZA 3" (76,2 mm)

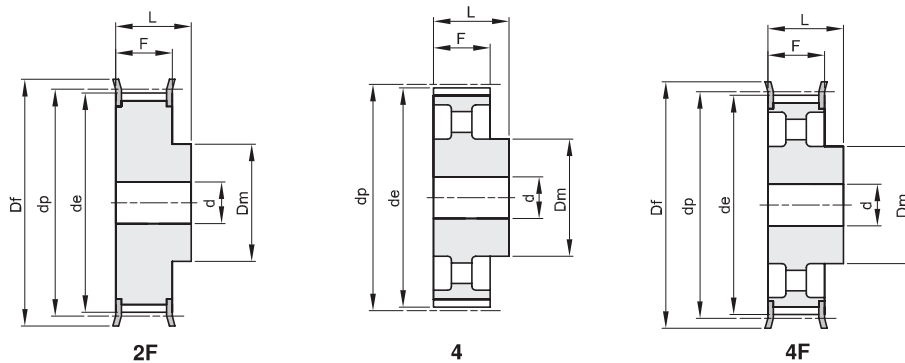

Materiale: Acciaio (St)
Materiale: Ghisa (GG)

codice	tipo	materiale	denti	dp	de	Df	Dm	F	L	d	n° flangia	Kg.
14 H 300	2F	St	14	56,59	55,22	63	40	85,7	100	18	309	1,64
15 H 300	2F	St	15	60,64	59,27	66	45	85,7	100	18	310	1,91
16 H 300	2F	St	16	64,68	63,31	71	45	85,7	100	18	311	2,16
17 H 300	2F	St	17	68,72	67,35	75	45	85,7	100	18	312	2,43
18 H 300	2F	St	18	72,77	71,39	79	55	85,7	100	18	313	2,80
19 H 300	2F	St	19	76,81	75,44	83	60	85,7	100	18	314	3,16
20 H 300	2F	St	20	80,85	79,48	87	62	85,7	100	18	315	3,50
21 H 300	2F	St	21	84,89	83,52	91	65	85,7	100	18	316	3,87
22 H 300	2F	St	22	88,94	87,56	93	68	85,7	100	18	317	4,26
23 H 300	2F	St	23	92,98	91,61	97	72	85,7	100	18	318	4,68
24 H 300	2F	St	24	97,03	95,65	103	72	85,7	100	18	320	5,08
25 H 300	2F	St	25	101,06	99,69	106	72	85,7	100	18	321	5,45
26 H 300	2F	St	26	105,11	103,73	111	80	85,7	100	18	322	6,01
27 H 300	2F	St	27	109,15	107,78	115	80	85,7	100	18	323	6,45
28 H 300	2F	St	28	113,19	111,82	119	80	85,7	100	18	325	6,91
30 H 300	2F	St	30	121,29	119,90	127	80	85,7	100	18	327	7,90
32 H 300	2F	St	32	129,36	127,99	135	80	85,7	100	18	328	8,92
33 H 300	2F	St	33	133,40	132,03	140	80	85,7	100	18	330	9,46
34 H 300	2F	St	34	137,45	136,07	143	80	85,7	100	18	331	10,04
35 H 300	2F	St	35	141,49	140,12	148	80	85,7	100	18	333	10,62
36 H 300	2F	St	36	145,53	144,16	152	80	85,7	100	18	334	11,24
38 H 300	2F	St	38	153,62	152,24	158	80	85,7	100	18	335	12,44
40 H 300	2F	St	40	161,70	160,33	168	80	85,7	100	18	338	13,80
44 H 300	4F	GG	44	177,87	176,50	184	80	85,7	100	24	339	7,22
48 H 300	4F	GG	48	194,04	192,67	200	90	85,7	100	24	342	8,60
50 H 300	4	GG	50	202,13	200,75		90	85,7	100	24		8,99
58 H 300	4	GG	58	234,47	233,09		90	85,7	100	24		10,04
60 H 300	4	GG	60	242,55	241,18		100	85,7	100	24		11,18
72 H 300	4	GG	72	291,06	289,69		120	85,7	100	28		15,07
84 H 300	4	GG	84	339,57	338,20		120	85,7	100	28		16,97
96 H 300	4	GG	96	388,08	386,71		120	85,7	100	28		19,86
120 H 300	4	GG	120	485,10	483,73		120	85,7	100	28		25,91

PULEGGE DENTATE PER CINGHIE POSITIVE SYNCHROBELT® - ISO 5294

TIMING BELTS PULLEYS - ISO 5294

XH 200

PASSO 7/8" (22,22 mm)
PER CINGHIE LARGHEZZA 2" (50,8 mm)

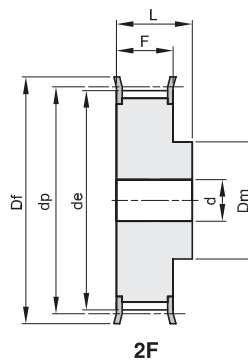

Materiale: Acciaio (St)

codice	tipo	materiale	denti	dp	de	Df	Dm	F	L	d	n° flangia	Kg.
18 XH 200	2F	St	18	127,34	124,55	138	100	65	80	24	401	6,00
19 XH 200	2F	St	19	134,41	131,62	146	100	65	80	24	402	6,60
20 XH 200	2F	St	20	141,49	138,69	154	100	65	80	24	403	7,30
21 XH 200	2F	St	21	148,56	145,77	160	110	65	80	24	404	8,73
22 XH 200	2F	St	22	155,64	152,84	168	110	65	80	24	405	9,55
24 XH 200	2F	St	24	169,79	166,99	183	120	65	80	24	406	11,47
25 XH 200	2F	St	25	176,86	174,07	188	120	65	80	24	407	12,46
26 XH 200	2F	St	26	183,93	181,14	198	120	65	80	24	409	13,47
27 XH 200	2F	St	27	191,01	188,22	200	120	65	80	24	410	14,42
28 XH 200	2F	St	28	198,09	195,29	211	120	65	80	24	411	15,44
30 XH 200	2F	St	30	212,23	209,44	226	120	65	80	24	412	17,69
32 XH 200	2F	St	32	226,38	223,59	240	120	65	80	24	414	19,95
34 XH 200	2F	St	34	240,53	237,74	256	120	65	80	24	415	22,75

PULEGGE DENTATE PER CINGHIE POSITIVE SYNCHROBELT® - ISO 5294

MONDIALTECNICA TIMING BELTS PULLEYS - ISO 5294

XH 300

PASSO 7/8" (22,22 mm)
PER CINGHIE LARGHEZZA 3" (76,2 mm)

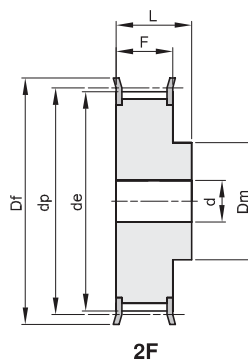

Materiale: Acciaio (St)

codice	tipo	materiale	denti	dp	de	Df	Dm	F	L	d	n° flangia	Kg.
18 XH 300	2F	St	18	127,34	124,55	138	100	92	110	28	401	8,90
19 XH 300	2F	St	19	134,41	131,62	146	100	92	110	28	402	9,20
20 XH 300	2F	St	20	141,49	138,69	154	100	92	110	28	403	10,61
21 XH 300	2F	St	21	148,56	145,77	160	110	92	110	28	404	11,87
22 XH 300	2F	St	22	155,64	152,84	168	110	92	110	28	405	13,08
24 XH 300	2F	St	24	169,79	166,99	183	120	92	110	28	406	15,77
25 XH 300	2F	St	25	176,86	174,07	188	120	92	110	28	407	17,13
26 XH 300	2F	St	26	183,93	181,14	198	120	92	110	28	409	18,55
27 XH 300	2F	St	27	191,01	188,22	200	120	92	110	28	410	19,90
28 XH 300	2F	St	28	198,09	195,29	211	150	92	110	28	411	22,27
30 XH 300	2F	St	30	212,23	209,44	226	150	92	110	28	412	25,39
32 XH 300	2F	St	32	226,38	223,59	240	150	92	110	28	414	28,73
34 XH 300	2F	St	34	240,53	237,74	256	150	92	110	28	415	34,20

PULEGGE DENTATE PER CINGHIE POSITIVE SYNCHROBELT® - ISO 5294
TIMING BELTS PULLEYS - ISO 5294

XH 400

PASSO 7/8" (22,22 mm)
PER CINGHIE LARGHEZZA 4" (101,6 mm)

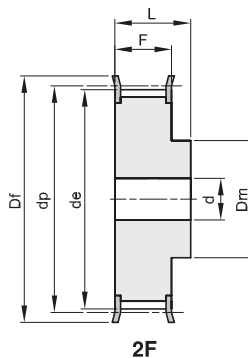

Materiale: Acciaio (St)

codice	tipo	materiale	denti	dp	de	Df	Dm	F	L	d	n° flangia	Kg.
18 XH 400	2F	St	18	127,34	124,55	138	100	119	132	32	401	9,60
19 XH 400	2F	St	19	134,41	131,62	146	100	119	132	32	402	10,80
20 XH 400	2F	St	20	141,49	138,69	154	100	119	132	32	403	12,87
21 XH 400	2F	St	21	148,56	145,77	160	110	119	132	32	404	14,42
22 XH 400	2F	St	22	155,64	152,84	168	110	119	132	32	405	15,44
24 XH 400	2F	St	24	169,79	166,99	183	120	119	132	32	406	19,22
25 XH 400	2F	St	25	176,86	174,07	188	120	119	132	32	407	21,05
26 XH 400	2F	St	26	183,93	181,14	198	120	119	132	32	409	22,80
27 XH 400	2F	St	27	191,01	188,22	200	120	119	132	32	410	24,66
28 XH 400	2F	St	28	198,09	195,29	211	150	119	132	32	411	27,23
30 XH 400	2F	St	30	212,23	209,44	226	150	119	132	32	412	31,30
32 XH 400	2F	St	32	226,38	223,59	240	150	119	132	32	414	35,20
34 XH 400	2F	St	34	240,53	237,74	256	150	119	132	32	415	40,00